

FC  
USGS  
OFR  
77-66D

UNITED STATES DEPARTMENT OF THE INTERIOR  
GEOLOGICAL SURVEY

Telluric Traverse Location Map and Profile for Gerlach  
Northwest Known Geothermal Resource Area, Nevada

~~WASHOE CO.~~  
Pershing

By

Karen R. Christopherson, Donald B. Hoover and David J. Cesario  
U.S. Geological Survey

Open-file Report 77-66E  
1977

This report is preliminary and has not been  
edited or reviewed for conformity with U.S.  
Geological Survey standards and nomenclature.

UNIVERSITY OF UTAH  
RESEARCH INSTITUTE  
EARTH SCIENCE LAB.

UNIVERSITY OF UTAH  
RESEARCH INSTITUTE  
EARTH SCIENCE LAB.

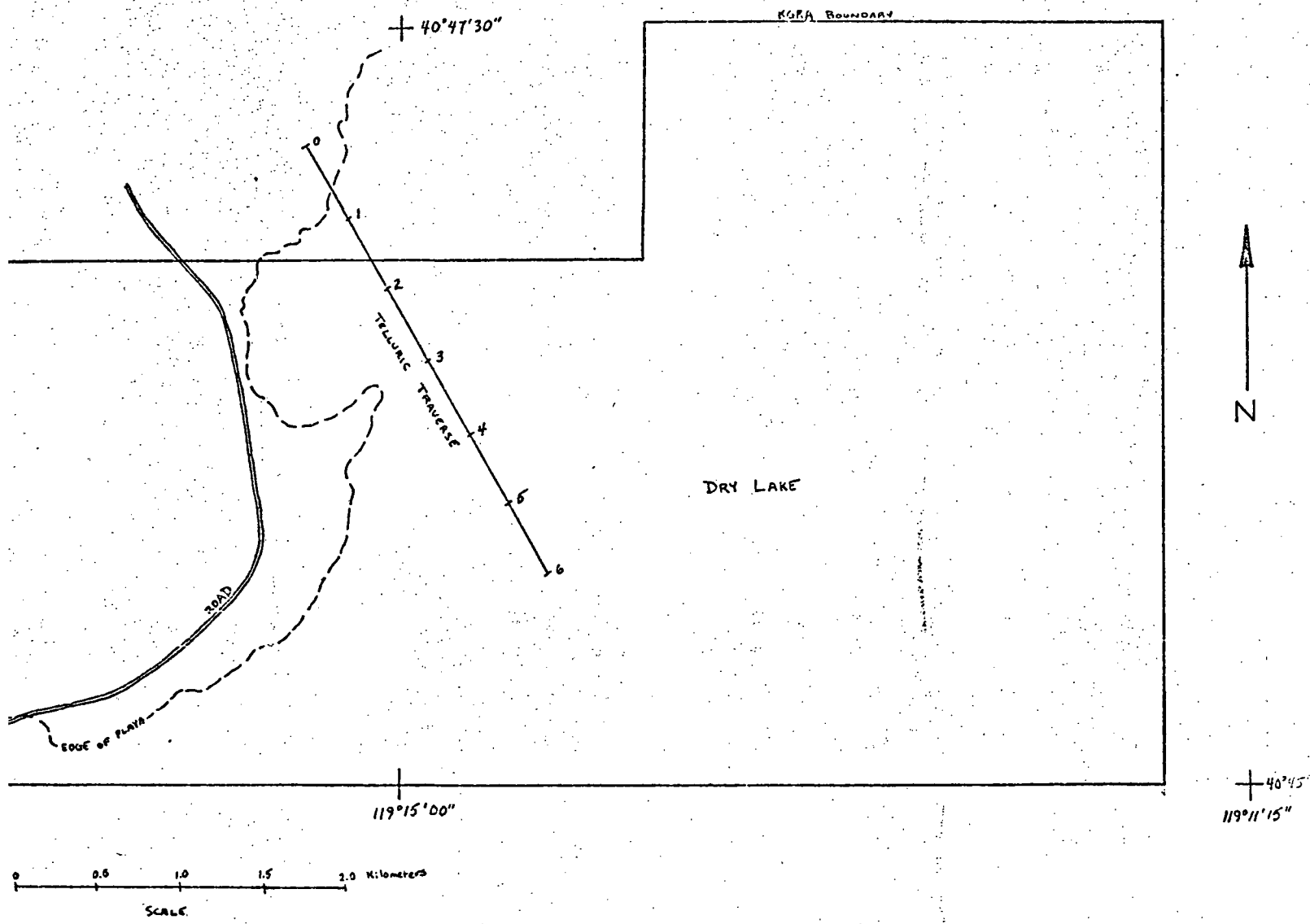

Figure 1. TELLURIC TRAVERSE STATION LOCATION MAP  
 GERLACH NORTHEAST KGRA-NEVADA

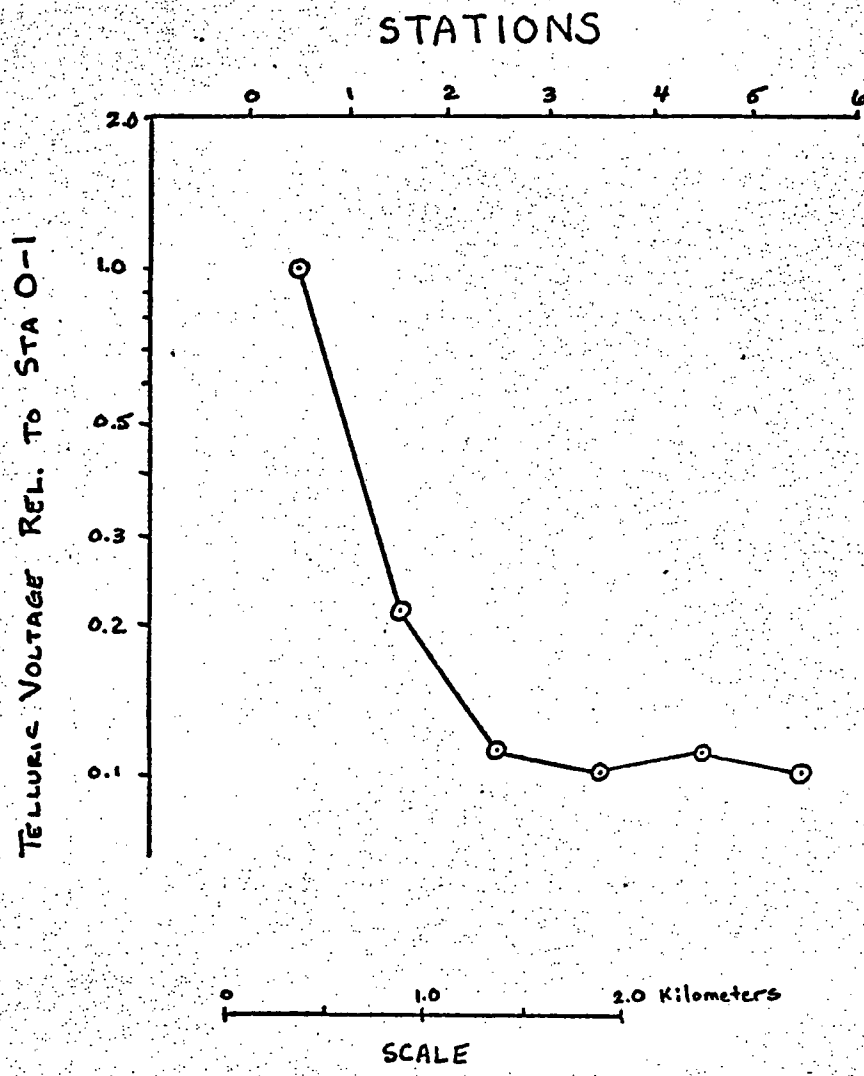

Figure 2. TELLURIC PROFILE  
 GERLACH NORTHEAST KGRA  
 NEVADA