

Logs -
H. Ross

ave
Data +
originals -
Pat
Dumbner

601879

N-3

(*) → # of samples used
to make aver. for
that unit.

ave. suscept. (10^{-6}) cgs

→ uncertain of ave.
due to limiting info.

500

1000

1500

2000

2500

22-141 50 SHEETS
22-142 100 SHEETS
22-144 200 SHEETS



(19)

non-vesic.
Basaltic
Andesite

410

420

430

440

450

460

470

480

490

500

vesic. 500
- 509

510

520

lapilli
Tuff

530

540

Too many missing
intervals to
make accurate average

550

(8)

inders
ash
+
Scoria

560

570

580

590

600



22-141 50 SHEETS
 22-142 100 SHEETS
 22-144 200 SHEETS

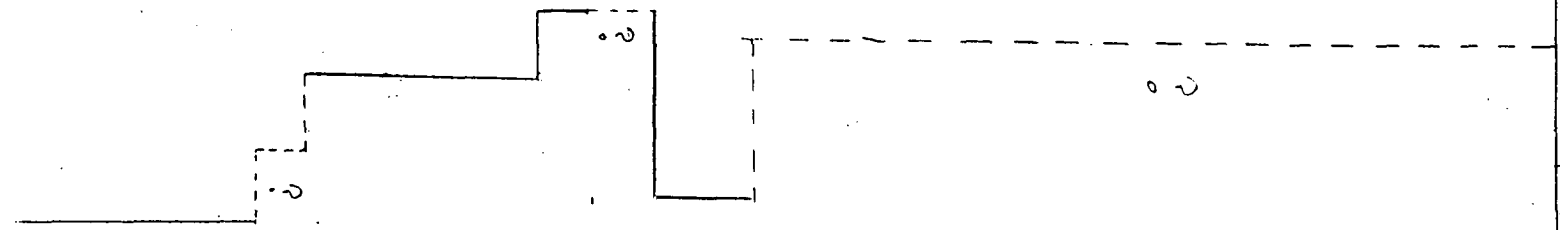
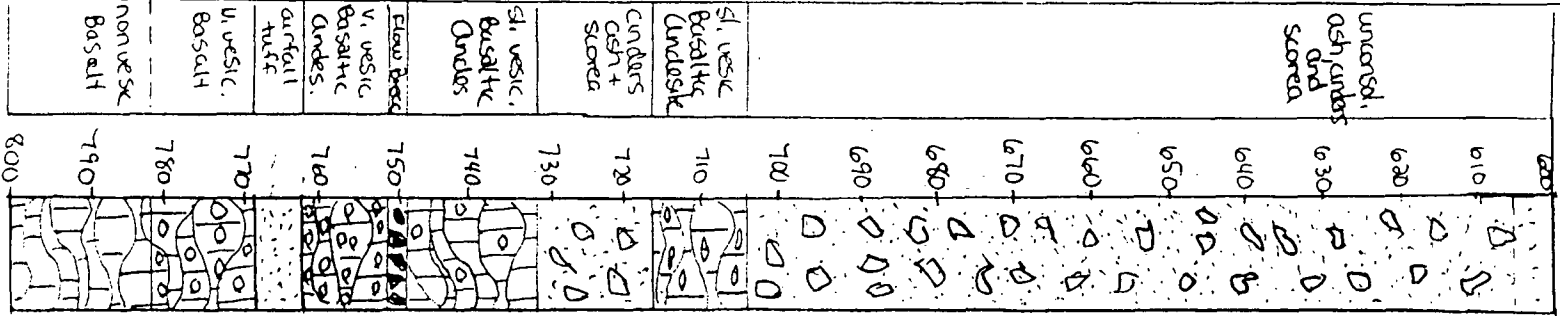

500 1000 1500 2000

(.10"=')

11

0

2

3

5



22-141 50 SHEETS
 22-142 100 SHEETS
 22-144 200 SHEETS

① gravel
 cinders
 Basaltic
 Andes.
 + ash



⑤

non-
vesic.
Andes.

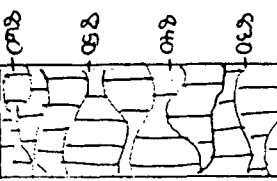

tuft
ash-
und.



⑭

agglom.

agglom

agglom

non-
vesic.
Basalt
Andes.

Breccia
+ ash

interbed.
agglom.
+
tuft

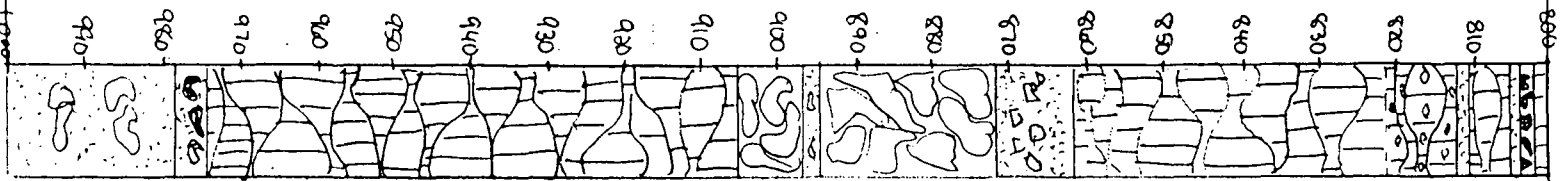

10" = 985

900 1000 1500 2000

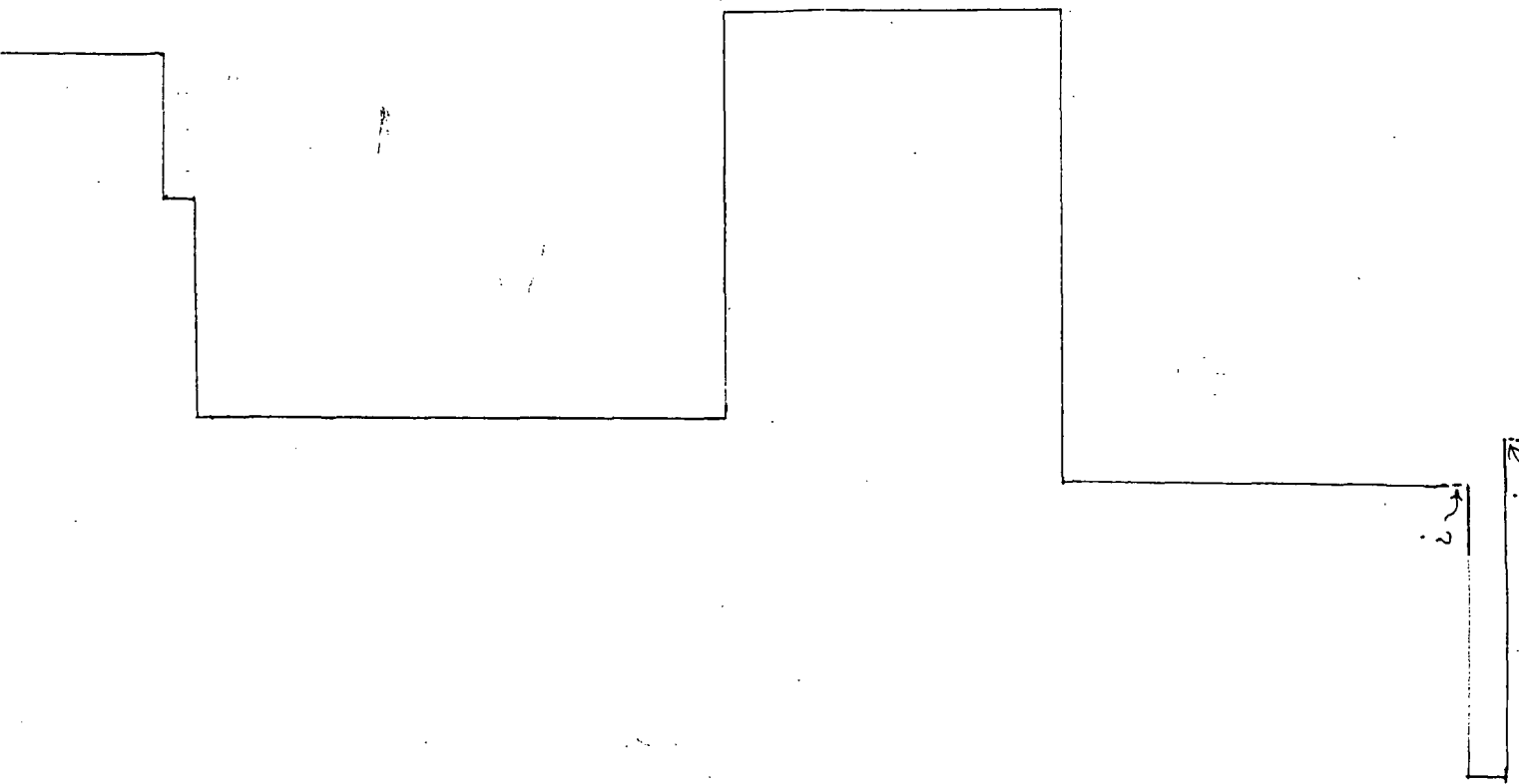



22-141 50 SHEETS
 22-142 100 SHEETS
 22-144 200 SHEETS

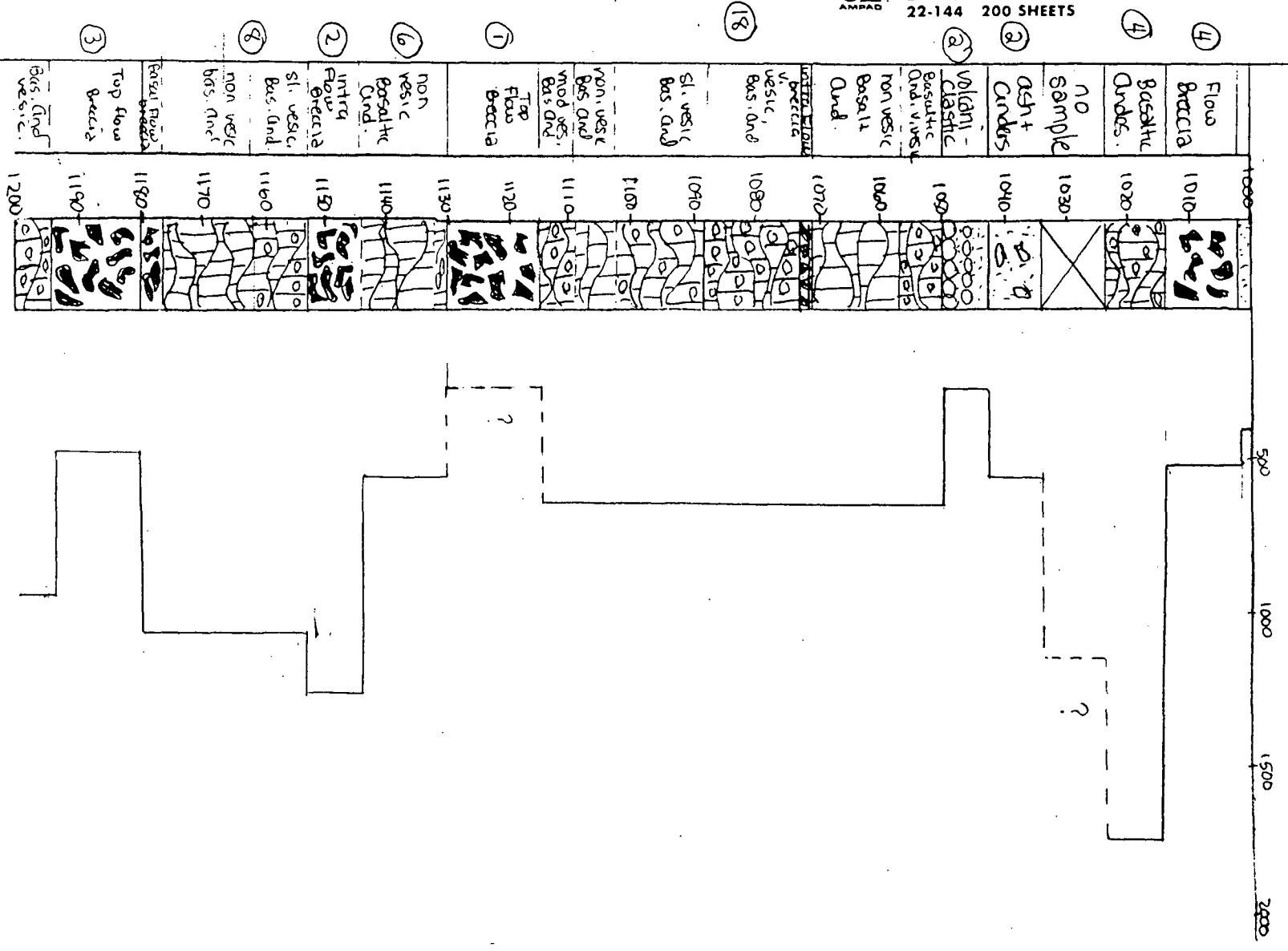

11

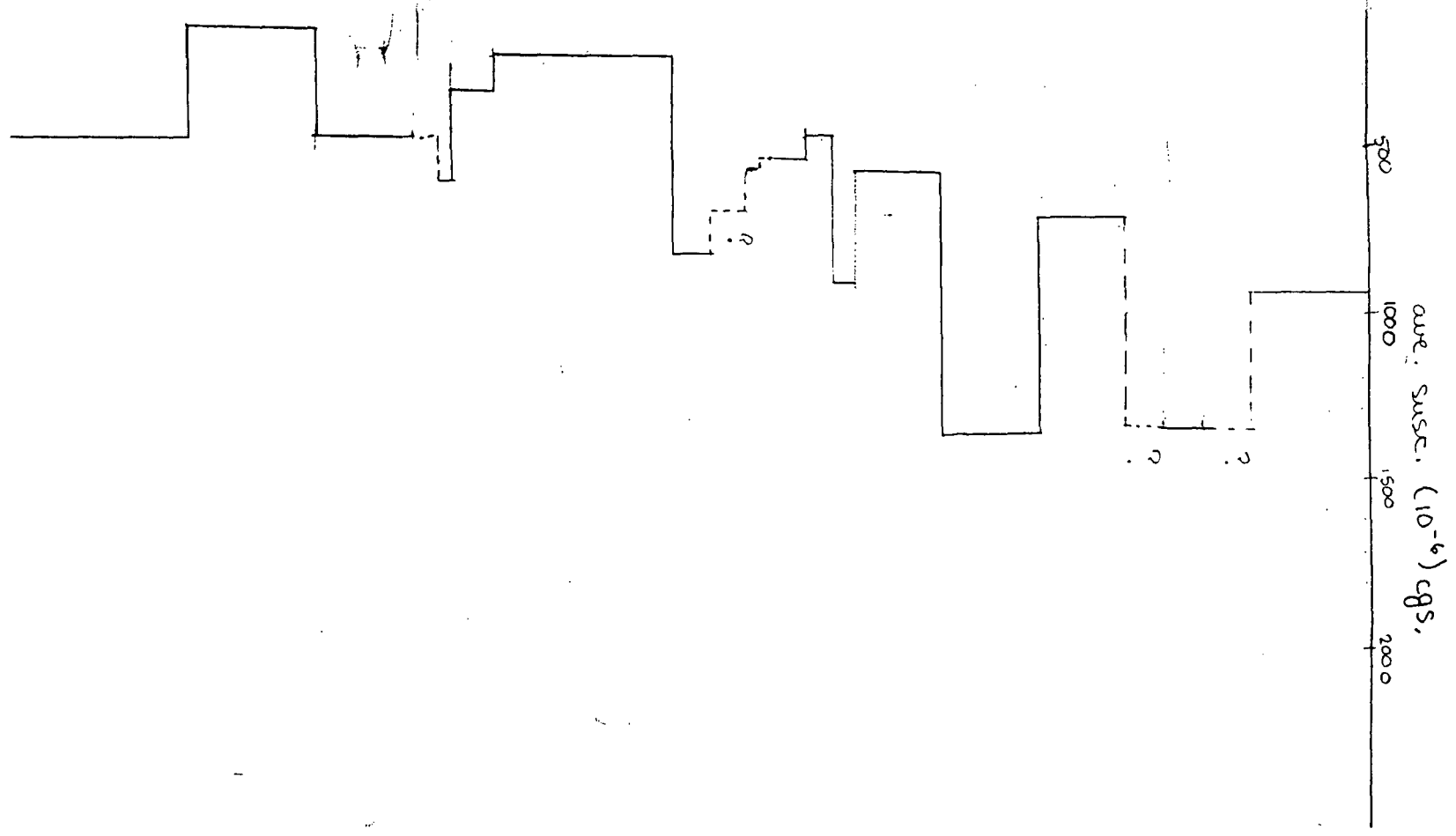
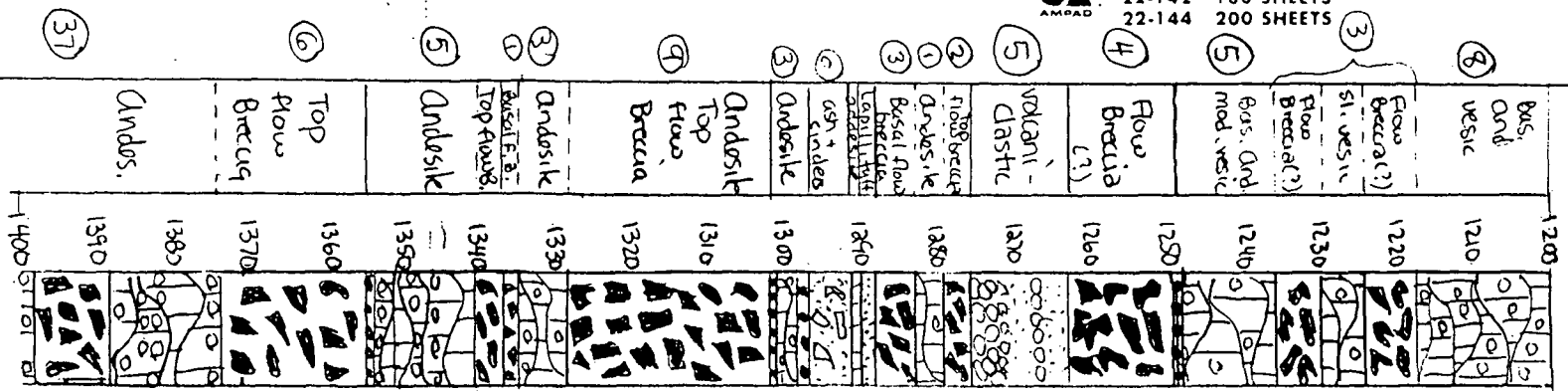



22-141 50 SHEETS
 22-142 100 SHEETS
 22-144 200 SHEETS

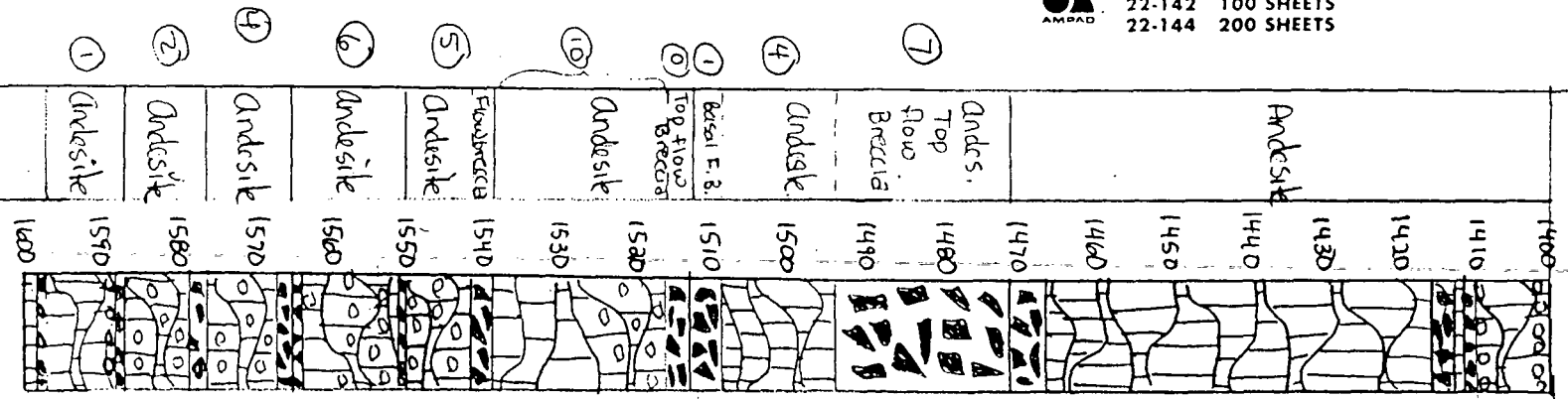

- ①
- ②
- ③
- ④
- ⑤
- ⑥
- ⑦
- ⑧
- ⑨
- ⑩

ave. magnetic susceptib. (10^{-6})

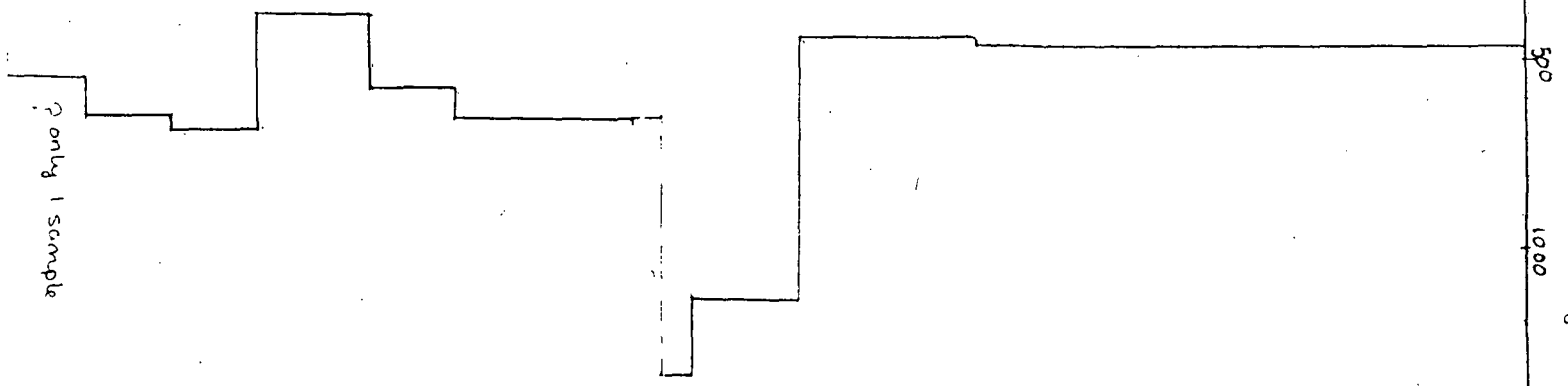



ave. susceptib. (10⁻⁶) cgs

500 1000 1500 2000

? only 1 sample

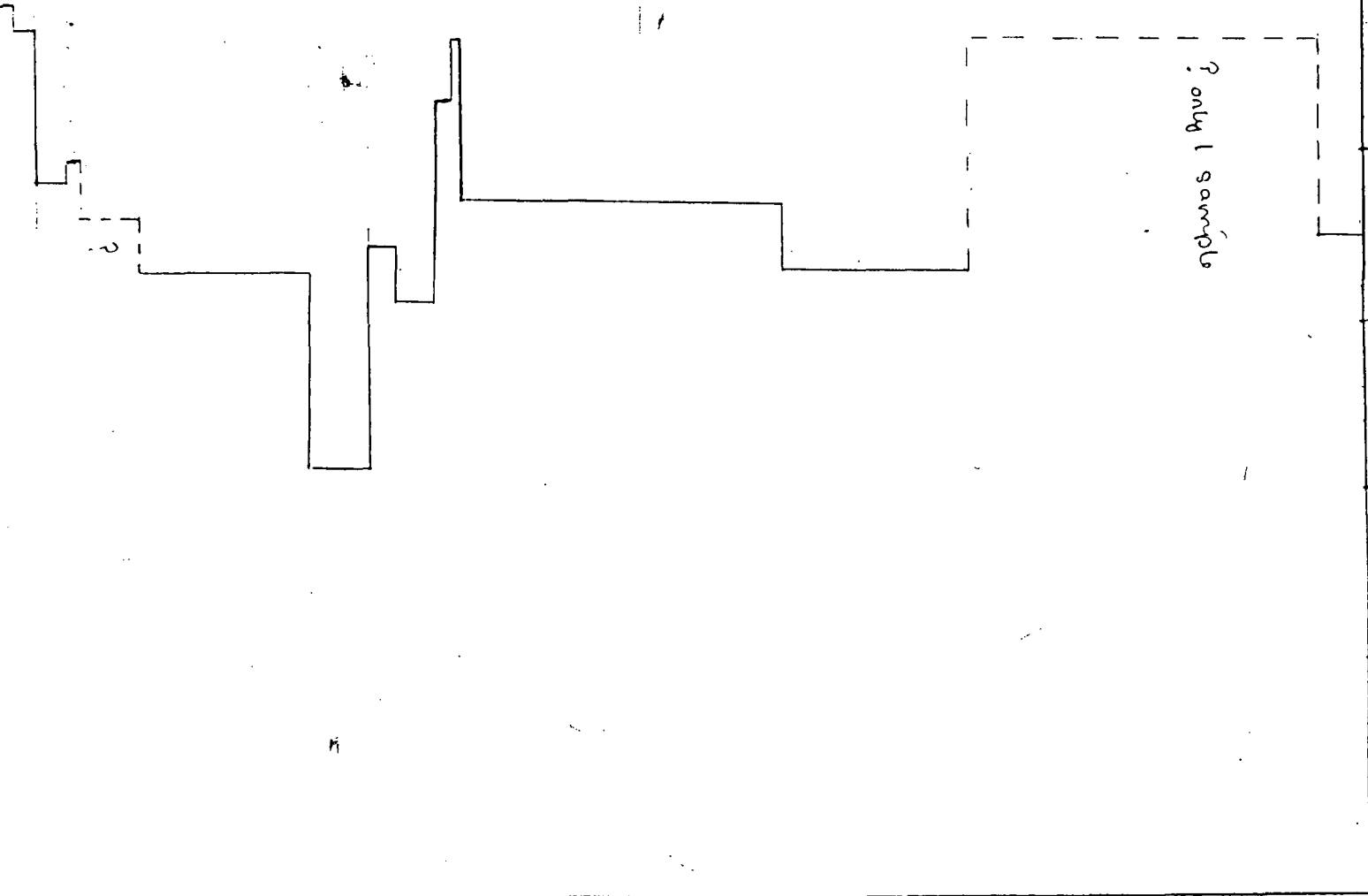
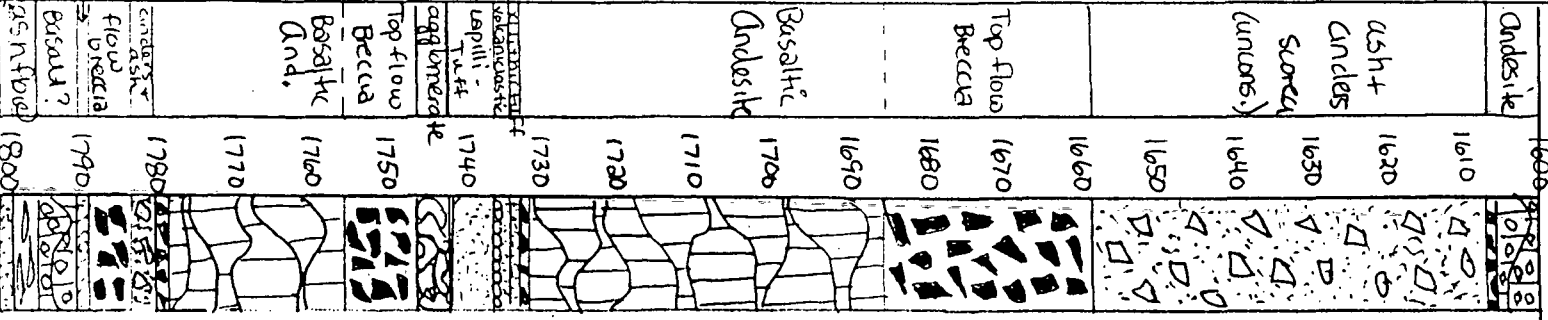

(4)

(1)

(5)

(19)

(3)

(2)

(3)

(3)

(2)

Mustal
 1
 2
 3
 4
 5
 6
 7
 8
 9
 10
 11
 12
 13
 14
 15
 16
 17
 18
 19
 20
 21
 22
 23
 24
 25
 26
 27
 28
 29
 30
 31
 32
 33
 34
 35
 36
 37
 38
 39
 40
 41
 42
 43
 44
 45
 46
 47
 48
 49
 50

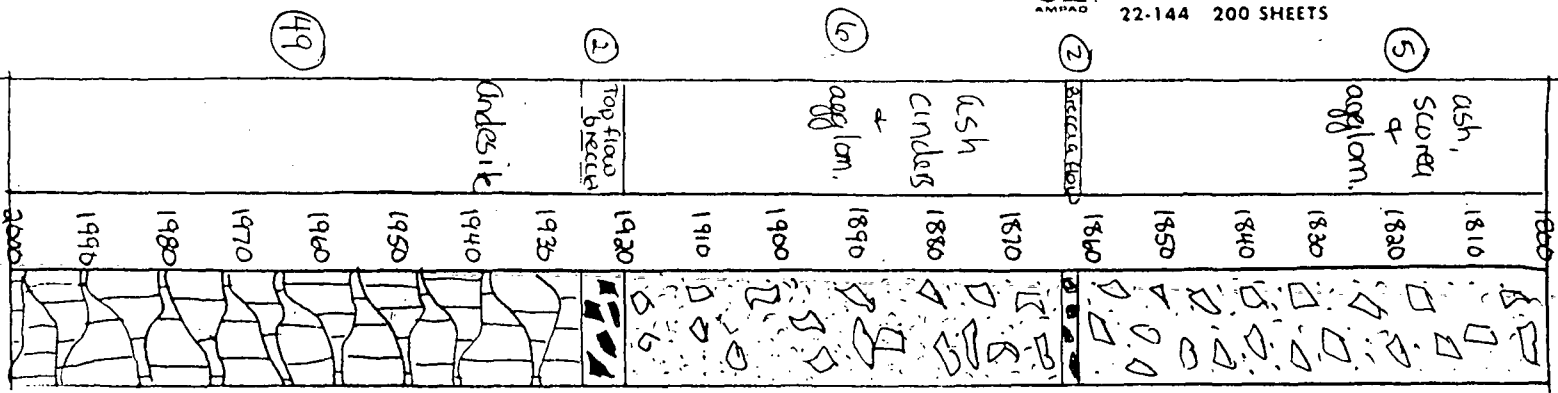

ave susc. (10⁻⁶) cgs

(not many samples available for average)

500 1000 1500



22-141 50 SHEETS
22-142 100 SHEETS
22-144 200 SHEETS

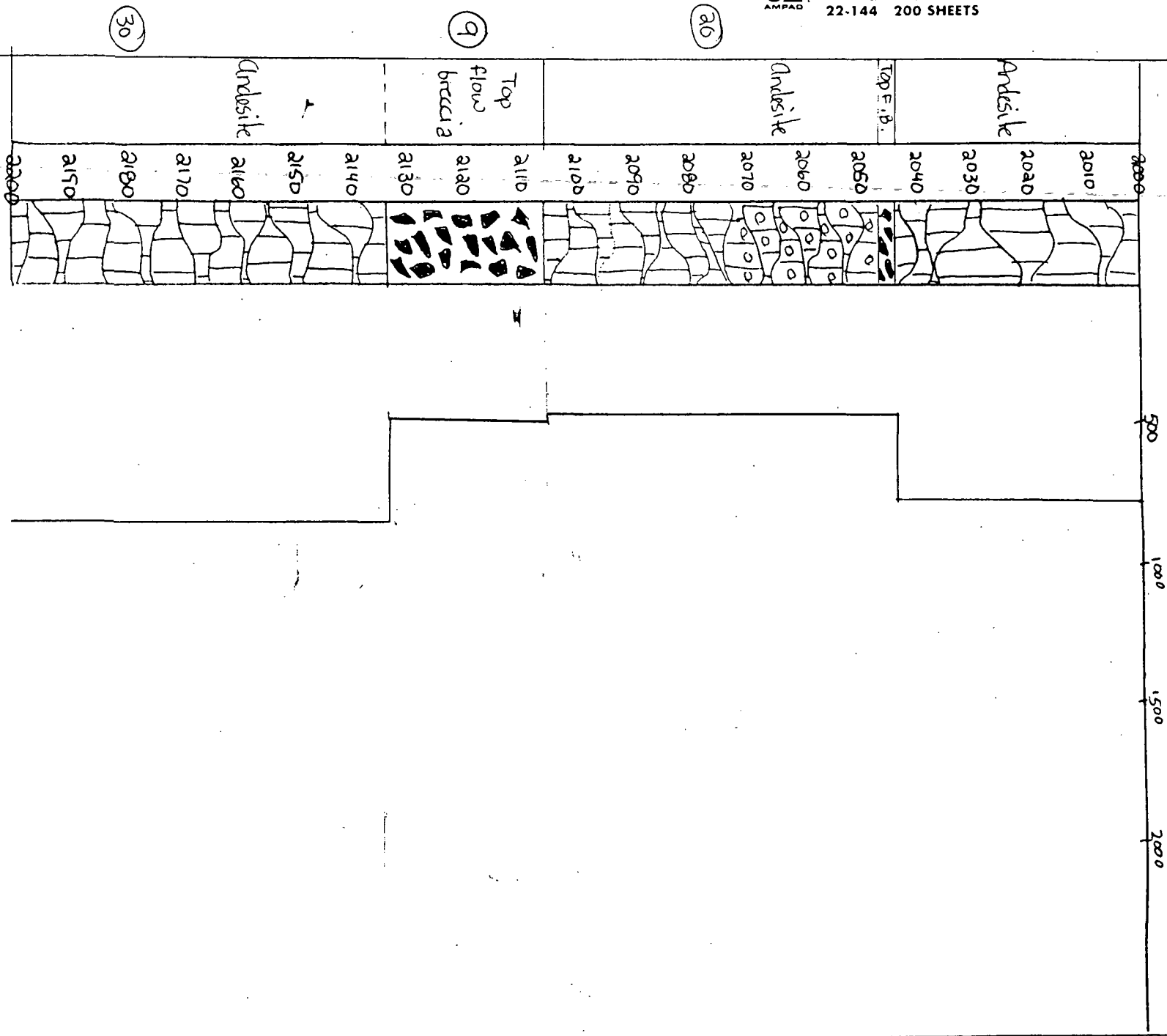

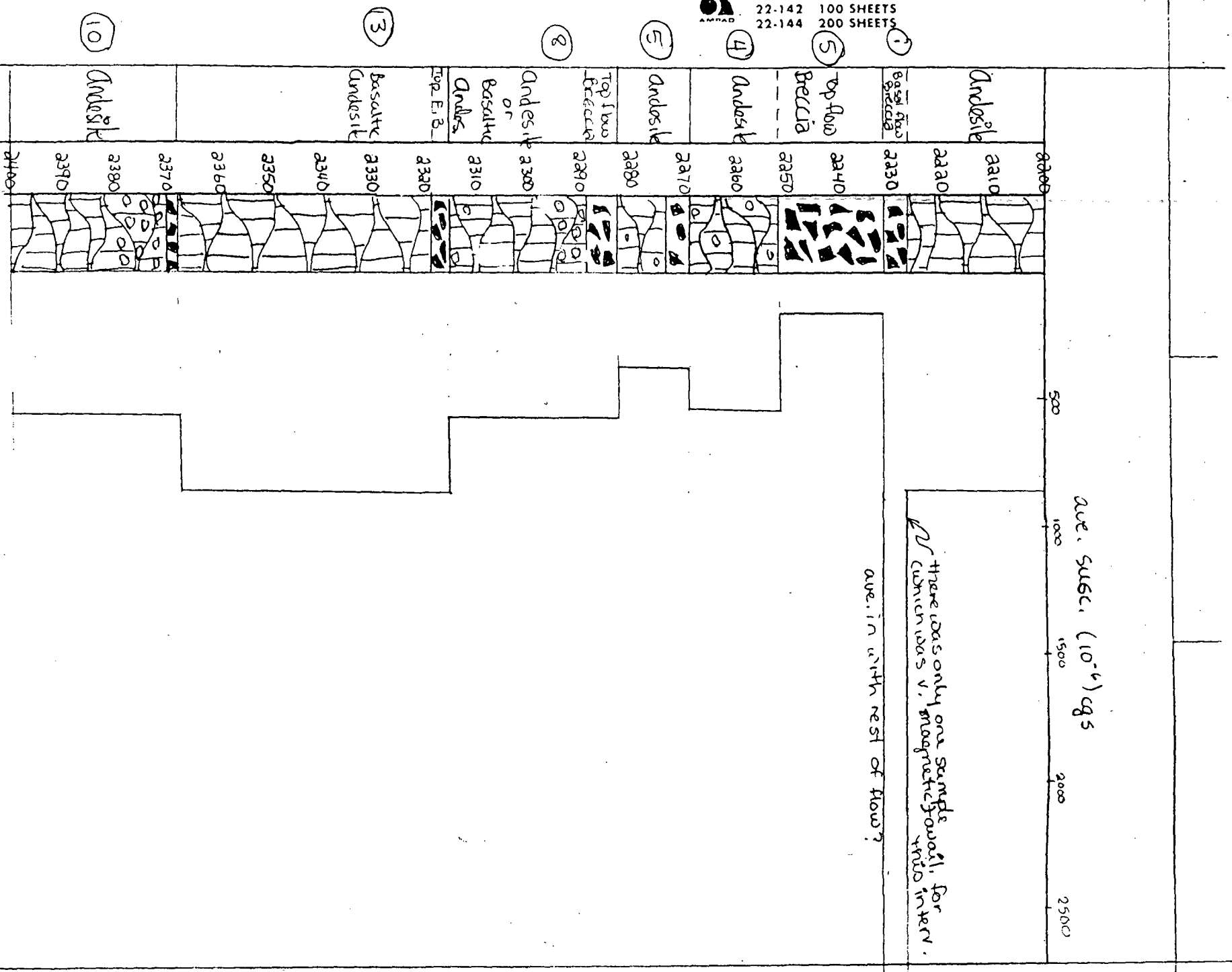

ave. succ. (10⁻⁴) cgs

ave. in with rest of flow?
 these rocks only one sample taken for lithic v. magnetic fossils. This in part.

500 1000 1500 2000 2500

10

13

8

5

4

5

1

Andesite

Andesite

Basalt flow Breccia

Top flow Breccia

Andesite

Andesite

Top flow Breccia

Andesite or Basaltic Andes.

Top F. B.

Basaltic Andesite

Basaltic Andesite

Andesite

Andesite

Andesite



2230 2240 2270 2280 2290 2310 2330 2340 2350 2360 2370 2390 2400

ave susc. (10^{-6}) cgs

500 1000 1500 2000

22-141 50 SHEETS
22-142 100 SHEETS
22-144 200 SHEETS



(4)	Andesitic Flow Breccia	2400	
		2410	
(1)	Volcanic-clastic	2420	
		2430	
(7)	Andesite	2440	
		2450	
(2)	ash flow	2460	
		2470	
(3)	Top flow Breccia	2480	
		2490	
(7)	Andesite or Basaltic Andesite	2500	
	Basaltic andesite lapilli tuff scoria	2510	
		2520	
(7)	Lithic Lapilli Tuff	2530	
		2540	
(5)	Basaltic Andes.	2550	
		2560	
(3)	Basaltic Andesite	2570	
		2580	
(2)	Top flow Breccia	2590	
		2600	
(6)	Basaltic Andesite		

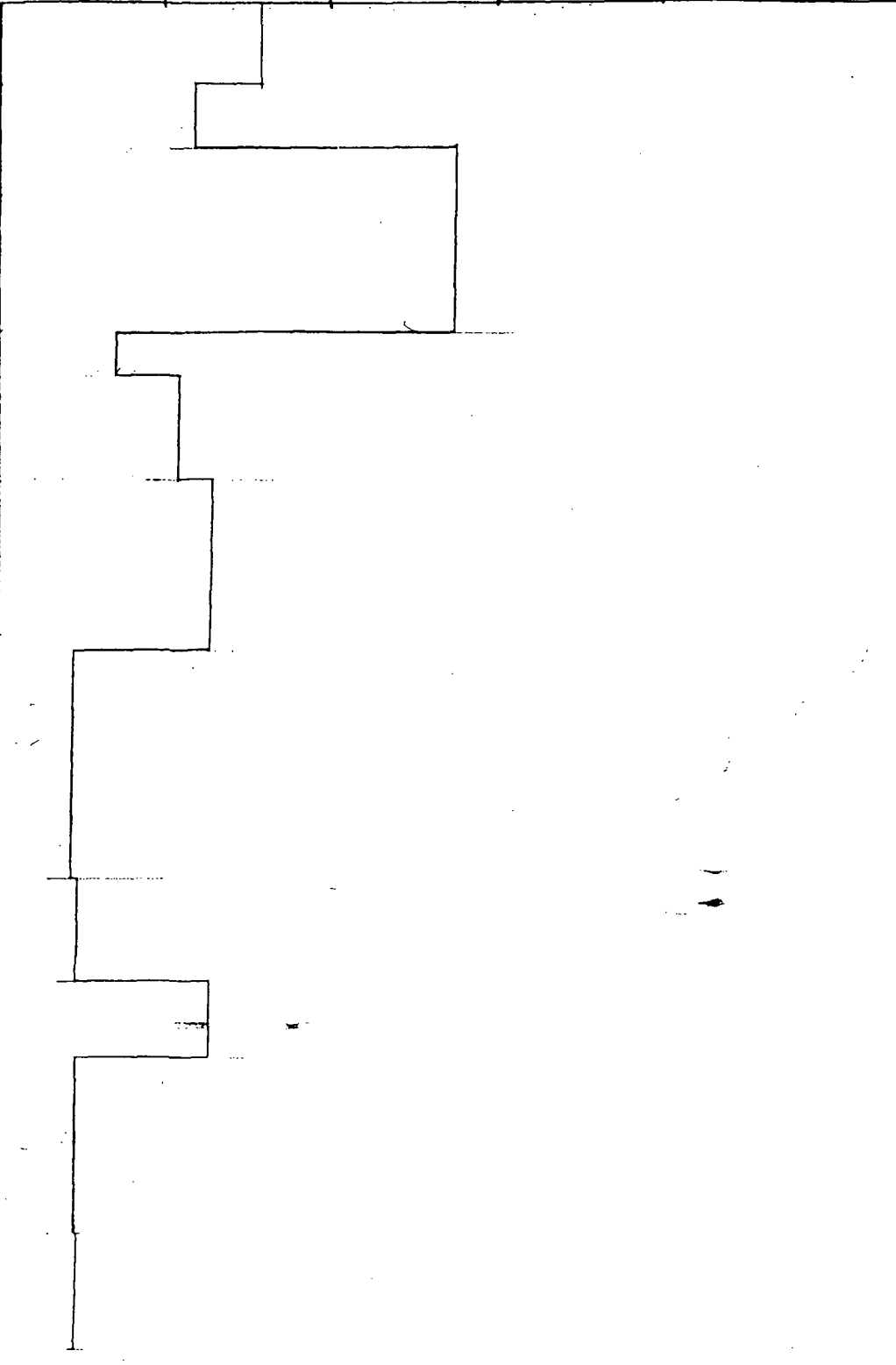



22-141 50 SHEETS
 22-142 100 SHEETS
 22-144 200 SHEETS

①	Capilli with diplomatites	2660	
	Flow Breccia?	2660	
⑤	Basaltic Andesite?	2630	
	Flow breccia	2630	
⑥	Basaltic Andes.	2650	
	Top flow breccia	2670	
⑩	Basaltic Andes. infra- flow breccia	2690	
	Andes. Breccia	2700	
⑬	Basaltic Andesite	2730	
	Basaltic Andesite	2730	
⑭	Basaltic Flow breccia	2740	
	Top flow breccia	2750	
⑯	Basaltic	2760	
	Andesite	2770	
	infra-flow breccia	2780	
	infra-flow	2790	
	infra-flow	2800	

ave. susc. (10⁻⁶) cgs

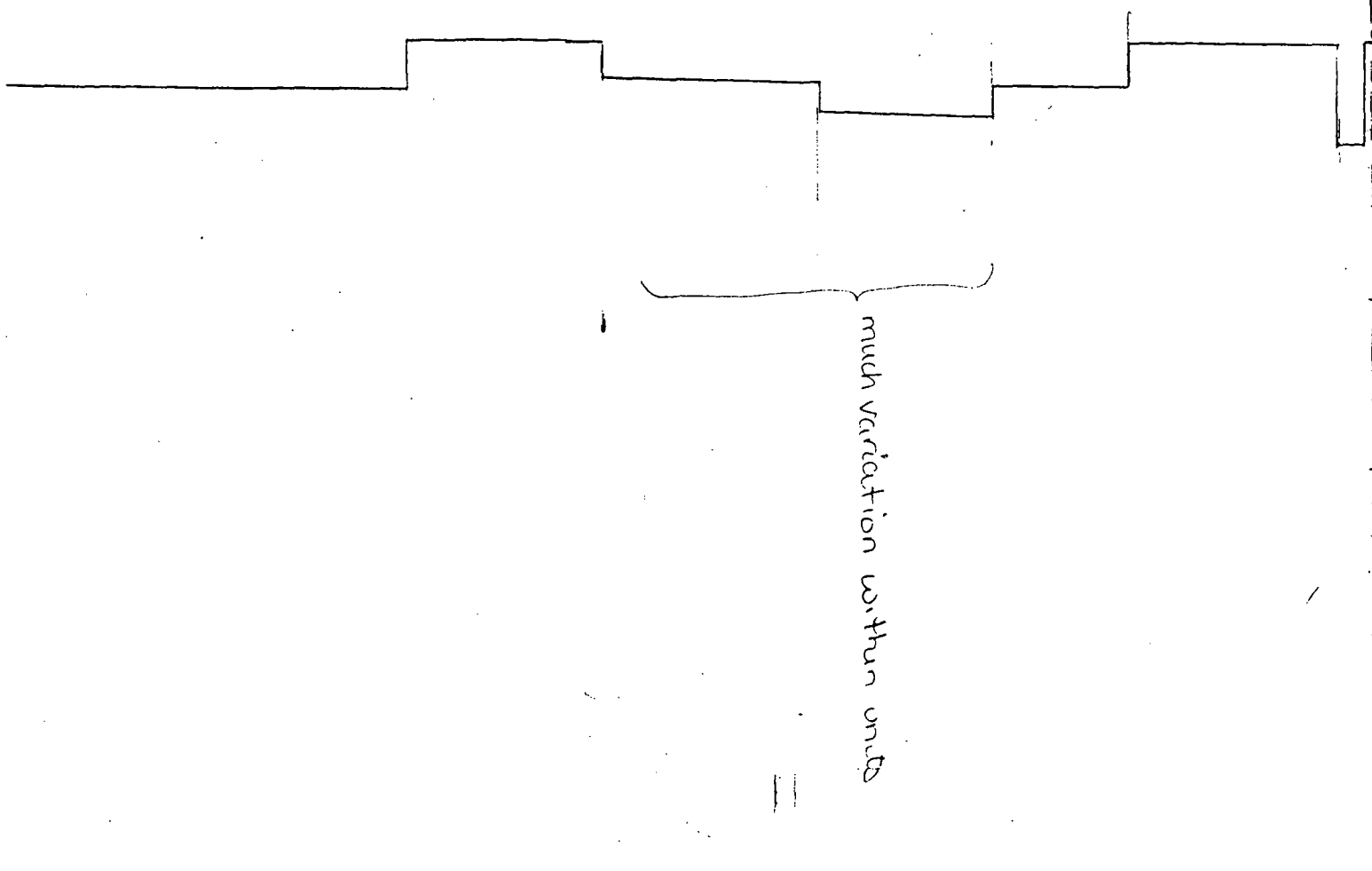

} much variation within units

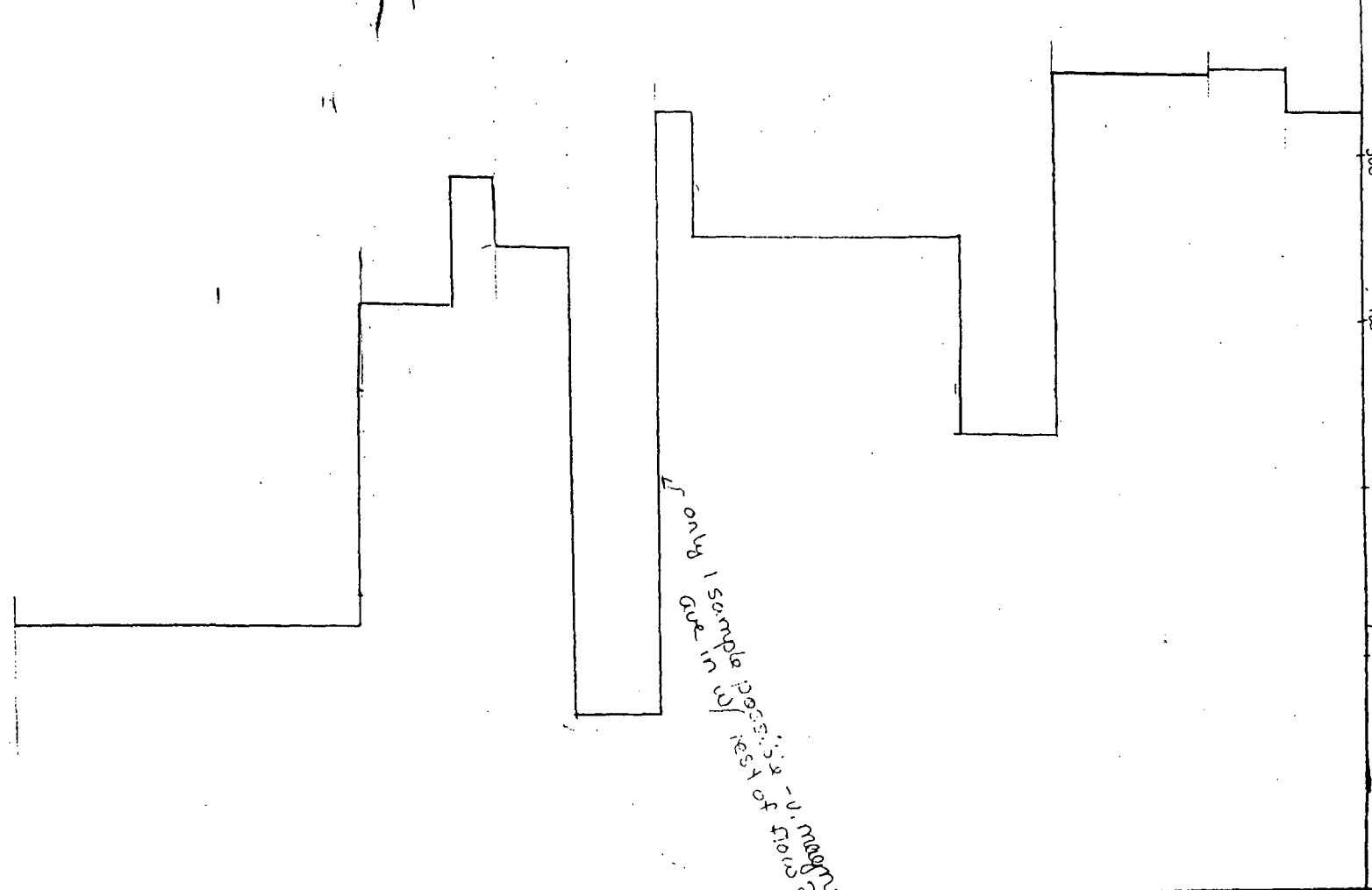
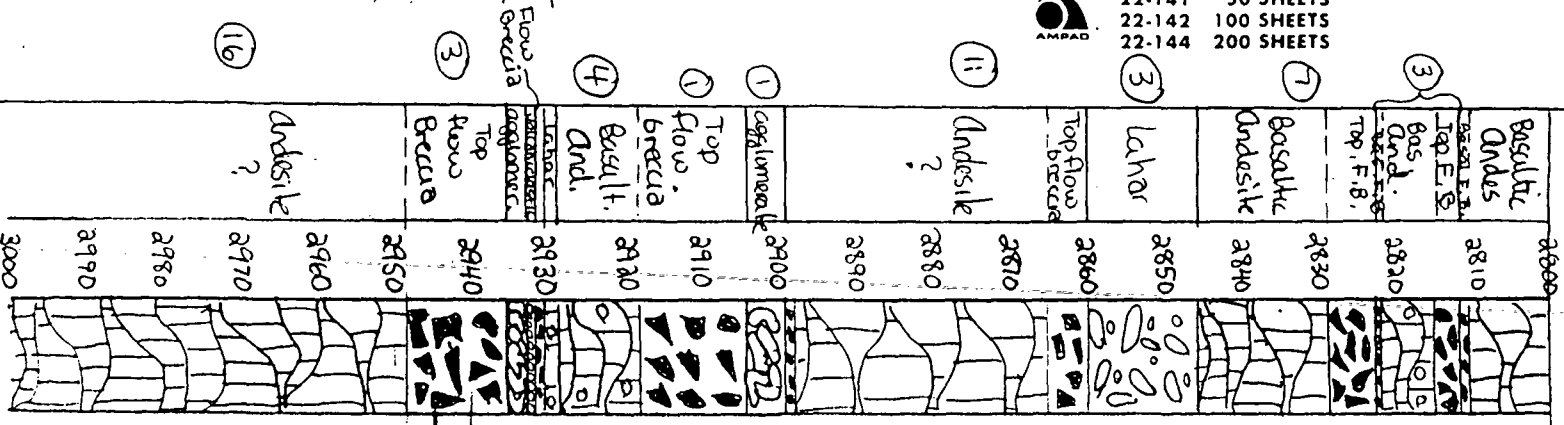

only 1 sample possible for K₂O for flow breccia - U. magnetics

22-141 50 SHEETS
 22-142 100 SHEETS
 22-144 200 SHEETS

21
 21

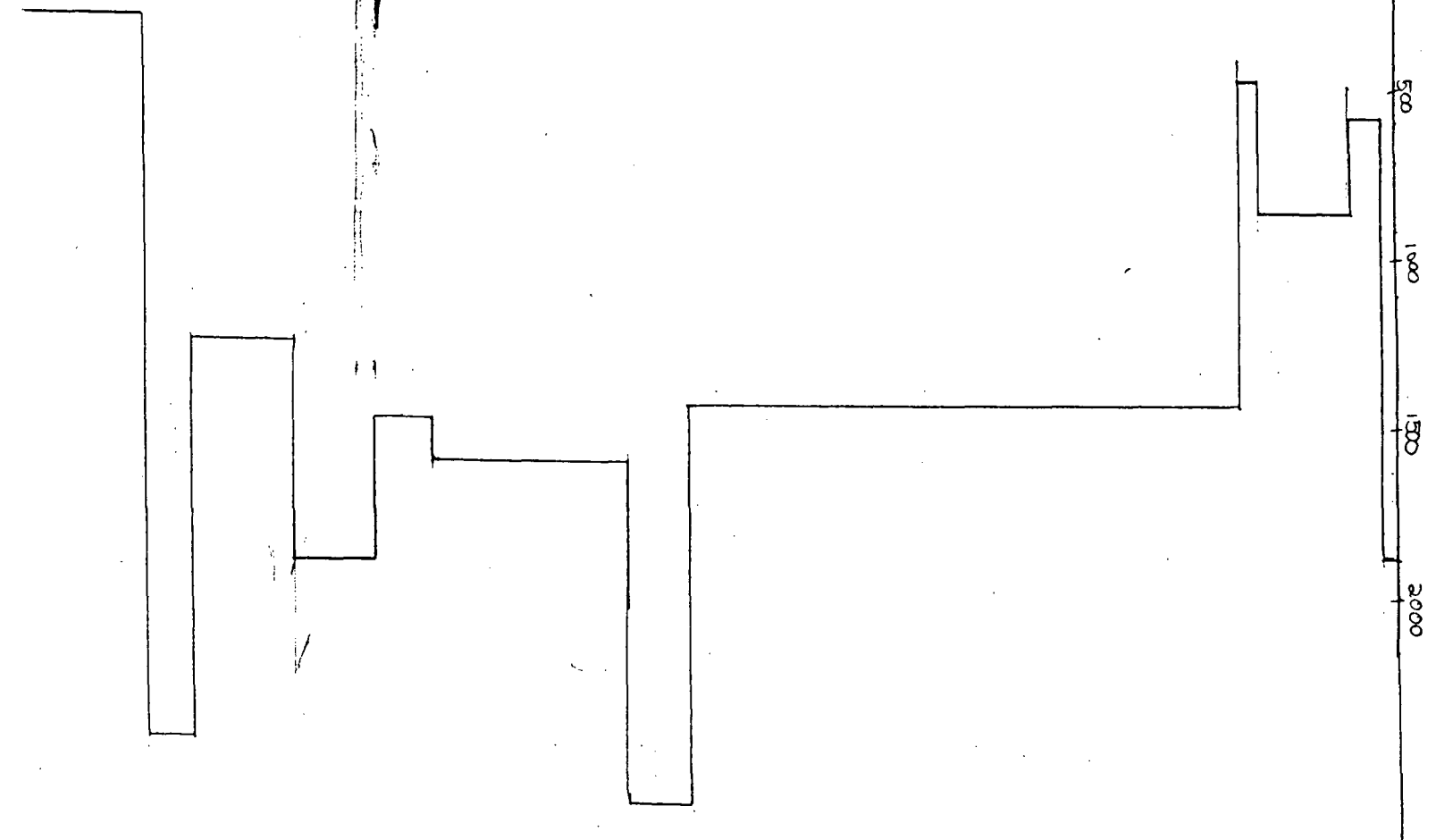
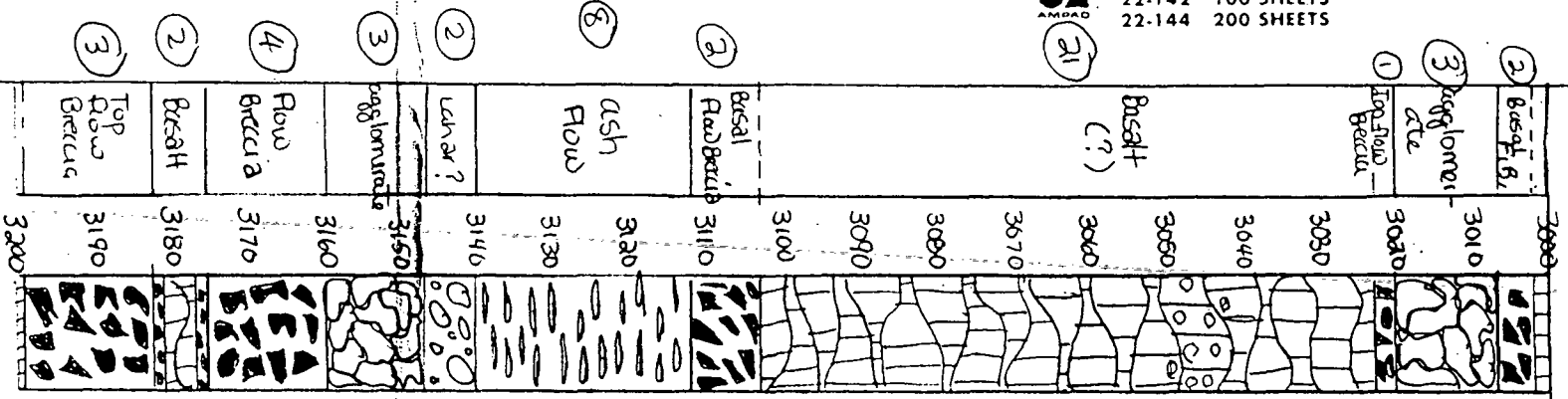

ave. susc. (10^{-6}) cgs

500 1000 1500 2000

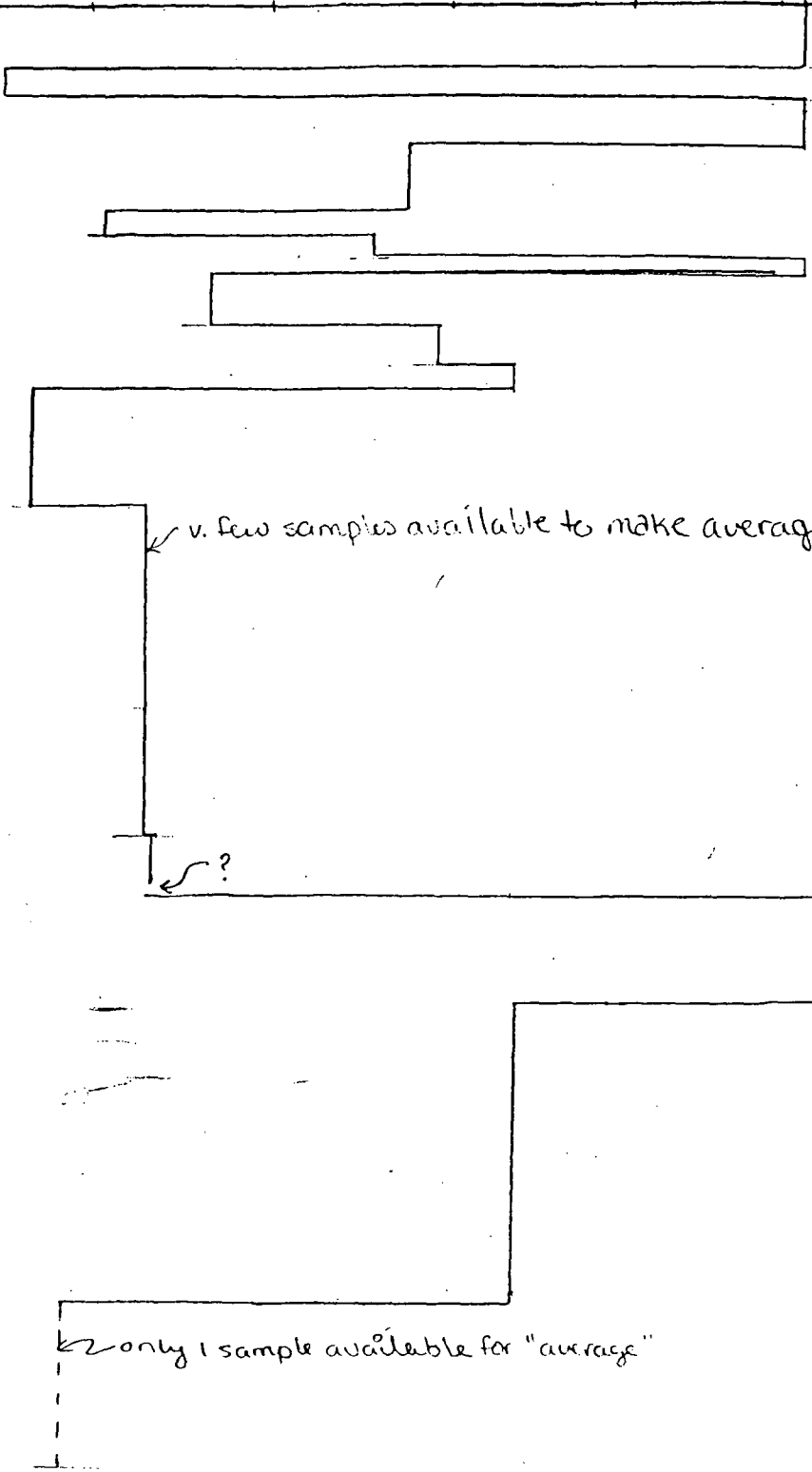
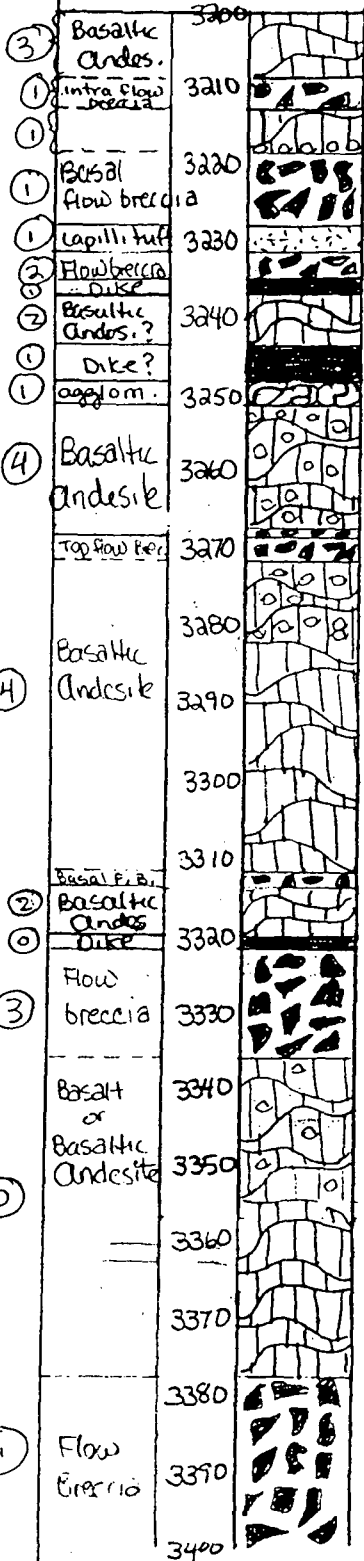

v. few samples available to make average

?

only 1 sample available for "average"

SECTION 22-142 100 SHEETS
22-144 200 SHEETS

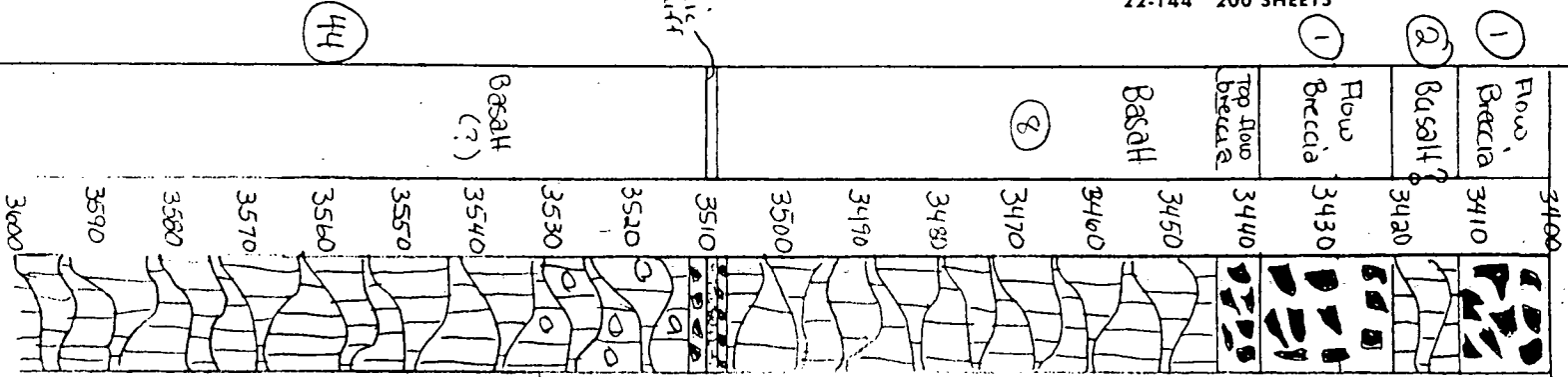

ave. susc. (10^{-6}) g/s
 500 1000 1500 2000

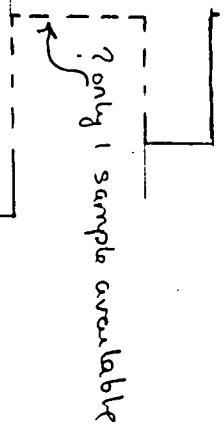

limited samples available for aves.

(44)



22-141 50 SHEETS
 22-142 100 SHEETS
 22-144 200 SHEETS

3660	Basalt	3660
3610	Basalt	3610
3660	Basalt	3660
3630	Basalt	3630
3610	Basalt	3610
3650	Basalt	3650
3620	Basalt	3620
3680	Basalt	3680
3670	Basalt	3670
3700	Basalt	3700
3710	Basalt	3710
3720	Basalt	3720
3730	ash flow	3730
3740	Top flow Breccia	3740
3760	Basalt	3760
3770	Basalt	3770
3780	Basalt F. B.	3780
3790	lahar?	3790
3800		3800



500
 1000
 1500
 2000

↑
 001ps
 off scale
 (5085/16)



22-141 50 SHEETS
 22-142 100 SHEETS
 22-144 200 SHEETS

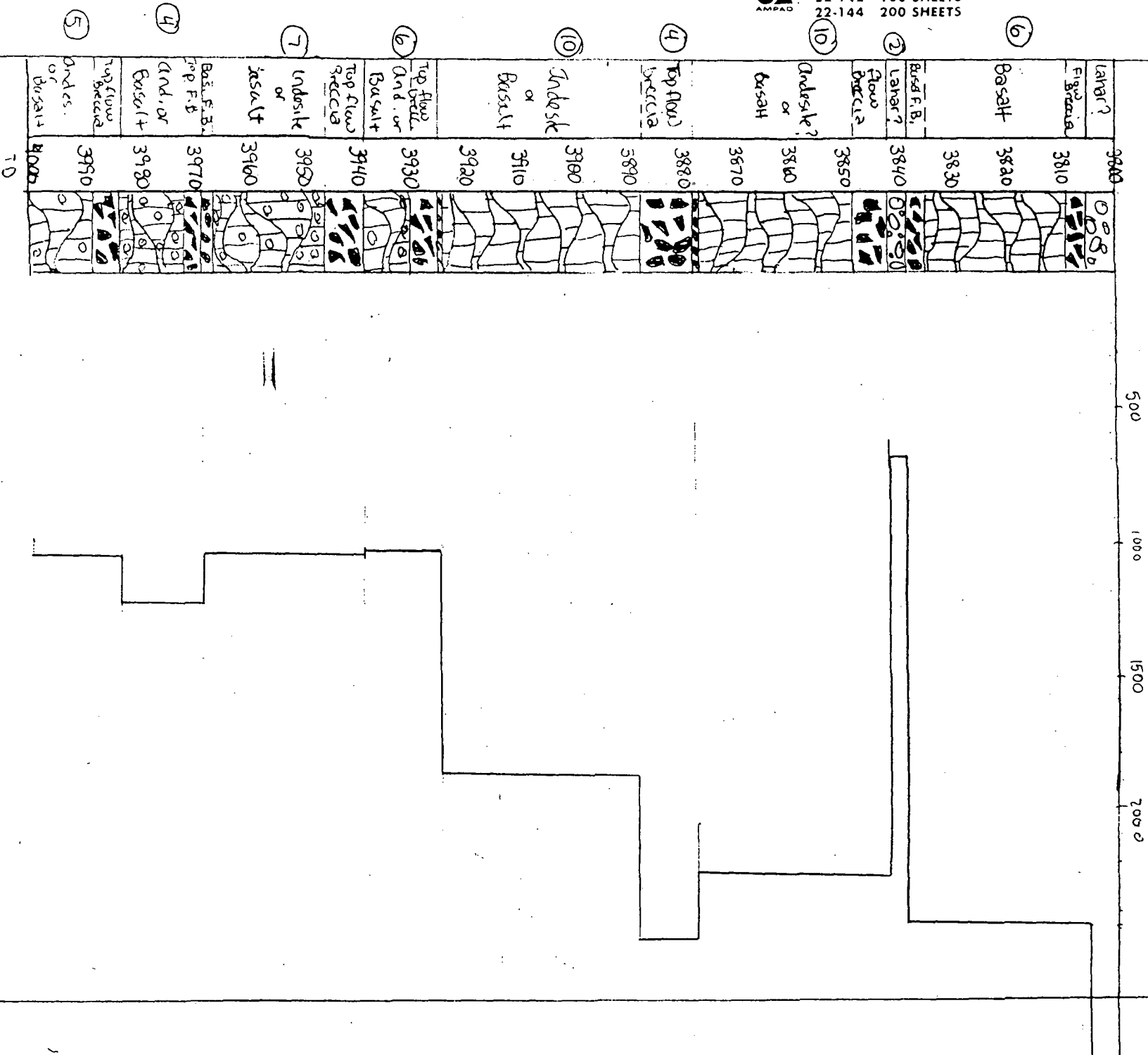

Lithologic Key

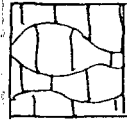

non vesic
Basalt,
Basaltic Andesite or
Andesite Flow

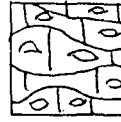

vesic.
Basalt, Basaltic Andesite or
Andesite flow

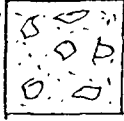

ash, cinders + scoria



Tuffs



agglomerates



Flow
Breccias

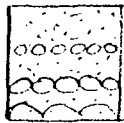

volcaniclastic



ASH FLOW



Lahar



Dike

22-141 50 SHEETS
22-142 100 SHEETS
22-144 200 SHEETS



GEO N-3

①

interval	ave susc. ($\cdot 10^{-6}$) cgs	interv	ave susc
452'-512'	1002.0		
512' - 705'	? 180.8	1236 - 1249	603.3
705' - 716.5'	575.2	1249 - 1263	1353.5
716.5' - 732'	79.0	1263' - 1276	581.5
732' - 762.5	278	1276' - 1279	1006.6
762.5 - 768'	? \approx 456.4	1279' - 1283'	485.8
768' - 802'	634.9	1283' - 1289'	541.9
802' - 803'	1416.2	1289' - 1290	?
803' - 805	?	1290' - 1291	565.7
805 - 810.5	2309.8	1291 - 1299	?
810 - 812	?	1297 - 1301.5	818.8
812 - 862	1540.3	1301.5 - 1328	210.4
862 - 905	282.4	1328 - 1335	337.6
905 - 974	1354.7	1335 - 1337	698.5
974 - 978	767.2		
978 - 1002	399.1	1337 - 1355	454
1002 - 1014	505.8	1355' - 1374'	247.2'
1014 - 1024	1731.8	1374 - 1471'	477.8'
1024 ^(?) - 1043	558.2	1471' - 1494.5	433.6
1043 - 1050	261.3	1494.5' - 1509'	1121.8
1050' - 1115	635.1	1509' - 1513'	1319.1
1115 - 1130	? 244.2	1513' - 1539'	654.4
1130 - 1144	541.1	1539' - 1550'	584.4
1144 - 1153	1254.2	1550' - 1565	383.3
1153 - 1180	1050.7	1565' - 1576.5'	678.0
		1576.5' - 1587'	647.8
1180 - 1194	451.2 (?)	1587' - 1597'	535.6
1194 - 1217	937.5	1597' - 1607.5'	737.7
1217 - 1224	?	1607.5 - 1659'	? 169.8
1224 - 1230	1346.4	1659' - 1686	823.6
		1686' - 1733'	621.1
1230 - 1236	?	1733 - 1734	164.9

interval	ave susc. ($\cdot 10^{-6}$) cgs	interval	ave susc. ($\cdot 10^{-6}$) cgs
1734' - 1736'	335.7	2456' - 2471.5'	531.6
1736' - 1742'	927.3	2471.5' - 2496.5'	624.2
1742' - 1746'	786.5	2496.5' - 2530.5'	223.0
1746' - 1755.5'	1414.9	2530.5' - 2545'	263.6
1755.5' - 1780	861.6	2545.5' - 2557'	635.9
	?	2557' - 2583	239.4
1780' - 1789.5	?	2583' - 2601.5'	233.7
1789.5' - 1790.5	510.4	2601.5' - 2605'	538.4
1790.5' - 1795	594.3	2605' - 2636	239.9
1795' - 1798	133.8	2636' - 2656.5	358.3
1798 - 1800'	65.9'	2656.5 - 2681	450.4
1800' - 1861'	? ~ 167.5	2681' - 2713'	357.2
1861' - 1863'	708	2713' - 2741.5'	203.2
1863 - 1920	226.4	2741.5' - 2812'	368.2
1920 - 1925.5'	42.4	2812' - 2823'	226.2
1925.5' - 2044'	783.1	2823' - 2846'	237.1
2044' - 205.5'	484.9	2846' - 2860'	1319.2
2105.5' - 2134'	584.5	2860' - 2899'	581.7
2134 - 2227	850	2899' - 2909'	385
2227 - 2231.5	2816.3	2909' - 2918'	2144.2 ?
223	264.6	2918' - 2928'	785.6
2252' - 2269'	532.4	2928 - 2935'	561.6
2269' - 2283.5'	391.2	2935' - 2948'	938.7
2283.5' - 2315	546.8	2948 - 3002	1893.9
2315' - 2368'	860.0	3002 - 3007	594.6
2368' - 2400'	552.2	3007 - 3020	851.6
2400' - 2413'	797.8	3020 - 3023	459.3
2413' - 2422	595.6	3023 - 3103	1404.3
2422 - 2449	1375.1	3103 - 3112'	2572.1
2449 - 2456'	365.8	3112 - 3140	1563.4

interval	ave. susc. (10^{-6})
3140' - 3147'	1413.4
3147 - 3160'	1874.8
3160' - 3175.5'	1203.3
3175.5' - 3183.5'	2385.3
3183.5' - 3199'	254.2
3199' - 3219'	246.1
↳ 3209' - 3213'	354.3
3219' - 3228.5'	1381.6
3228.5' - 3231'	532.9
3231 - 3235'	1287.4
3235' - 3237'	2457.7
3237 - 3244'	824.9
3244' - 3248'	1471.8
3248' - 3251'	1663.5'
3251' - 3269'	317.7
3269' - 3314'	645.9
3314 - 3320	672.6
3320 - 3322	?
3322 - 3336'	3179.8
3336' - 3378	1680.8
3378 - 3412'	418.9?
3412' - 3421.5'	794.0
3421.5' - 3438'	424.6?
3438 - 3509'	922.3
3509' - 3729'	1243.8
3729' - 3742.5'	1426.3
3742.5' - 3756'	858.5
3756' - 3784'	2633.6
3784' - 3791'	2645.9
3791' - 3805'	5085.6
3805' - 3839'	2434

interval	ave susc
3839' - 3842'	692.7
3842' - 3877'	2236.9
3877' - 3888.5'	2495.5
3888.5' - 3924.5	1898.1
3924.5' - 3939'	1012.1
3939' - 3969'	1048.1
3969' - 3984'	1217.1
3984' - 4002'	1040.1

combining
?

7