

GL02680

Schlumberger

# DIRECTIONAL LOG

COMPUTED

COUNTY CASSIA	COMPANY E G AND G IDAHO, INC.
FIELD or LOCATION RAFT RIVER	WELL RRGF NO. 4B
LOCATION RRGF NO. 4B	FIELD RAFT RIVER
COMPANY EG & G IDAHO, INC.	COUNTY CASSIA STATE IDAHO
LOCATION	Other Services: DIL, BHC, FBS FDC/CNL-GR
Sec. 23 Twp. 15S Rge. 26E	

Permanent Datum: GL; Elev.: 4840	Elev.: K.B. 4856
Log Measured From KB, 16 Ft. Above Perm. Datum	D.F. 4855
Drilling Measured From KB	G.L. 4840

Date	11-13-78			
Run No.	ONE			
Depth-Driller	5115			
Depth-Logger	5126			
Btm. Log Interval	5124			
Top Log Interval	3470			
Depth intervals between shots -	100'			
Casing-Driller	9-5/8@ 3457 @ @ @			
Casing-Logger	3471			
Bit Size	8-3/4			
Type Fluid in Hole	FORMATION WATER (FLOWING)			
Dens.	Visc.			
pH	Fluid Loss	7.2	-- ml	ml ml ml ml
Source of Sample	FLOWLINE			
Rmf @ Meas. Temp.	2.05 @ 42 °F	@ °F	@ °F	@ °F
Rm @ BHT	.62 @ 250 °F	@ °F	@ °F	@ °F
Time Since Circ.	NA			
Max. Rec. Temp.	252 °F	°F	°F	°F
Equip.	Location	8060	EVSTN.	
Recorded By	ROONEY-CHR	STENSEN		
Witnessed By	STEADHAM-NELSON			

The well name, location and borehole reference data were furnished by the customer.  
 All interpretations are opinions based on inferences from electrical or other measurements and we cannot, and do not, guarantee the accuracy or correctness of any interpretations, and we shall not be held liable for any loss, costs, damages or expenses incurred or sustained by anyone resulting from any interpretation made by one of our officers, agents or employees. These interpretations are also subject to Clause 7 of our General Terms and Conditions as set out in our current Price Schedule.

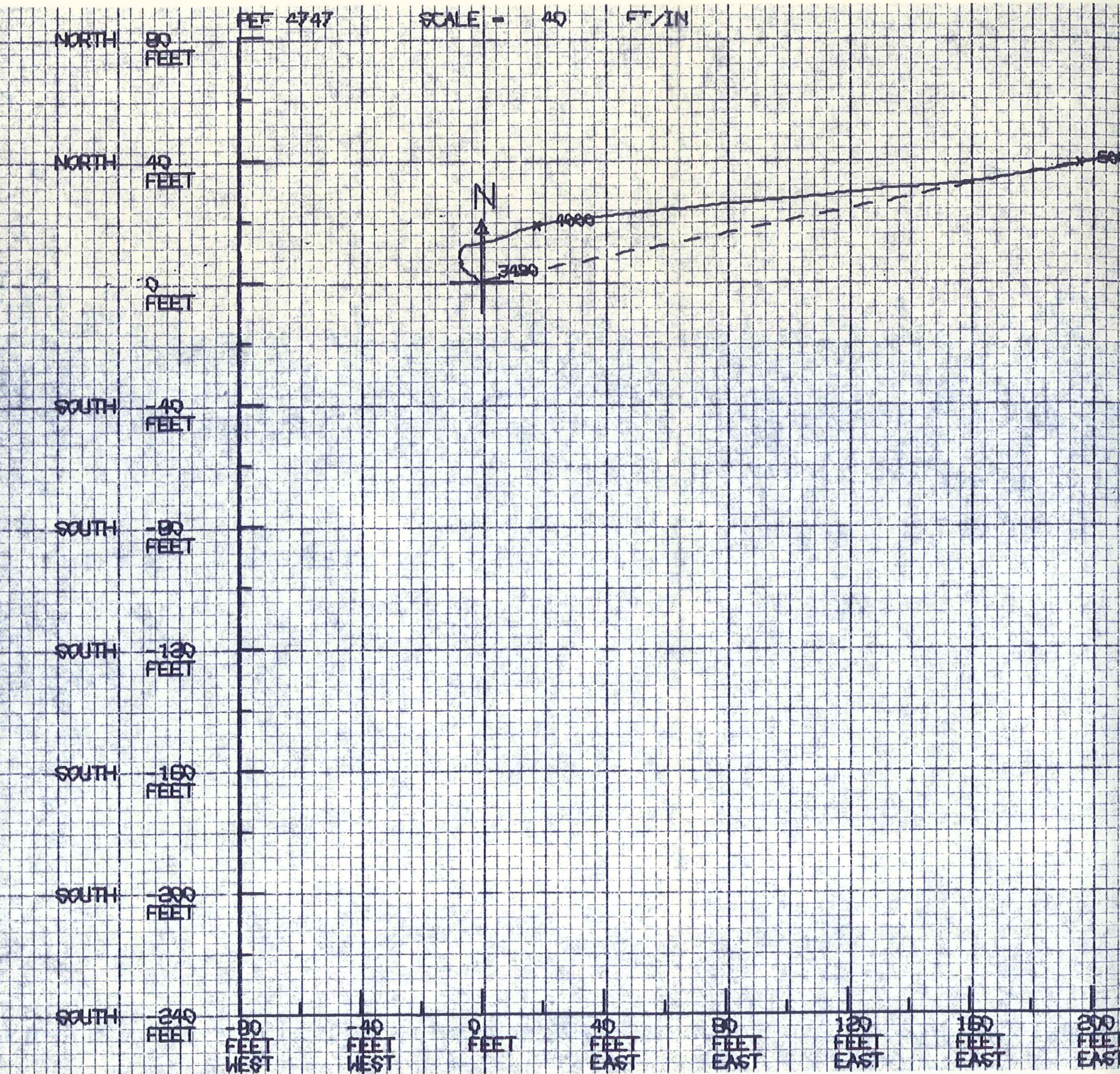



REF 4747 CROSS-SECTION LOOKING WEST HORIZ SCALE = 40 FT/IN VERT SCALE = 800 FT/IN

-240 FEET SOUTH    -200 FEET SOUTH    -160 FEET SOUTH    -120 FEET SOUTH    -80 FEET SOUTH    -40 FEET SOUTH    0 FEET    40 FEET NORTH    80 FEET NORTH

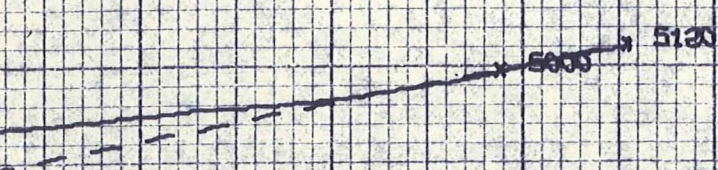

800 FT

1600 FT

2400 FT

3200 FT

3490

4000 FT

4800 FT

5600 FT

6400 FT

5000  
5120

120 FEET EAST

160 FEET EAST

200 FEET EAST

240 FEET EAST



FT/IN

REF 4747 CROSS-SECTION LOOKING NORTH HORIZ SCALE - 40 FT/IN VERT SCALE - 800 FT/IN

-80 FEET WEST -40 FEET WEST 0 FEET 40 FEET EAST 80 FEET EAST 120 FEET EAST 160 FEET EAST 200 FEET EAST 240 FEET EAST

EXACT R

800 FT

BOTTOM H

1600 FT

COURSE L

2400 FT

COURSE A

3200 FT

MEASURED

3400

TRUE VER

4000 FT

DISTANCE

4800 FT

DISTANCE

5600 FT

5000 5120

6400 FT

REF 4747

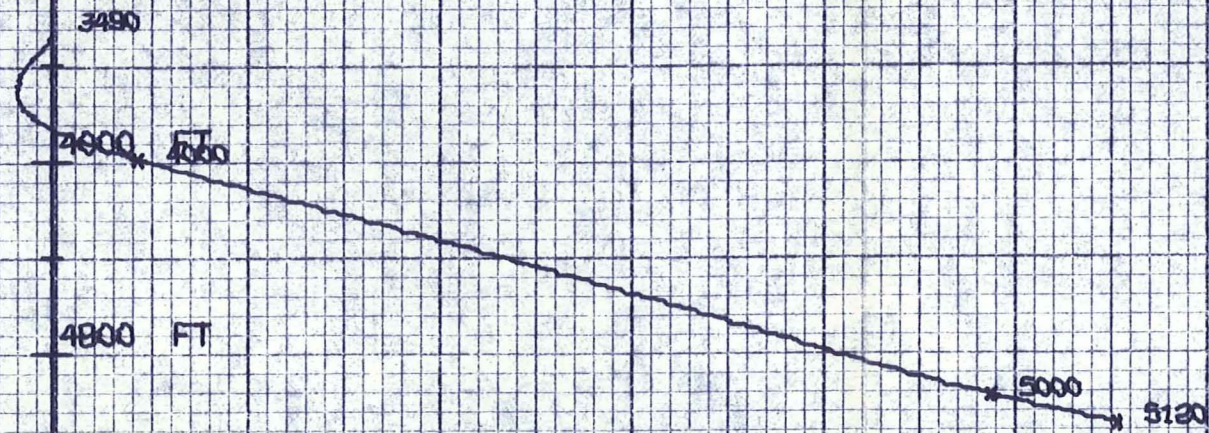



EXACT RADIUS OF CURVATURE METHOD

BOTTOM HOLE LOCATION

COURSE LENGTH 226.7 FEET

COURSE AZIMUTH 78.9 DEG.

MEASURED DEPTH 5120.0 FEET

TRUE VERTICAL DEPTH 5098.6 FEET

DISTANCE NORTH 43.6 FEET

DISTANCE EAST 222.5 FEET

REF 4747

COMPANY	E G AND G IDAHO, INC.	SCHL. FR	5124
WELL	RRGP NO. 4B	SCHL. TD	5126
FIELD	RAFT RIVER	DRLR. TD	5115
COUNTY	CASSIA	STATE	IDAHO
		Elev: KB	4856
		DF	4855
		GL	4840