

GLO3011-3068

WELL CO

WELL COMPLETION OR RECOMPLETION REPORT AND WELL LOG

LOG

DESIGNATE TYPE OF COMPLETION:

NEW WELL WORK OVER DEEPEN PLUG BACK SAME RESERVOIR DIFFERENT RESERVOIR DRY STEAM HOT WATER DRY

DESCRIPTION OF WELL AND LEASE

OPERATOR: Geothermal Kinetics Inc. ADDRESS: Suite 117, 301 West Indian School Phoenix, Ariz. 85013

FEDERAL, STATE OR INDIAN LEASE NUMBER OR NAME OF LESSOR IF FEE LEASE: 1 FIELD & RESERVOIR: Power Geothermal Prospect

LOCATION: 1980 ft N. & 660 ft W. of SE cor COUNTY: Maricopa

SEC. TWP-RANGE OR BLOCK & SURVEY: 1 T2S R6E

DATE SPUDDED: Jan 31, 1973 DATE TOTAL DEPTH REACHED: April 8, 1973 DATE COMPLETED, READY TO PRODUCE: ELEVATION (DF, RKB, RT, OR GR.): 1358 KB FEET ELEVATION OF CASING HD. FLANGE: FEET

TOTAL DEPTH: 9207 ft. P.B.T.D.: AIRDRILLED (INTERVAL): 5404-6153 FLUIDDRILLED (INTERVAL): 6153 to 9207 aerated water.

PRODUCING INTERVAL (S) FOR THIS COMPLETION: 6167-8998 ROTARY TOOLS USED (INTERVAL): Entire Hole CABLE TOOLS USED (INTERVAL):

WAS THIS WELL DIRECTIONALLY DRILLED? WAS DIRECTIONAL SURVEY MADE? WAS COPY OF DIRECTIONAL SURVEY FILED? DATE FILED:

TYPE OF ELECTRICAL, TEMPERATURE, CEMENT BOND OR OTHER LOGS RUN (CHECK LOGS FILED WITH THE COMMISSION): IES, Gamma Ray, Neutron, Cement Bond, Temp, Acoustic DATE FILED:

CASING RECORD

CASING (REPORT ALL STRINGS SET IN WELL-CONDUCTOR, SURFACE, INTERMEDIATE, PRODUCING, ETC.)

PURPOSE	SIZE HOLE DRILLED	SIZE CASING SET	WEIGHT (LB./FT.)	DEPTH SET	SACKS CEMENT	AMT. PULLED
Surface	26"		47#	0-204'	4005x	2% NaCl
Intermediate	17 1/2"	13 3/8"	60#	0-3117'	20,505x	30% SiO2
Set on Top Pay	12 1/4"	9 5/8"	40#	2903-5404	6505x	30% SiO2 - 2% NaCl
Blank Prod Line	8 1/2"	7"	29#	5201-9064	8255x	20% SiO2 - 1% NaCl

TUBING RECORD				LINER RECORD			
SIZE IN.	DEPTH SET FT.	PACKER SET AT FT.	SIZE IN.	TOP FT.	BOTTOM FT.	SACKS CEMENT	SCREEN (FT.)

PERFORATION RECORD			ACID, SHOT, FRACTURE, CEMENT SQUEEZE RECORD		
NUMBER PER FT.	SIZE & TYPE	DEPTH INTERVAL	AMT. & KIND OF MATERIAL USED	DEPTH INTERVAL	
20 bullets		6154-6174	4 bullets 6360-6363	8 jets	8148-8152
21 bullets		6212-6232	8 bullets 6314-6322 10 jets 6140-6150	8 jets	7752-7760
25 bullets		6323-6347	INITIAL PRODUCTION 10 jets 6174-6184	4 jets	6309-6313

DATE	STATIC TEST SHUT IN WELL HEAD		ANALYSIS OF FLUIDS & GASES						SEPARATOR DATA			
			TOTAL MASS FLOW DATA									
	TEMP. °F	PRES. PSIG.	LBS./HR.	TEMP. °F	PRES. PSIG.	ENTHALPY	ORIFICE	WATER CUFT/HR.	STEAM LBS./HR.	PRES. PSIG.	TEMP. °F	

CERTIFICATE: I, THE UNDERSIGNED, UNDER THE PENALTY OF PERJURY, STATE THAT I AM THE Exec. Vice Pres. OF THE Geothermal Kinetics Inc. (COMPANY), AND THAT I AM AUTHORIZED BY SAID COMPANY TO MAKE THIS REPORT; AND THAT THIS REPORT WAS PREPARED UNDER MY SUPERVISION AND DIRECTION AND THAT THE FACTS STATED THEREIN ARE TRUE, CORRECT AND COMPLETE TO THE BEST OF MY KNOWLEDGE.

February 27, 1974

Mike O'Donnell
SIGNATURE

DATE

RECEIVED

MAR 13 1974

O & G COMS. COMM.

STATE OF ARIZONA
OIL & GAS CONSERVATION COMMISSION

WELL COMPLETION OR RECOMPLETION REPORT AND WELL LOG

FILE ONE COPY

PERMIT NO. 605

FORM NO. D-1

**APPLICATION FOR PERMIT TO DRILL OR RE-ENTER
GEOHERMAL RESOURCES WELL**

APPLICATION TO DRILL

RE-ENTER OLD WELL

GEOHERMAL KINETICS SYSTEMS CORPORATION

NAME OF COMPANY OR OPERATOR

301 WEST INDIAN SCHOOL RD. PHOENIX ARIZONA

ADDRESS CITY STATE

GEO DRILLING INC.

DRILLING CONTRACTOR

301 WEST INDIAN SCHOOL RD. PHOENIX ARIZONA

ADDRESS

DESCRIPTION OF WELL AND LEASE

FEDERAL, STATE OR INDIAN LEASE NUMBER, OR IF FEE LEASE: NAME OF LESSOR	WELL NUMBER	ELEVATION (GROUND)
POWER RANCHES INC.	1	1338'

NEAREST DISTANCE FROM PROPOSED LOCATION TO PROPERTY OR LEASE LINE: 660 FEET	DISTANCE FROM PROPOSED LOCATION TO NEAREST DRILLING COMPLETED OR APPLIED FOR WELL ON THE SAME LEASE: None FEET
--	---

NUMBER OF ACRES IN LEASE: 1791	NUMBER OF WELLS ON LEASE, INCLUDING THIS WELL. COMPLETED IN OR DRILLING TO THIS RESERVOIR: None
-----------------------------------	--

IF LEASE, PURCHASED WITH ONE OR MORE WELLS DRILLED, FROM WHOM PURCHASED: NAME ADDRESS
-0-

WELL LOCATION (GIVE FOOTAGE FROM SECTION LINES) 980' N. & 660' W. of SE corner of Sec. 1	SECTION-TOWNSHIP-RANGE OR BLOCK AND SURVEY NE/4 SE/4 Sec. 1 T2S R6E	DEDICATION (COMPLY WITH RULE G-105) SE/4 Sec 1-2S-6E
---	--	---

FIELD AND RESERVOIR (IF WILDCAT, SO STATE) Wildcat	COUNTY Maricopa
---	--------------------

DISTANCE, IN MILES, AND DIRECTION FROM NEAREST TOWN OR POST OFFICE
2 miles SE of Higley

PROPOSED DEPTH: 6000'	ROTARY OR CABLE TOOLS Rotary	APPROX. DATE WORK WILL START Jan. 22, 1973
--------------------------	---------------------------------	---

BOND STATUS AMOUNT 5000.00 ATTACHED	ORGANIZATION REPORT ON FILE ON (ATTACHED) <input checked="" type="checkbox"/>	FILING FEE OF \$25.00 (ATTACHED) <input checked="" type="checkbox"/>
--	--	---

REMARKS: We have shown the SE/4 of Section 1-T2S-R6E dedicated to the well and after completion it might be desirable based upon the information obtained to adjust the dedication either up or down. Diagram of blowout equipment attached.

(TIGHT HOLE) MOD

CERTIFICATE: I, THE UNDERSIGNED, UNDER THE PENALTY OF PERJURY, STATE THAT I AM THE Vice-President Corp. OF THE Geothermal Kinetics Systems (COMPANY), AND THAT I AM AUTHORIZED BY SAID COMPANY TO MAKE THIS REPORT; AND THAT THIS REPORT WAS PREPARED UNDER MY SUPERVISION AND DIRECTION AND THAT THE FACTS STATED THEREIN ARE TRUE, CORRECT AND COMPLETE TO THE BEST OF MY KNOWLEDGE.

CONFIDENTIAL

Release Date

Mike O'Donnell
SIGNATURE

Jan 15, 1973
DATE

PERMIT NUMBER: 605
APPROVAL DATE: 1-15-73
APPROVED BY: *UBA*
NOTICE: BEFORE SENDING IN THIS FORM BEURE THAT YOU HAVE GIVEN

STATE OF ARIZONA
OIL & GAS CONSERVATION COMMISSION

APPLICATION TO DRILL OR RE-ENTER
FILE TWO COPIES

RECEIVED

JAN 15 1973

OPERATOR SHALL OUTLINE THE DEDICATED ACREAGE FOR GEOTHERMAL RESOURCES WELLS ON THE PLAT.

REGISTERED PROFESSIONAL ENGINEER OR LAND SURVEYOR REGISTERED IN THE STATE OF ARIZONA OR APPROVED BY THE COMMISSION SHALL SHOW ON THE PLAT THE LOCATION OF THE WELL AND CERTIFY THIS INFORMATION IN THE SPACE PROVIDED.

ALL DISTANCES SHOWN ON THE PLAT MUST BE FROM THE OUTER BOUNDARIES OF THE SECTION.

IS THE OPERATOR THE ONLY OWNER IN THE DEDICATED ACREAGE OUTLINED ON THE PLAT BELOW? YES NO

IF THE ANSWER TO QUESTION FOUR IS "NO" HAVE THE INTERESTS OF ALL THE OWNERS BEEN CONSOLIDATED BY COMMUNITIZATION AGREEMENT OR OTHERWISE? YES NO IF ANSWER IS "YES" TYPE OF CONSOLIDATION _____

IF THE ANSWER TO QUESTION FOUR IS "NO", LIST ALL THE OWNERS AND THEIR RESPECTIVE INTERESTS BELOW:

owner Powers Ranches Inc.	Land Description 1/4 NE 1/4 Sec. 1 T25 R6E Maricopa County Arizona
------------------------------	--

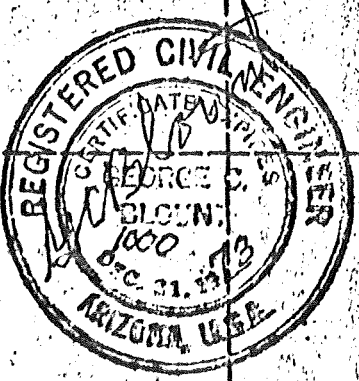
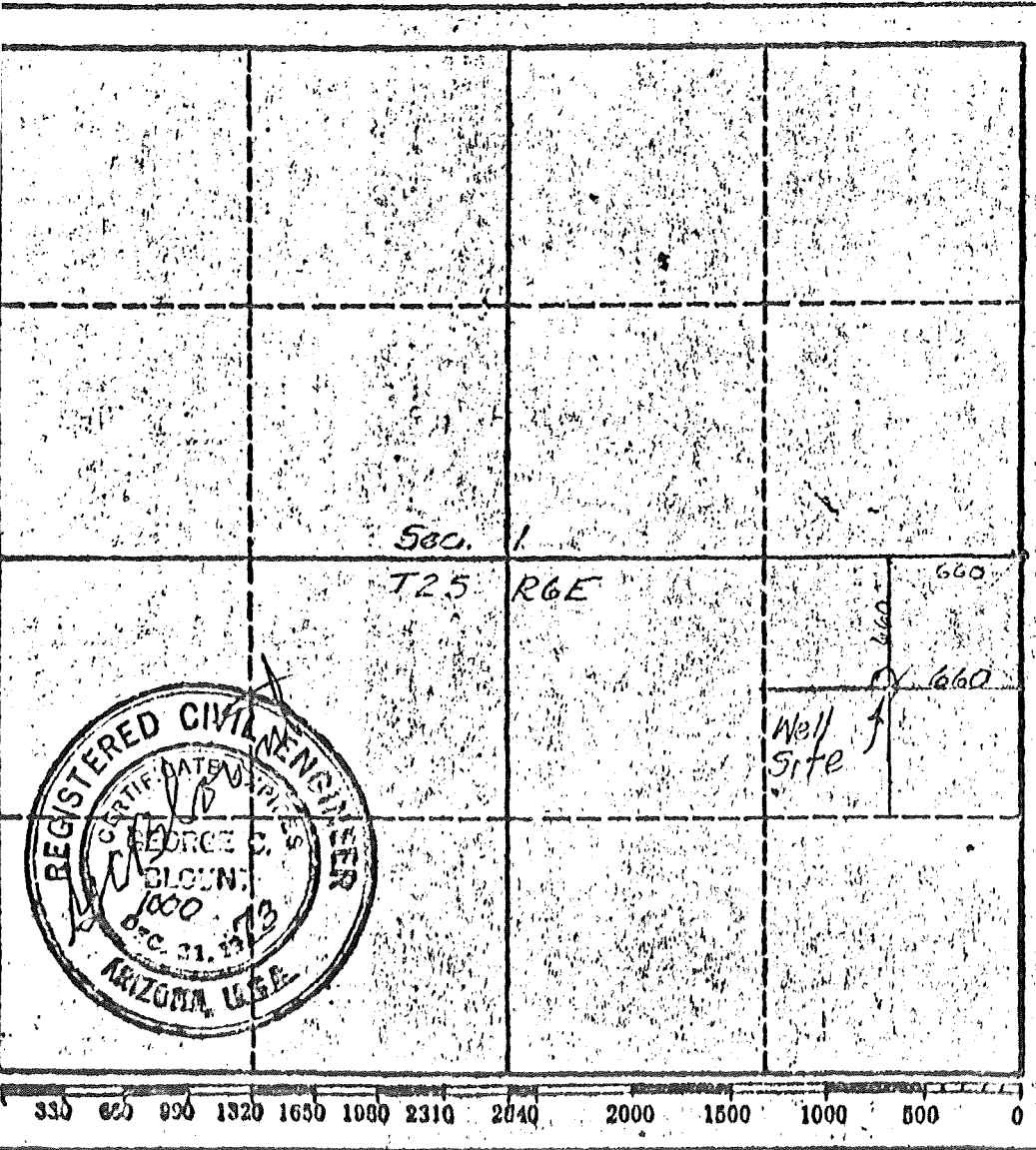

CERTIFICATION

I hereby certify that the information above is true and complete to the best of my knowledge and belief.

Name	<i>Mike O'Donnell</i>
Position	<i>Vice President</i>
Company	<i>Geothermal Kinetics Systems, Inc.</i>
Date	<i>Jan 15, 1973</i>

I hereby certify that the well location shown on the plat was plotted from field notes of actual surveys made by me or under my supervision, and that the same is true and correct to the best of my knowledge and belief.

Date Surveyed	<i>Jan 11, 1973</i>
Registered Professional Engineer and/or Land Surveyor	<i>George C. Blunt PE</i>
Certificate No.	<i>1000 4519</i>

PROPOSED CASING PROGRAM

Size of Casing	Weight	Grade & Type	Top	Bottom	Cementing Depth	Sacks Cement
20"	94.0#	H-40	0	200	200	Circulate
13 3/8"	61.0#	J-55	0	3,500	3,500	Circulate

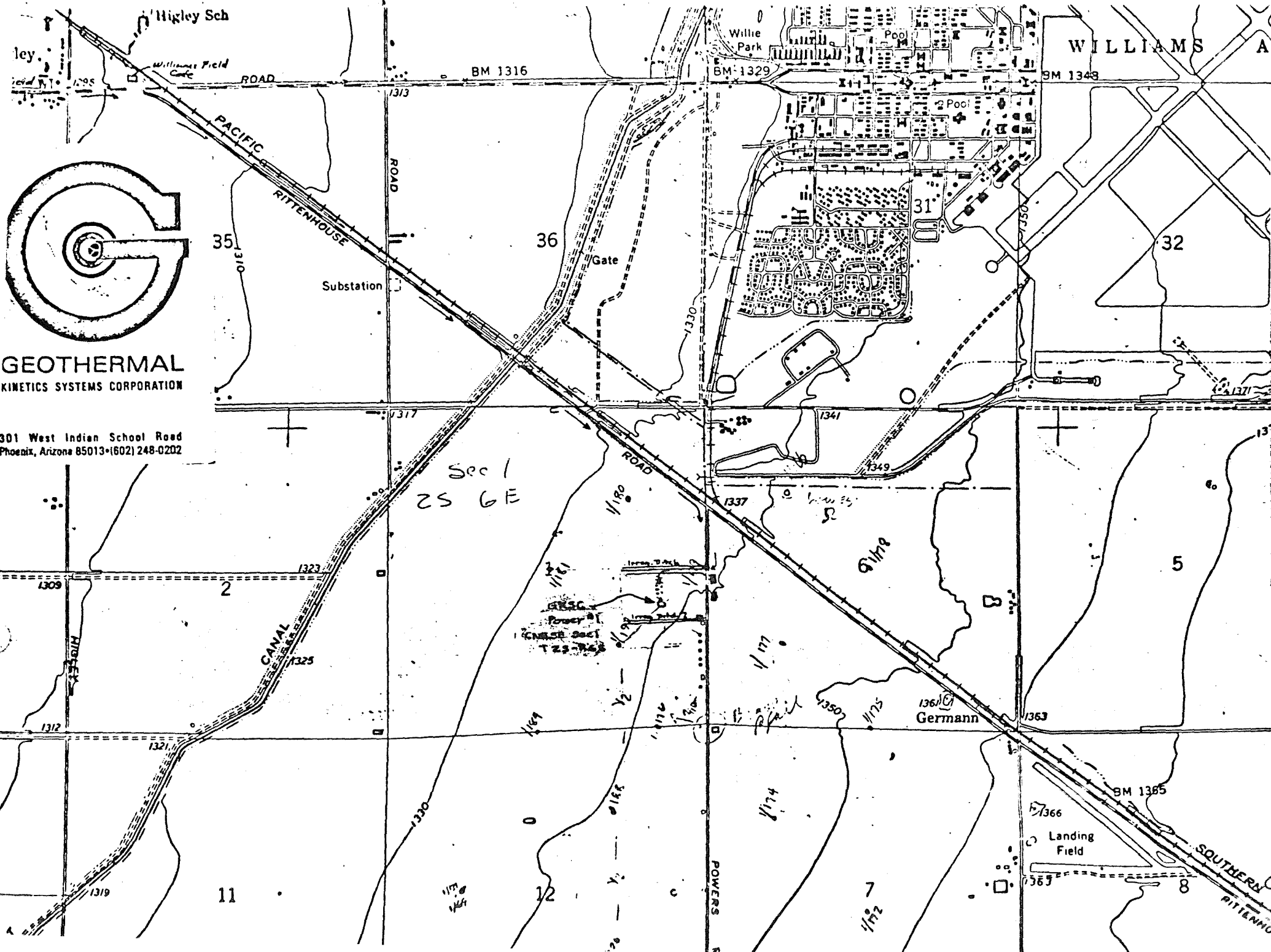

Higley Sch
 Williams Field Gate
 ROAD

BM 1316

BM 1329

BM 1348

WILLIAMS A

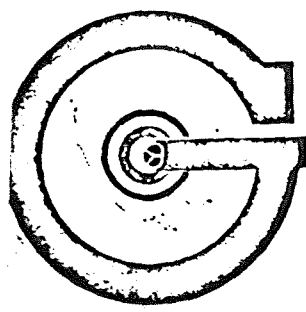

GEO THERMAL
 KINETICS SYSTEMS CORPORATION

301 West Indian School Road
 Phoenix, Arizona 85013-(602) 248-0202

*Sec 1
 25 GE*

Germann

Landing Field

SOUTHERN
 RITTENHOUSE

35

36

31

32

2

5

11

12

7

BM 1365

1366

1367

ley

Willie Park

Pool

Substation

Gate

PACIFIC
 RITTENHOUSE

ROAD

ROAD

POWERS

RIGBY

CANAL

A

A

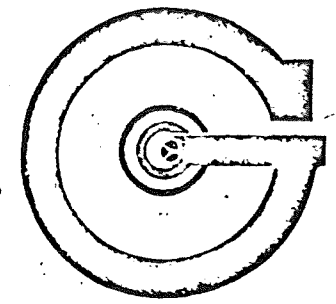
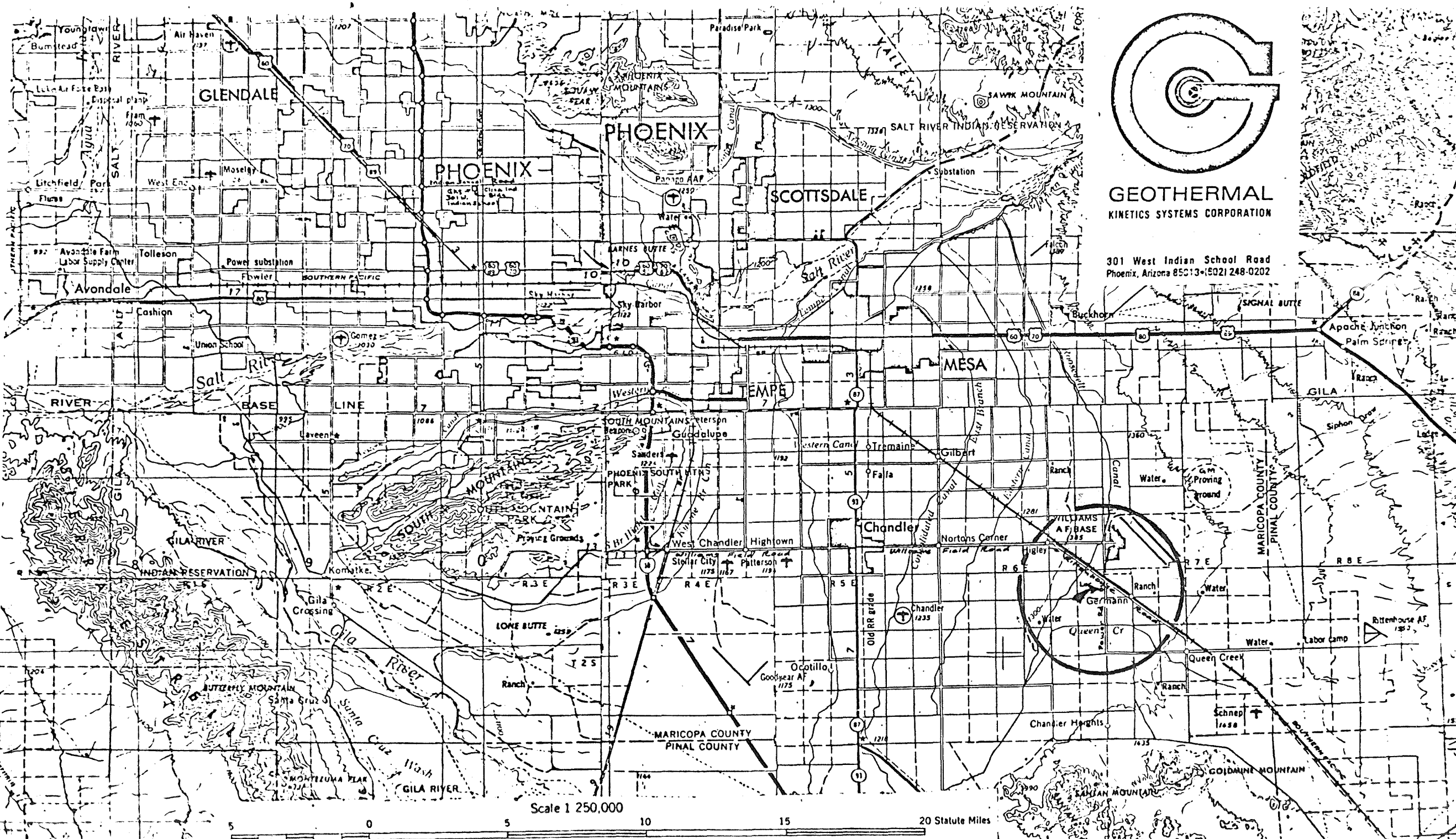

GEOTHERMAL
KINETICS SYSTEMS CORPORATION

301 West Indian School Road
Phoenix, Arizona 85013 • (602) 248-0202

Scale 1:250,000

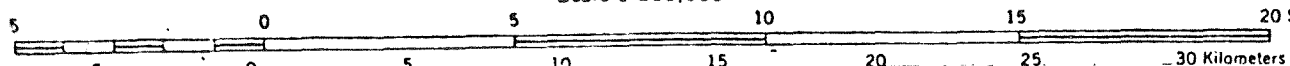

DRILL STEM TEST

FROM	TO	RESULTS
4626	4326	Rec approx. 2078 slightly gas & mud cut salty water est. temp 230°F IFP 328.8 FFP 1272.8- SIP 1541, HP 2499- (above mentioned gas was inert.)

CORE RECORD

FROM	TO	RECOVERY	REMARKS
			This well was cored. No infor. available 9-18-73

REMEDIAL HISTORY

STARTED - COMPLETED	WORK PERFORMED	NEW PERFORATIONS

ADDITIONAL INFORMATION

iles for water analysis & temp. surveys. Max recorded temp. 262.2°F, observed flowline 206°F. Reda Pump used to test well.