



DIRECTIONAL LOG
COMPUTED

COUNTY BEAVER
 FIELD WILDCAT
 WELL CFS 42-7
 COMPANY UNION OIL CO.
 COUNTY BEAVER STATE UTAH
 LOCATION SE-1/4, NE-1/4, NW-1/4
 Sec. 7 Twp. 26S Rge. 6W
 Other Services: DIL BHC-GP FDC/CNL-GP
 Permanent Datum: GL Elev.: 6422
 Log Measured From: KB 20 Ft. Above Perm. Datum Elev. K B 6442
 Drilling Measured From: KB C.L. 6422

The well name, location and borehole reference data were furnished by the customer.

REMARKS: All interpretations are opinions based on inferences from electrical or other measurements and we cannot, and do not, guarantee the accuracy or correctness of any interpretations, and we shall not, except in the case of gross or willful negligence on our part, be liable or responsible for any loss, cost, damages or expenses incurred or sustained by anyone resulting from any interpretation made by one of our officers, agents or employees. These interpretations are also subject to Clause 7 of our General Terms and Conditions as set out in our current Price Schedule.

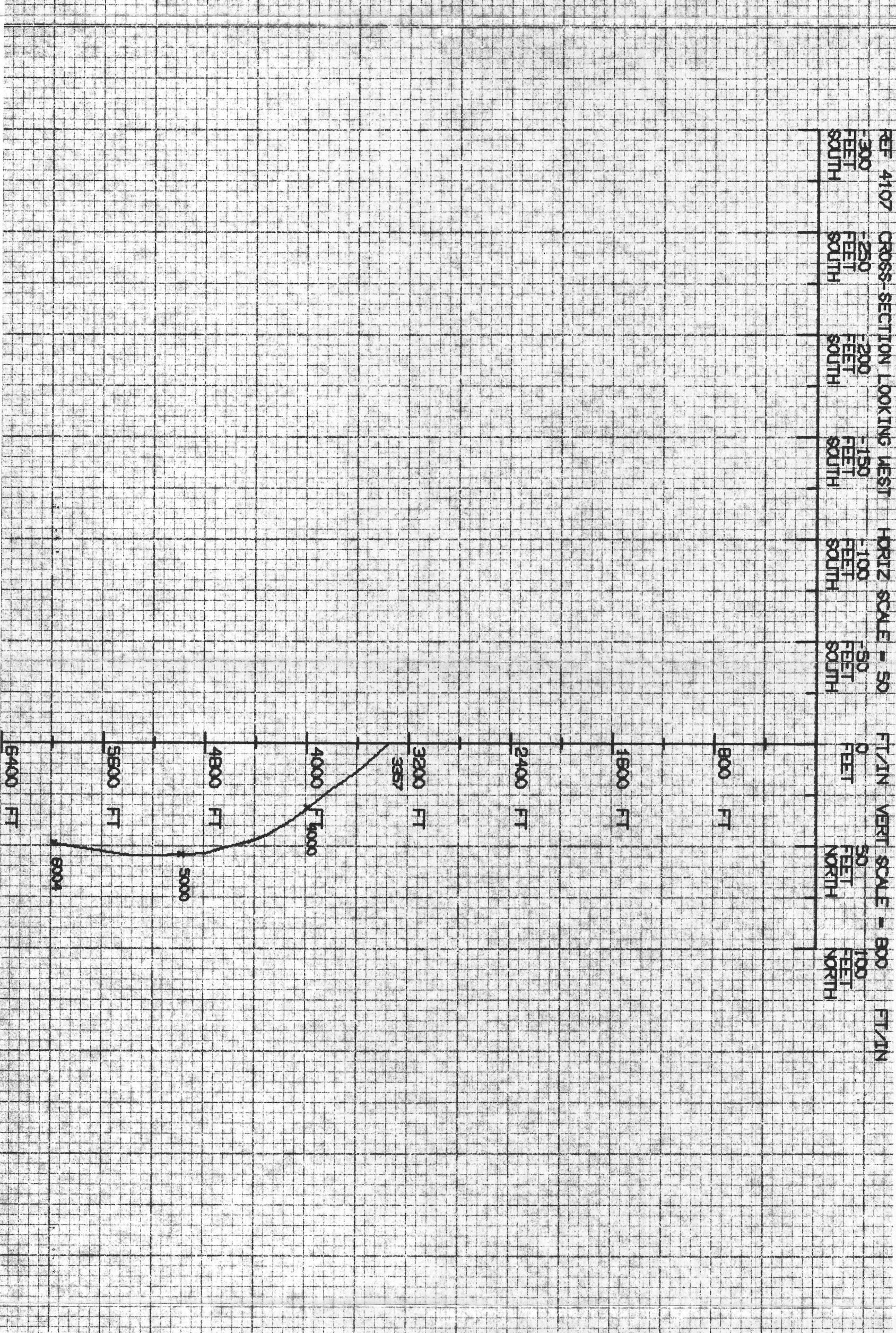
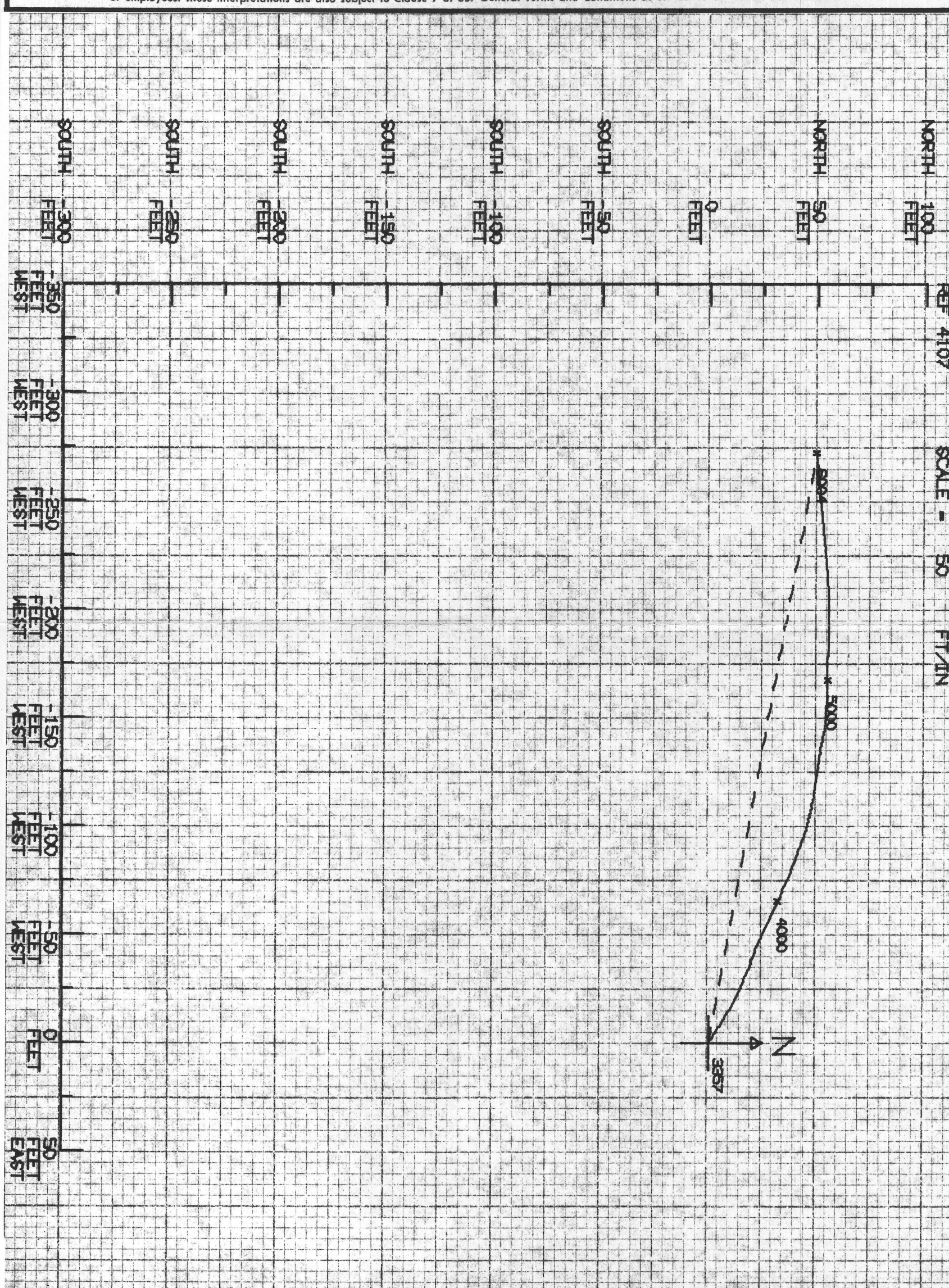

MEASURED DEPTH	TRUE VERTICAL DEPTH	DISTANCE NORTH	DISTANCE WEST
6004.0 FEET	5988.8 FEET	49.4 FEET	271.9 FEET

BOTTOM HOLE LOCATION	
COURSE LENGTH	276.4 FEET
COURSE AZIMUTH	280.3 DEG.

COMPANY	UNION OIL COMPANY OF CALIFORNIA	SCHL. FR	6003
WELL	CFS 42-7	SCHL. TD	6004
FIELD	WILDCAT	DRLR. TD	7705
COUNTY	BEAVER	STATE	UTAH
		Elev:	KB 6442
		DF	-----
		GL	6422