

BACA 12
STANDARD SURVEY TABLE

TA	MEAS. DEPTH	VERT. DEPTH	DRIFT		CUMULATIVE COORDINATES	
			ANGLE	BEARING	N S(-)	E W(-)
1				N07W		
2	200	200	1.45	N07W	2.51	-0.31
3	400	400	1.92	N17E	8.36	0.20
4	600	600	2.08	N23E	14.92	2.59
5	800	800	2.33	N26E	21.94	5.79
6	1000	999	2.22	N24E	29.13	9.14
7	1200	1199	1.78	N23E	35.53	11.93
8	1400	1399	1.25	N10E	40.61	13.43
9	1600	1599	1.08	N05E	44.65	13.96
10	1800	1799	0.95	N04E	48.18	14.24
11	2000	1999	0.67	N06E	50.99	14.48
12	2200	2199	0.33	N21W	52.72	14.26
13	2400	2399	1.08	N24W	55.01	13.31
14	2600	2599	1.42	N30W	58.90	11.33
15	2800	2799	2.25	N20W	64.69	8.63
16	3000	2999	1.83	N31W	71.13	5.56
17	3200	3199	1.17	N56W	74.92	1.95
18	3400	3399	0.83	S66W	75.23	-1.52
19	3600	3599	1.25	S47W	73.22	-4.55
20	3800	3799	1.08	S34W	70.12	-7.20
21	4000	3999	1.55	S62W	67.05	-10.61
22	4200	4199	2.17	S61W	63.95	-16.31
23	4400	4398	2.97	S53W	59.08	-23.83
24	4600	4598	2.92	S53W	52.90	-32.02
25	4800	4798	2.92	S41W	45.96	-39.47
26	5000	4998	2.62	S26W	37.91	-44.79
27	5200	5197	3.33	S24W	28.50	-49.18
28	5400	5397	3.50	S14W	17.23	-53.06
29	5600	5596	4.75	S16W	3.34	-56.78
30	5800	5796	4.92	S16W	-12.86	-61.43
31	6000	5995	5.22	S18W	-29.75	-66.59
32	6200	6194	4.95	S17W	-46.65	-71.92
33	6400	6393	5.00	S14W	-63.37	-76.56
34	6600	6593	5.00	S03W	-80.61	-79.13
35	6800	6792	4.50	S04W	-97.14	-80.15

EP 09,1981

WEIGHTING FACTOR: 0.50

TDOE

BACA 12
STANDARD SURVEY TABLE

STA	MEAS. DEPTH	VERT. DEPTH	DRIFT		CUMULATIVE COORDINATES	
			***** ANGLE	BEARING	N S(-)	E W(-)
36	7000	6991	4.42	S15W	-112.47	-82.71
37	7200	7191	3.92	S06W	-126.76	-85.36
38	7400	7390	3.50	S10W	-139.57	-87.16
39	7600	7590	3.22	S04E	-151.27	-87.77
40	7800	7790	2.72	S03E	-161.60	-87.14
41	8000	7990	3.17	S07E	-171.83	-86.25
42	8200	8189	2.58	S20E	-181.58	-83.90
43	8400	8389	1.92	S41E	-188.35	-79.92
44	8600	8589	1.42	S50E	-192.42	-75.77
45	8800	8789	2.38	S74E	-195.54	-69.92
46	9000	8989	2.50	N76E	-195.69	-61.40
47	9160	9148	4.17	N62E	-192.35	-52.71
48	9212	9200	4.17	N62E	-190.58	-49.38
49	9503	9489	11.50	N39E	-165.35	-18.77
50	9754	9732	16.00	N34E	-117.39	16.71
51	10094	10054	21.50	N37E	-28.42	80.18
52	10278	10225	22.00	N40E	24.94	122.62
53	10589	10511	24.50	N40E	118.99	201.54
54	10637	10555	24.50	N40E	134.23	214.33

SEP 09, 1981 WEIGHTING FACTOR: 0.50

TDOE

SEP 09, 1981

BACA-12

ELEV= 8450 FT, SCALE 200 FT/IN

AVE. ANGLE METHOD

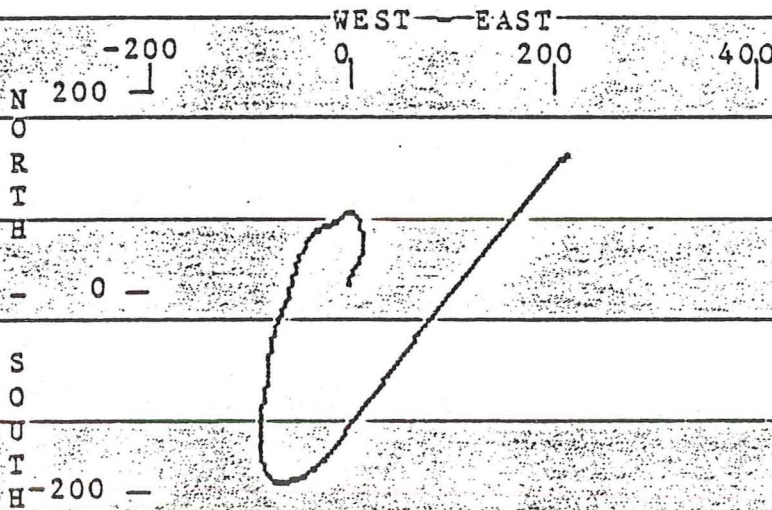

TDOE

SEP 09, 1981

BACA-12

ELEV= 8450 FT, SCALE 400 FT/IN

AVE. ANGLE METHOD

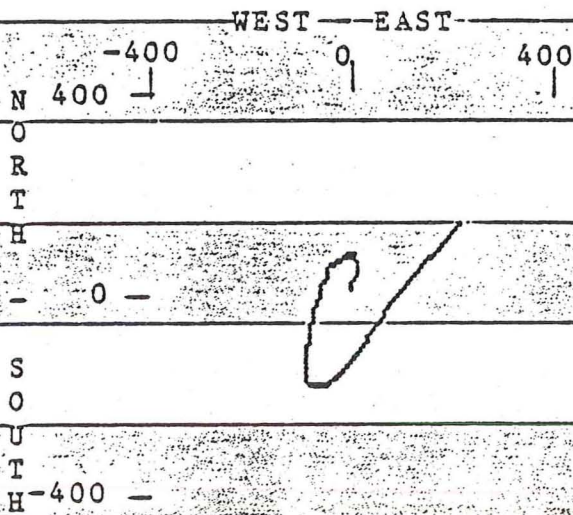

CSTDOE

SEP 09, 1981

BACA-12

ELEV= 8450 FT, SCALE 1000 FT/IN

AVE. ANGLE METHOD

WEST --- EAST

	-1000	0	1000
N	1000 ↓	↓	↓
O			
R			
T			
H			
-	0 -	✓	
S			
O			
U			
T			
H	-1000 -		

STDOE

SEP 09, 1981

BAGA-12

ELEV= 8450 FT, SCALE 2000 FT/IN

AVE. ANGLE METHOD

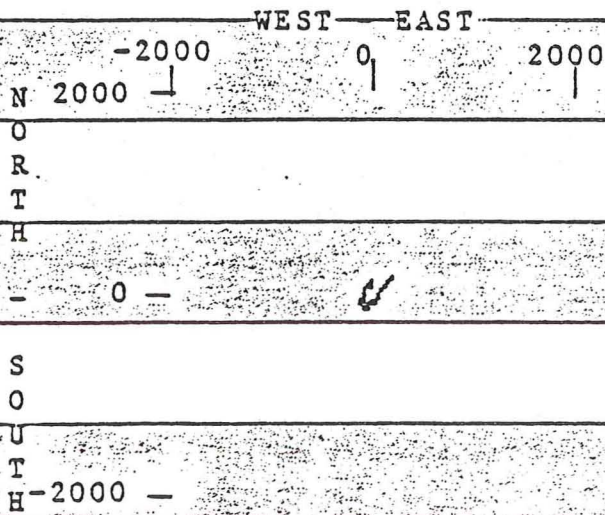

STDOE

BACA #17
STANDARD SURVEY TABLE

STA	MEAS. DEPTH	VERT. DEPTH	DRIFT		CUMULATIVE COORDINATES	
			***** ANGLE	BEARING	N S(-)	E W(-)
1				S68W		
2	250	250	0.25	S68W	-0.20	-0.51
3	394	394	0.50	S68W	-0.56	-1.38
4	550	550	0.75	S68W	-1.19	-2.96
5	706	706	0.50	S68W	-1.83	-4.54
6	1018	1018	0.75	S68W	-3.11	-7.69
7	1145	1145	1.00	S68W	-3.83	-9.49
8	1352	1352	2.00	S68W	-5.86	-14.51
9	1550	1550	1.75	S68W	-8.29	-20.52
10	1678	1678	1.50	S68W	-9.65	-23.88
11	1833	1833	1.75	S68W	-11.30	-27.96
12	1990	1990	1.75	S68W	-13.09	-32.41
13	2152	2151	2.00	S68W	-15.08	-37.32
14	2371	2370	2.00	S68W	-17.94	-44.41
15	2560	2559	2.00	S68W	-20.41	-50.52
16	2766	2765	5.00	S68W	-25.12	-62.18
17	2837	2836	5.25	S68W	-27.50	-68.06
18	3103	3100	6.00	S68W	-37.27	-92.24
19	3469	3464	8.00	S73W	-52.16	-134.28
20	4100	4087	10.25	S79W	-76.36	-231.38
21	4538	4516	13.00	S85W	-88.65	-318.78
22	4907	4875	13.00	N88W	-90.82	-401.76
23	5065	5029	14.00	N86W	-88.89	-438.59
24	5344	5301	12.00	N81W	-81.78	-500.95
25	5530	5483	12.00	S89W	-79.09	-539.53
26	5687	5636	12.00	N77W	-75.67	-571.99

OCT 25, 1978

WEIGHTING FACTOR: 0.50

X

BA #17 - SIDETRACK
STANDARD SURVEY TABLE

(FILE)

9361'
600
A7

STA	MEAS. DEPTH	VERT. DEPTH	DRIFT		CUMULATIVE COORDINATES	
			***** ANGLE	***** BEARING	N S(-)	E W(-)
1				S68W		
2	250	250	0.25	S68W	-0.20	-0.51
3	394	394	0.50	S68W	-0.56	-1.38
4	550	550	0.75	S68W	-1.19	-2.96
5	706 860	706	0.50 0.15	S68W	-1.83	-4.54
6	1018	1018	0.75	S68W	-3.11	-7.69
7	1145	1145	1.00	S68W	-3.83	-9.49
8	1352	1352	2.00	S68W	-5.86	-14.51
9	1550	1550	1.75	S68W	-8.29	-20.52
10	1678	1678	1.50	S68W	-9.65	-23.88
11	1833	1833	1.75	S68W	-11.30	-27.96
12	1990	1990	1.75	S68W	-13.09	-32.41
13	2152	2151	2.00	S68W	-15.08	-37.32
14	2371	2370	2.00	S68W	-17.94	-44.41
15	2560	2559	2.00	S68W	-20.41	-50.52
16	2766	2765	5.00	S68W	-25.12	-62.18
17	2837	2836	5.25	S68W	-27.50	-68.06
18	3165	3162	6.00	S32W	-48.16	-92.69
19	3295	3291	6.50	S30W	-60.30	-99.98
20	3365	3361	7.00	S17W	-67.84	-103.26
21	3421	3416	7.25	S11E	-74.78	-103.62
22	3452	3447	7.25	S14E	-78.60	-102.78
23	3514	3509	7.25	S14E	-86.19	-100.89
24	3577	3571	7.25	S16E	-93.87	-98.83
25	3635	3629	7.50	S16E	-101.02	-96.78
26	3697	3690	7.00	S18E	-108.51	-94.49
27	3790	3782	7.75	S16E	-119.92	-91.00
28	3854	3846	7.75	S17E	-128.20	-88.55
29	3914	3905	9.50	S28E	-136.51	-85.10
30	3945	3936	10.00	S32E	-141.06	-82.48
31	4059	4047	13.50	S28E	-161.16	-70.87
32	4121	4107	14.00	S27E	-174.23	-64.07
33	4185	4169	14.25	S27E	-188.15	-56.98
34	4228	4211	14.75	S24E	-197.87	-52.34
35	4285	4266	15.75	S16E	-211.96	-47.21
36	4348	4327	15.50	S18E	-228.18	-42.25
37	4414	4390	15.25	S16E	-244.92	-37.14
38	4476	4450	14.75	S12E	-260.49	-33.25
39	4508	4481	14.50	S12E	-268.39	-31.57
40	4673	4640	16.75	S16E	-311.51	-20.82

CONFIDENTIAL
This document contains confidential information which is proprietary to Union Oil Co. of Calif. The contents of this document are not to be revealed to any person without the express written consent of Union Oil Co. of California.

3103'

R.O. ENGBRETSSEN
APR 29 1980

NOV 06, 1978

WEIGHTING FACTOR: 0.50

X

B A #17 - SIDETRACK
 STANDARD SURVEY TABLE

STA	MEAS. DEPTH	VERT. DEPTH	DRIFT		CUMULATIVE COORDINATES	
			***** ANGLE	BEARING	N S(-)	E W(-)
41	4701	4667	17.00	S18E	-319.28	-18.45
42	4768	4731	18.00	S13E	-338.70	-13.06
43	4862	4820	20.00	S10E	-368.69	-6.96
44	4926	4880	20.50	S11E	-390.47	-2.92
45	5021	4969	21.00	S10E	-423.56	3.21
46	5115	5056	20.75	S12E	-456.44	9.60
47	5210	5145	20.50	S11E	-489.23	16.27
48	5301	5231	20.25	S11E	-520.33	22.32
49	5394	5318	20.25	S12E	-551.88	28.74
50	5485	5403	20.25	S13E	-582.63	35.55
51	5579	5491	20.50	S08E	-614.81	41.52
52	5677	5583	20.50	S06E	-648.87	45.70
53	5767	5667	21.00	S11E	-680.41	50.41
54	5856	5750	21.00	S14E	-711.55	57.32
55	6225	6094	22.00	S18E	-841.55	94.59

-56 35

NOV 10, 1978

WEIGHTING FACTOR: 0.50

9361
 6094

 3267

9361

6094

6110
 9361

 1

X

BETTY A. LESSNAU

NOV 15 1979

NOV 15, 1979
BACA 17 - SIDETRACK
ELEV= 9361 FT, SCALE 200 FT/IN
AVE. ANGLE METHOD

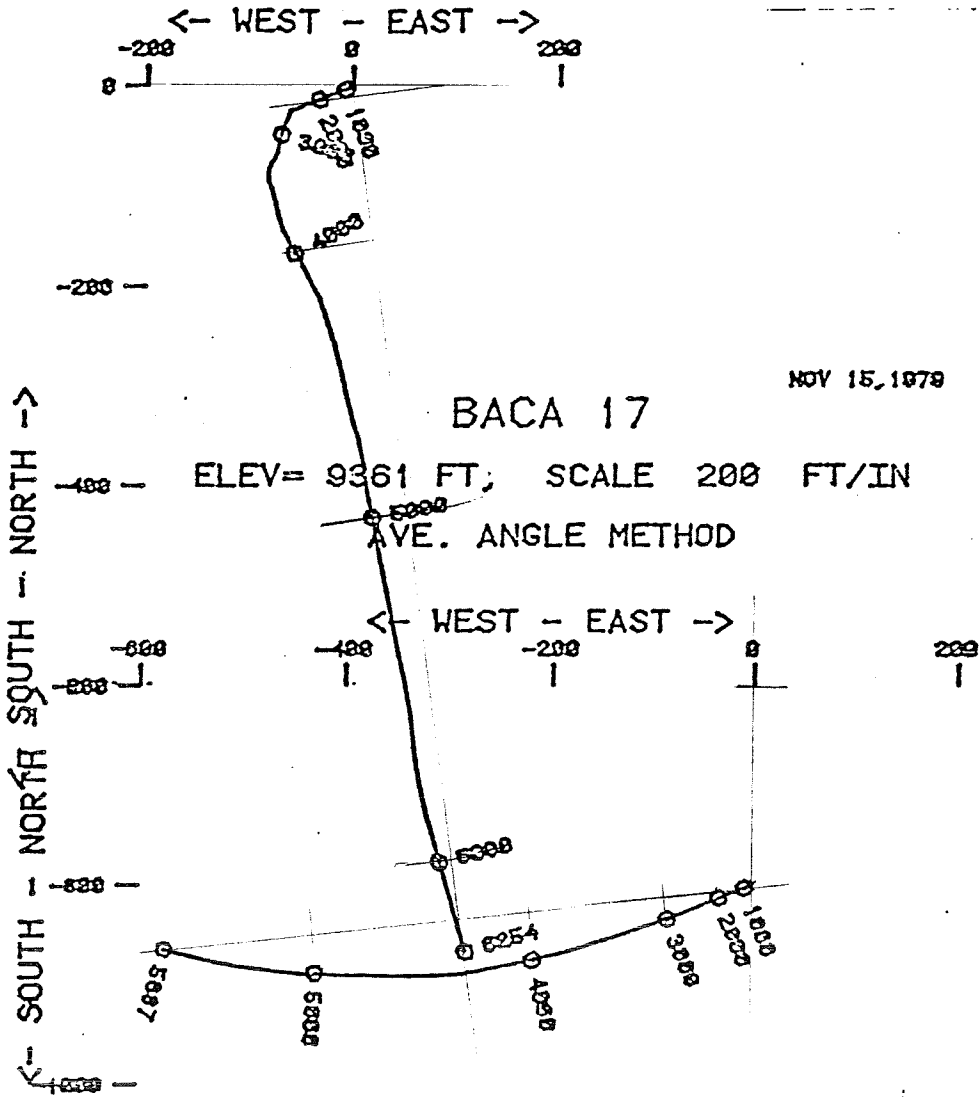

1780
590
P36
42

INTERPOLATED ON MEASURED DEPTH

X

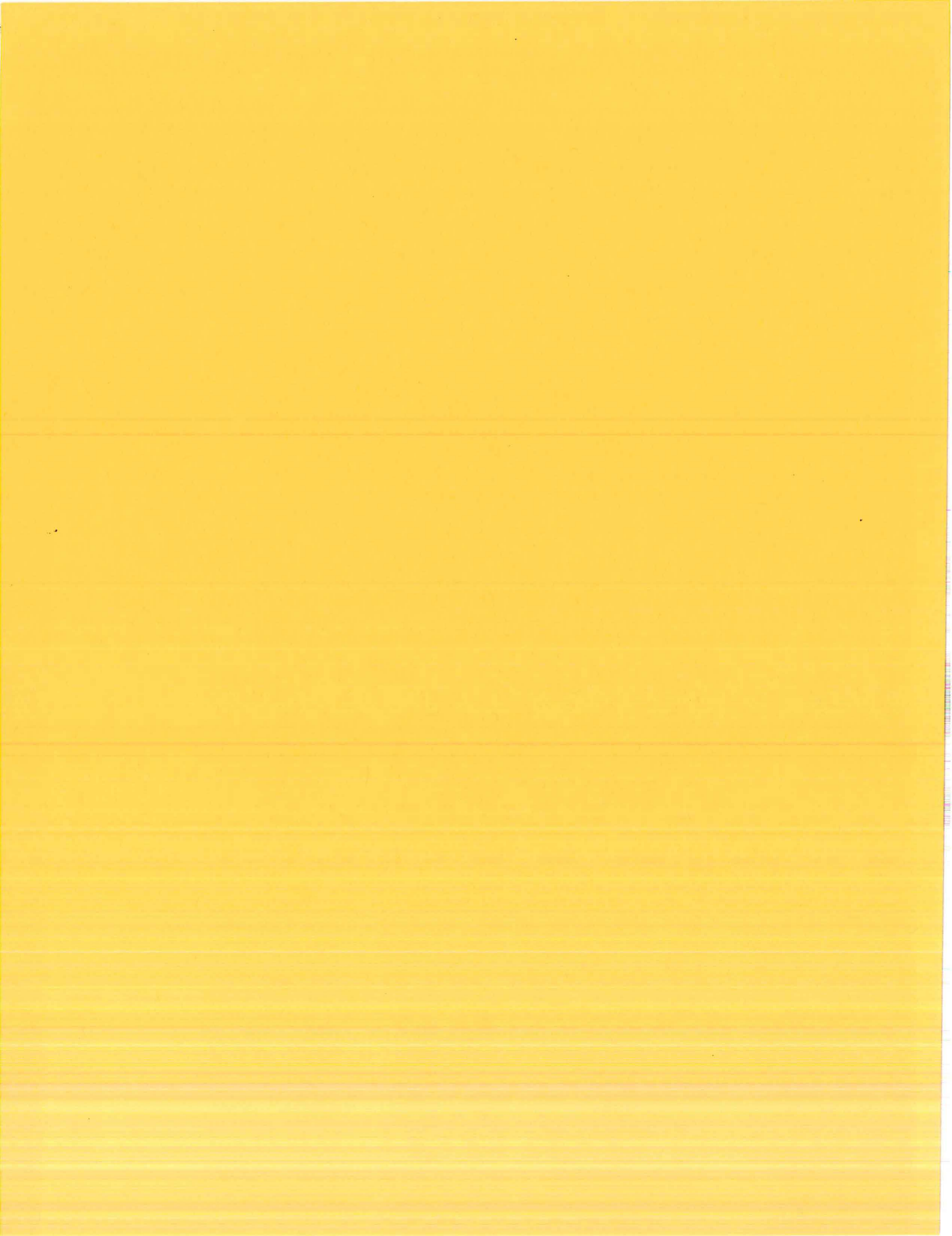

BACA 18 FILE
STANDARD SURVEY TABLE

R.O. ENGBRETSEN
APR 29 1980

STA	MEAS. DEPTH	VERT. DEPTH	DRIFT		CUMULATIVE COORDINATES	
			***** ANGLE	BEARING	N S(-)	E W(-)
1				S22E		
2	750	750	1.75	S22E	-10.62	4.29
3	1030	1030	1.75	S58E	-17.17	9.79
4	1268	1268	2.75	S13E	-24.78	15.21
5	1331	1330	4.50	S62E	-27.94	17.64
6	1370	1369	6.25	S81E	-29.10	21.10
7	1403	1402	8.00	S88E	-29.49	25.18
8	1491	1489	11.25	N88E	-29.49	39.89
9	1585	1581	11.75	N72E	-26.23	58.35
10	1690	1684	11.75	N73E	-19.80	78.74
11	1784	1776	11.75	N77E	-14.85	97.23
12	1909	1898	12.00	N56E	-4.59	120.82
13	1995	1982	11.75	N53E	5.68	135.22
14	2090	2075	11.50	N58E	16.53	151.00
15	2184	2167	11.25	N52E	27.16	166.19
16	2247	2229	11.75	N59E	34.27	176.54
17	2435	2413	11.75	N62E	53.13	209.86
18	2527	2503	11.50	N63E	61.69	226.30
19	2621	2595	11.75	N66E	69.84	243.40
20	2713	2685	12.00	N64E	77.84	260.56 ✓
21	2806	2776	12.50	N62E	86.80	278.14
22	2898	2866	12.75	N72E	94.66	296.65
23	2990	2956	13.25	N71E	101.22	316.28 ✓
24	3080	3043	13.00	N71E	107.88	335.60
25	3180	3141	13.00	N73E	114.83	356.99
26	3365	3321	13.00	N76E	125.95	397.09 ✓
27	3521	3473	13.50	N72E	135.81	431.47 ✓
28	3610	3559	14.00	N74E	141.99	451.69 ✓
29	3706	3653	14.00	N74E	148.39	474.02
30	3833	3776	14.00	N76E	156.34	503.70 ✓
31	3992	3930	13.50	N76E	165.49	540.37
32	4149	4083	12.75	N77E	173.81	575.03 ← Last Survey D.H

Kick - off

JAN 16, 1979

WEIGHTING FACTOR: 0.50

D.H T.D = 4597'

X

CA 18 - SIDETRACK
STANDARD SURVEY TABLE

STA	MEAS. DEPTH	VERT. DEPTH	DRIFT		CUMULATIVE COORDINATES		TOTAL SEC
			***** ANGLE	***** BEARING	N S(-)	E W(-)	
1				S22E			
2	750	750	1.75	S22E	-10.62	4.29	11.45
3	1030	1030	1.75	S58E	-17.17	9.79	20.00
4	1268	1268	2.75	S13E	-24.78	15.21	29.35
5	1331	1330	4.50	S62E	-27.94	17.64	33.33
6	1370	1369	6.25	S81E	-29.10	21.10	36.98
7	1403	1402	8.00	S88E	-29.49	25.18	41.08
8	1491	1489	11.25	N88E	-29.49	39.89	55.79
9	1585	1581	11.75	N72E	-26.23	58.35	74.53
10	1690	1684	11.75	N73E	-19.80	78.74	95.91
11	1784	1776	11.75	N77E	-14.85	97.23	115.06
12	1909	1898	12.00	N56E	-4.59	120.82	140.78
13	1995	1982	11.75	N53E	5.68	135.22	158.48
14	2090	2075	11.50	N58E	16.53	151.00	177.62
15	2184	2167	11.25	N52E	27.16	166.19	196.16
16	2247	2229	11.75	N59E	34.27	176.54	208.72
17	2360	2340	12.75	N62E	46.08	197.41	232.69
18	2433	2411	13.50	N57E	54.49	211.69	249.27
19	2454	2431	14.50	N47E	57.62	215.69	254.35
20	2485	2461	15.50	N36E	63.63	221.01	262.37
21	2594	2566	17.00	N14E	91.27	233.90	292.88
22	2689	2657	17.00	N15E	118.16	240.85	320.65
23	2720	2686	17.25	N14E	127.00	243.14	329.78
24	2845	2805	17.75	N13E	163.55	251.91	367.37
25	2940	2896	18.00	N14E	191.91	258.72	396.53
26	3034	2985	18.00	N14E	220.09	265.75	425.57
27	3120	3067	17.75	N14E	245.70	272.13	451.97
28	3214	3156	18.00	N16E	273.57	279.60	480.82
29	3309	3247	17.75	N16E	301.60	287.64	509.98
30	3420	3353	17.50	N15E	333.99	296.62	543.59
31	3746	3664	17.25	N12E	428.65	319.35	640.94
32	4057	3962	16.00	N07E	516.41	334.03	729.92
33	4220	4118	16.50	N07E	561.68	339.59	775.53
34	4317	4212	14.50	N16E	587.08	344.76	801.46
35	4325	4219	15.00	N16E	589.04	345.32	803.49
36	4358	4251	14.00	N16E	596.98	347.60	811.76
37	4481	4371	13.50	N27E	624.18	358.31	840.99
38	4502	4391	13.50	N30E	628.49	360.65	845.89
39	4565	4453	13.50	N32E	641.10	368.23	860.60
40	4655	4540	13.00	N26E	659.14	378.23	881.23

BETTY A. GOSN
MAR - 6 1977

377

MAR 06, 1979

WEIGHTING FACTOR: 0.50

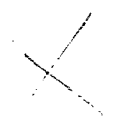

STA	MEAS. DEPTH	VERT. DEPTH	DRIFT		CUMULATIVE COORDINATES		TOTAL SFC
			***** ANGLE	BEARING	N S(-)	E W(-)	
41	4750	4633	13.25	N22E	678.85	387.00	902.80
42	4809	4690	13.75	N34E	691.01	393.47	916.57
43	4930	4807	14.75	N50E	713.14 ¹⁷⁰	413.40 ⁴⁰⁷	946.36
44	4994	4869	14.75	N54E	723.17	426.24	962.65
45	5083	4955	14.00	N54E	736.16	444.11 ^L	984.75
* 46	5250	5117	14.00	N54E	759.91	467.86	

MAR 08, 1979

WEIGHTING FACTOR: 0.50

* EXTRAPOLATED

128'
5100 = 17
32.68 K
23.75 N

BETTY A. LESSNAU
MAR - 9 1979

8725
5117
3608

8735
4982
3753

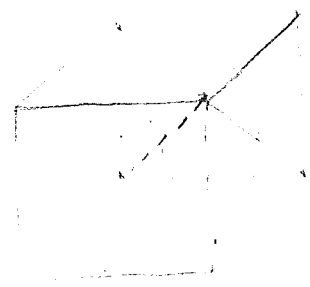

[Handwritten signature]

BETTY A. LESSNAU
NOV 15 1979

NOV 15, 1979
BACA 18 - SIDETRACK
ELEV= 8756 FT, SCALE 200 FT/IN
AVE. ANGLE METHOD

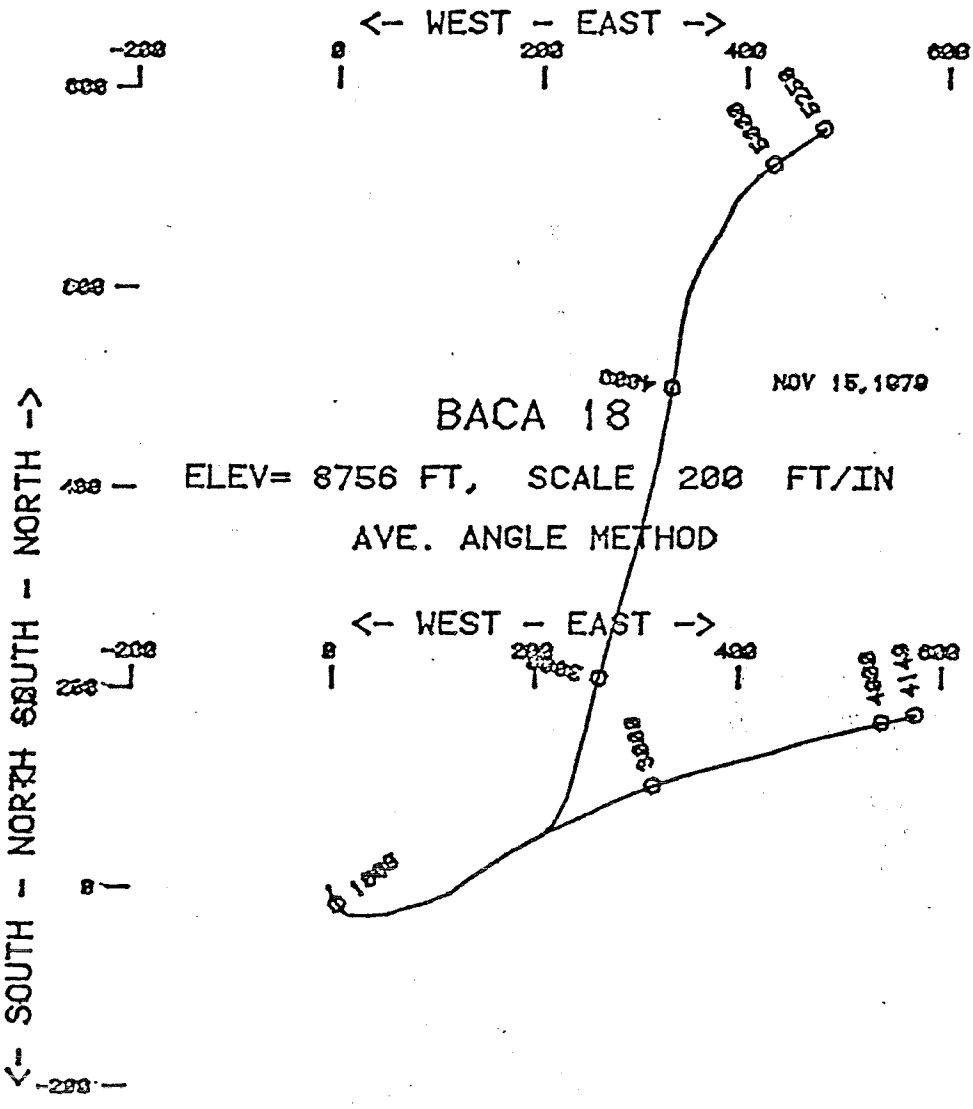

INTERPOLATED ON MEASURED DEPTH

X



BACA #19
STANDARD SURVEY TABLE

9131
1139
2157

STA	MEAS. DEPTH	VERT. DEPTH	DRIFT		CUMULATIVE COORDINATES		TOTAL SEC
			***** ANGLE	BEARING	N S(-)	E W(-)	
1				S02W			
2	1490	1490	0.75	S02W	-9.75	-0.34	9.75
3	1790	1790	2.00	S84E	-15.18	4.38	16.95
4	1885	1885	2.25	S84E	-15.55	7.89	20.47
5	1984	1984	4.50	S78E	-16.46	13.64	26.30
6	2079	2078	6.00	S80E	-18.12	22.18	34.99
7	2173	2172	8.00	S73E	-20.79	33.31	46.45
8	2297	2294	11.50	S79E	-25.87	53.69	67.45
9	2390	2385	13.00	S75E	-30.31	72.92	87.18
10	2480	2472	14.00	S76E	-35.57	93.26	108.19
11	2603	2591	14.00	S78E	-42.27	122.25	137.95
12	2697	2683	14.00	S75E	-47.57	144.36	160.69
13	2823	2805	15.00	S76E	-55.47	174.91	192.24
14	2980	2957	14.50	S75E	-65.48	213.61	232.21
15	3073	3047	14.75	S75E	-71.56	236.29	255.69
16	3166	3136	14.75	S70E	-78.68	258.87	279.37
17	3261	3228	14.75	S60E	-88.90	280.79	303.56
18	3383	3346	15.25	S64E	-103.72	308.67	335.13
19	3509	3467	16.00	S62E	-119.13	338.91	369.07
20	3558	3515	15.75	S62E	-125.42	350.74	382.47
21	3590	3545	15.75	S65E	-129.30	358.52	391.16
22	3615	3570	15.00	S70E	-131.84	364.64	397.79
23	3715	3666	16.00	S75E	-139.87	390.13	424.51
24	3740	3690	16.00	S78E	-141.48	396.83	431.40
25	3781	3730	13.75	N87E	-142.31	407.32	441.93
26	3906	3851	14.25	N86E	-140.46	437.50	472.17
27	3990	3932	15.00	N88E	-139.35	458.68	493.38
28	4115	4053	16.00	N89E	-138.48	492.08	526.78
29	4249	4181	17.00	N87E	-137.15	530.11	564.84
30	4363	4290	17.00	N89E	-135.99	563.42	598.17
31	4480	4402	17.00	S88E	-136.28	597.63	632.38
32	4644	4558	18.75	S87E	-138.48	647.92	682.71 ✓
33	4994	4888	20.00	N87E	-138.48	764.03	798.83 ✓
34	5181	5064	20.50	N89E	-136.22	828.71	863.55 ✓
35	5304	5178	21.50	N86E	-134.30	872.75	907.63 ✓

OCT 29, 1979

WEIGHTING FACTOR: 0.50

CONFIDENTIAL
This document contains confidential information which is exempt from release under the provisions of the Freedom of Information Act. The information contained herein is not to be disseminated or otherwise made available to the public without the express written consent of Union Oil Co. of California.

BETTY A. LESSNAU
OCT 29 1979

X

BACA #19
STANDARD SURVEY TABLE

STA	MEAS. DEPTH	VERT. DEPTH	DRIFT		CUMULATIVE COORDINATES		TOTAL SEC
			***** ANGLE	BEARING	N S(-)	E W(-)	
36	5430	5296	21.00	N86E	-131.11	918.31	953.30
37	5514	5374	21.00	N83E	-128.23	948.27	983.40 ✓
38	5610	5464	21.00	N83E	-124.03	982.42	1017.30 ✓

NOV 05, 1979 WEIGHTING FACTOR: 0.50

T.D.

132

134
5296
5430

918.31
948.27
982.42

2675

5400 = 52
5296

918.31
948.27
982.42

2675

BETTY A. LESSNAU
NOV - 5 1979

X

station
2065
610

BACA #20

2065

STANDARD SURVEY TABLE

CONFIDENTIAL

STA	MEAS. DEPTH	VERT. DEPTH	DRIFT		CUMULATIVE COORDINATES		TOTAL
			ANGLE	BEARING	N S (-)	E W (-)	
1				N14E			
2	108	108	0.25	N14E	0.23	0.06	
3	290	290	0.50	S76W	1.07	-0.79	-1.04
4	392	392	0.50	S68W	0.30	-1.63	-1.72
5	479	479	0.25	S15W	0.37	-2.01	-2.04
6	572	572	0.75	S49E	-0.41	-1.77	-1.61
7	663	663	1.25	S57E	-1.36	-0.50	-0.13
8	756	756	1.00	S69E	-2.19	1.12	1.65
9	849	849	0.50	S51E	-2.80	2.18	2.83
10	942	942	0.75	S40E	-3.51	2.90	3.71
11	1032	1032	0.75	S33E	-4.46	3.60	4.63
12	1158	1158	0.75	S14W	-6.08	3.87	5.32
13	1250	1250	0.75	S15W	-7.25	3.57	5.33
14	1379	1379	1.25	S48W	-9.17	2.40	4.69
15	1488	1488	1.75	S67W	-10.70	-0.01	2.76
16	1614	1614	2.25	S71W	-12.28	-4.12	-0.80
17	1650	1650	1.75	N84W	-12.42	-5.36	-1.97
18	1675	1675	1.00	S79W	-12.45	-5.96	-2.54
19	1741	1741	1.00	N38E	-11.47	-6.56	-3.37
20	1773	1773	1.75	N58E	-10.95	-5.99	-2.96
21	1804	1804	2.75	N64E	-10.36	-4.93	-2.08
22	1836	1836	4.00	S87E	-9.99	-3.08	-0.39
23	1896	1895	5.75	N83E	-9.81	2.01	4.48
24	1958	1957	6.75	N79E	-8.75	8.68	10.65
25	1985	1984	6.50	N74E	-8.03	11.71	13.39
26	2016	2015	7.00	N85E	-7.36	15.29	16.67
27	2048	2046	8.50	S36E	-7.32	19.61	20.83
28	2086	2084	8.50	S81E	-7.96	25.19	26.39
29	2166	2163	10.75	S72E	-11.08	38.19	39.76
30	2229	2224	12.00	S71E	-14.96	49.79	51.96
31	2323	2316	13.00	S72E	-21.49	69.29	72.49
32	2411	2402	14.75	S66E	-29.05	88.99	93.48
33	2511	2498	16.00	S68E	-39.41	113.39	119.73
34	2567	2552	16.50	S63E	-45.91	127.65	135.19
35	3013	2977	19.00	S67E	-103.37	250.88	269.09
36	3104	3063	19.00	S63E	-115.39	277.74	298.27
37	3200	3153	19.50	S67E	-129.27	306.42	329.44
38	2692	2672	17.50	S64E	-62.42	159.74	170.46
39	2784	2759	18.25	S61E	-75.46	184.79	198.02
40	2878	2848	19.00	S61E	-90.02	211.05	227.15

This document is confidential. It is to be used only for the purpose for which it was prepared. The contents of this document are not to be revealed to any person without the written consent of the Bureau of Oceanographic Survey.

BACA #20
STANDARD SURVEY TABLE

STA	MEAS. DEPTH	VERT. DEPTH	DRIFT		CUMULATIVE COORDINATES		TOTAL SEC
			***** ANGLE	BEARING	N S(-)	E W(-)	
36	3104	3063	19.00	S63E	-115.89	277.74	298.27
37	3200	3153	19.50	S67E	-129.27	306.42	329.44
38	2692	2672	17.50	S64E	-62.42	159.74	170.46
39	2784	2759	18.25	S61E	-75.46	184.79	198.02
40	2878	2848	19.00	S61E	-90.02	211.05	227.15
41	3013	2976	19.00	S67E	-109.28	250.55	270.30
42	3104	3062	19.00	S63E	-121.80	277.40	299.47
43	3200	3153	19.50	S67E	-135.18	306.09	330.64
44	3324	3270	18.50	S67E	-150.95	343.25	370.62
45	3417	3358	18.00	S65E	-162.80	369.85	399.39
46	3510	3447	18.00	S63E	-175.40	395.68	427.60
47	3633	3564	17.00	S62E	-192.48	428.49	463.71
48	3726	3653	16.00	S57E	-205.88	451.25	489.16
49	3820	3744	15.50	S56E	-219.97	472.53	513.36
50	3913	3833	15.00	S53E	-234.17	492.44	536.27
51	4007	3924	14.75	S51E	-249.03	511.46	558.48
52	4103	4017	14.00	S49E	-264.35	529.71	580.08
53	4196	4107	14.00	S49E	-279.11	546.69	600.30
54	4289	4198	14.00	S49E	-293.87	563.67	620.52
55	4383	4289	14.00	S47E	-309.08	580.57	640.79
56	4505	4407	13.25	S44E	-329.23	601.07	665.80
57	4584	4484	13.25	S44E	-342.25	613.65	681.32
58	4664	4562	13.50	S49E	-354.99	627.07	697.58
59	4758	4653	14.00	S36E	-371.46	642.17	716.43
60	4852	4744	15.00	S38E	-390.26	656.33	734.97
61	4945	4834	15.25	S44E	-408.57	672.25	755.09
62	5410	5279	19.00	S36E	-513.46	760.26	867.25
63	5623	5479	20.00	S37E	-570.62	802.56	922.89
64	5808	5652	22.00	S37E	-623.56	842.45	975.14
65	5963	5795	23.00	S39E	-670.31	878.97	1022.51
66	6151	5968	24.00	S44E	-726.45	928.65	1085.02
67	6340	6139	26.00	S48E	-781.94	986.10	1154.88
68	6525	6304	27.50	S49E	-837.11	1048.47	1229.40
69	6710	6467	29.00	S51E	-893.40	1115.55	1308.76
70	6864	6602	29.50	S51E	-940.75	1174.02	1377.50

AUG 01, 1980

WEIGHTING FACTOR: 0.50

LA #20 - SIDETRACK #1
STANDARD SURVEY TABLE

STA	LEAS. DEPTH	VERT. DEPTH	DRIFT		CUMULATIVE COORDINATES		TOTAL SEC
			***** ANGLE	BEARING	N S (-)	E W (-)	
1				N14E			
2	108	108	0.25	N14E	0.23	0.06	
3	290	290	0.50	S76W	1.07	-0.79	-1.04
4	392	392	0.50	S68W	0.80	-1.63	-1.73
5	479	479	0.25	S15W	0.37	-2.01	-2.04
6	572	572	0.75	S49E	-0.41	-1.77	-1.61
7	663	663	1.25	S57E	-1.36	-0.50	-0.13
8	756	756	1.00	S69E	-2.19	1.12	1.65
9	849	849	0.50	S51E	-2.80	2.19	2.83
10	942	942	0.75	S40E	-3.51	2.90	3.71
11	1032	1032	0.75	S33E	-4.46	3.60	4.63
12	1153	1153	0.75	S14W	-6.09	3.87	5.32
13	1250	1250	0.75	S15W	-7.25	3.57	5.33
14	1379	1379	1.25	S48W	-9.17	2.40	4.69
15	1486	1488	1.75	S67W	-10.70	-0.01	2.76
16	1614	1614	2.25	S71W	-12.23	-4.12	-0.80
17	1650	1650	1.75	N84W	-12.42	-5.36	-1.97
18	1675	1675	1.00	S79W	-12.45	-5.96	-2.54
19	1741	1741	1.00	N38E	-11.47	-6.56	-3.37
20	1773	1773	1.75	N58E	-10.95	-5.99	-2.96
21	1804	1804	2.75	N64E	-10.36	-4.93	-2.03
22	1836	1836	4.00	S87E	-9.99	-3.08	-0.39
23	1896	1895	5.75	N83E	-9.81	2.01	4.43
24	1958	1957	6.75	N79E	-8.75	3.63	10.65
25	1955	1984	6.50	N74E	-8.03	11.71	13.39
26	2016	2015	7.00	N85E	-7.36	15.29	16.67
27	2048	2046	8.50	S86E	-7.32	19.61	20.83
28	2086	2084	8.50	S81E	-7.96	25.19	26.39
29	2166	2163	10.75	S72E	-11.03	36.19	39.76
30	2223	2224	12.00	S71E	-14.96	49.79	51.96
31	2323	2316	13.00	S72E	-21.49	59.29	72.49
32	2411	2402	14.75	S66E	-29.05	83.99	93.43
33	2511	2498	16.00	S63E	-39.41	113.39	119.73
34	2567	2552	16.50	S63E	-45.71	127.65	135.19
35	2666	2647	16.75	S71E	-56.97	153.73	163.23

AUG 06, 1960

WEIGHTING FACTOR: 0.50

BACA #20 - SIDETRACK #1
STANDARD SURVEY TABLE

STA	MEAS. DEPTH	VERT. DEPTH	DRIFT		CUMULATIVE COORDINATES		TOTAL SEC
			***** ANGLE	BEARING	N S (-)	E W (-)	
36	2697	2677	15.75	S76E	-59.44	162.04	171.9
37	2728	2706	15.75	S81E	-61.12	170.29	180.3
38	2820	2795	14.75	N86E	-62.17	194.47	203.9
39	2885	2858	14.75	N72E	-59.01	210.71	218.8
40	2971	2941	15.00	N67E	-51.28	231.39	236.7
41	3063	3030	14.50	N61E	-41.01	252.44	254.4
42	3155	3119	15.75	N61E	-29.38	273.44	271.7
43	3246	3207	15.75	N60E	-17.21	294.94	289.3
44	3338	3295	16.00	N58E	-4.25	316.51	306.8
45	3429	3382	16.50	N57E	9.43	337.98	324.0
46	3521	3470	17.25	N57E	23.98	360.38	341.9
47	3621	3566	18.00	N57E	40.47	385.78	362.1
48	3778	3715	18.50	N53E	68.67	426.05	393.7
49	4028	3950	21.00	N50E	121.26	492.16	444.0
50	4367	4266	22.00	N42E	207.56	581.54	508.0
51	4946	4802	22.25	N39E	373.38	723.16	601.8
52	5500	5310	24.75	N32E	553.23	851.44	679.2
53	5942	5701	31.00	N26E	733.97	951.63	729.2
54	6157	5882	33.50	N26E	837.09	1001.92	751.1
55	6374 T.D.	6063	33.50	N26E	944.74	1054.43	773.9
		<i>6062</i>			<i>948.77</i>	<i>1052.71</i>	<i>777.0</i>

SEP 02, 1980 WEIGHTING FACTOR: 0.50

5812' E.T.D. 30.00 N06E

5312 - 5310 30 N06E 678.70 900.79 71

BACA #21
STANDARD SURVEY TABLE

STA	MEAS. DEPTH	VERT. DEPTH	DRIFT		CUMULATIVE COORDINATES	
			***** ANGLE	***** BEARING	N S(-)	E W(-)
1				N21W		
2	393	393	0.50	N61W	1.29	-1.12
3	486	486	0.50	N85W	1.53	-1.90
4	736	736	0.50	S77W	1.38	-4.08
5	829	829	0.50	S74W	1.18	-4.86
6	985	985	0.50	S67W	0.72	-6.15
7	1231	1231	0.75	S83W	0.03	-8.74
8	1419	1419	0.75	S89W	-0.14	-11.19
9	1608	1608	2.00	S75E	-4.65	-11.75
10	1763	1763	2.15	S72E	-6.24	-6.36
11	1918	1918	3.00	S79E	-7.98	0.38
12	1976	1976	3.25	S75E	-8.69	3.46
13	2133	2132	6.75	S61E	-13.82	16.14
14	2166	2165	7.00	S53E	-15.97	19.46
15	2256	2254	8.25	S39E	-24.27	28.05
16	2318	2315	8.75	S40E	-31.34	33.88
17	2380	2376	9.25	S42E	-38.66	40.24
18	2438	2434	10.25	S32E	-46.50	46.15
19	2468	2463	11.25	S27E	-51.37	48.91
20	2499	2493	13.00	S22E	-57.30	51.61
21	2605	2597	13.75	S09E	-80.93	58.16
22	2745	2733	13.25	S09E	-113.21	63.27
23	3000	2982	12.00	S11E	-168.10	72.95

OCT 08, 1980 WEIGHTING FACTOR: 0.50

Moore Business Forms, Inc.



BACA #22 - SIDETRACK #1
STANDARD SURVEY TABLE

STA	MEAS. DEPTH	VERT. DEPTH	DRIFT		CUMULATIVE COORDINATES	
			***** ANGLE	BEARING	N S(-)	E W(-)
1				S71W		
2	181	181	0.50	S71W	-0.26	-0.75
3	487	487	1.50	N61E	4.62	-2.92
4	636	636	1.25	N72E	6.05	0.36
5	916	916	2.75	N88E	7.74	9.98
6	1073	1073	3.50	N62E	9.96	18.25
7	1259	1258	4.00	S73E	11.13	30.36
8	1677	1675	4.50	S62E	-0.73	58.98
9	1863	1860	4.50	S55E	-8.35	71.42
10	2263	2259	5.25	S45E	-30.20	97.46
11	2528	2523	3.75	S36E	-46.01	110.96
12	2705	2700	3.00	S41E	-54.17	117.45
13	2728	2723	3.50	S40E	-55.16	118.30
14	2758	2753	2.75	S53E	-56.29	119.48
15	2840	2835	1.50	N77E	-56.92	122.46
16	2904	2899	1.50	N77E	-56.54	124.09
17	2945	2940	1.50	N77E	-56.30	125.14
18	2980	2975	1.75	N51E	-55.87	126.03
19	3011	3006	2.00	N04E	-54.97	126.50
20	3062	3057	4.75	N11E	-51.99	126.89
21	3182	3176	6.00	N14E	-41.01	129.32
22	3312	3305	7.50	N21E	-26.44	133.92
23	3433	3425	7.50	N21E	-11.70	139.58
24	3556	3547	7.50	N00W	4.09	142.50
25	3650	3640	7.00	N01W	15.95	142.40
26	3772	3761	7.50	N04E	31.34	142.80
27	3867	3855	7.25	N07W	43.53	142.48
28	3968	3956	6.50	N33W	54.89	138.35
29	4029	4016	4.50	N53W	59.17	134.36
30	4115	4102	2.75	N66W	61.93	129.68
31	4208	4195	3.50	N66W	63.99	125.04
32	4332	4319	5.00	N66W	67.73	116.65
33	4454	4440	5.00	N51W	73.28	107.58
34	4609	4595	5.00	N44W	82.41	97.62
35	4766	4751	5.50	N52W	92.02	86.95

DEC 15, 1980 WEIGHTING FACTOR: 0.50

BACA #22 - SIDETRACK #1
STANDARD SURVEY TABLE

STA	MEAS. DEPTH	VERT. DEPTH	DRIIFT		CUMULATIVE COORDINATES	
			***** ANGLE	BEARING	N S(-)	E W(-)
36	4922	4906	7.25	N43W	103.73	74.18
37	5046	5029	8.00	N41W	115.95	63.17
38	5232	5213	9.50	N37W	137.94	45.36
39	5511	5488	8.75	N31W	174.62	20.62
40	5768	5742	10.00	N26W	211.42	0.64
41	6011	5981	11.75	N32W	251.51	-21.58
42	6190	6156	11.00	N26W	282.39	-38.70
43	6370	6333	11.00	N26W	313.26	-53.76
44	6485	6445	12.00	N30W	333.50	-64.52

DEC 15, 1980 WEIGHTING FACTOR: 0.50

BACA #22 - SIDETRACK 2
STANDARD SURVEY TABLE

STA	MEAS. DEPTH	VERT. DEPTH	DRIFT *****		CUMULATIVE COORDINATES	
			ANGLE	BEARING	N S(-)	E W(-)
1				S71W		
2	181	181	0.50	S71W	-0.26	-0.75
3	487	487	1.50	N61E	4.62	-2.92
4	636	636	1.25	N72E	6.05	0.36
5	916	916	2.75	N88E	7.74	9.98
6	1073	1073	3.50	N62E	9.96	18.25
7	1259	1258	4.00	S73E	11.13	30.36
8	1677	1675	4.50	S62E	-0.73	58.98
9	1863	1860	4.50	S55E	-8.35	71.42
10	2263	2259	5.25	S45E	-30.20	97.46
11	2528	2523	3.75	S36E	-46.01	110.96
12	2650	2645	2.75	S51E	-51.03	115.73
13	2702	2697	2.75	S47E	-52.67	117.61
14	2732	2727	3.00	S39E	-53.77	118.63
15	2765	2760	2.75	S55E	-54.90	119.85
16	2796	2791	2.00	S79E	-55.40	121.03
17	2827	2822	1.75	N58E	-55.21	122.03
18	2857	2852	2.00	N14E	-54.42	122.60
19	2888	2883	2.25	N24W	-53.28	122.50
20	2919	2914	2.25	N71W	-52.45	121.60
21	2947	2942	1.00	N87W	-52.30	120.83
22	2978	2973	0.50	N19W	-52.06	120.50
23	3009	3004	1.50	N41E	-51.53	120.60
24	3095	3090	3.00	N71E	-49.64	123.40
25	3188	3182	3.25	N45E	-46.95	127.70
26	3193	3187	3.25	N59E	-46.78	127.93
27	3224	3218	3.50	S88E	-46.32	129.69
28	3255	3249	4.00	S62E	-46.85	131.65
29	3310	3304	5.00	S38E	-49.62	134.96
30	3432	3426	4.25	S44E	-57.04	141.41
31	3556	3550	3.00	S35E	-63.09	146.40
32	3680	3673	2.75	S37E	-68.12	150.05
33	3786	3779	3.75	S44E	-72.69	153.96
34	3878	3871	4.00	S28E	-77.72	157.61
35	4001	3994	3.75	S09E	-85.61	160.25

DEC 29, 1980

WEIGHTING FACTOR: 0.50

BACA #22 - SIDETRACK 2
STANDARD SURVEY TABLE

STA	MEAS. DEPTH	VERT. DEPTH	DRIET		CUMULATIVE	
			***** ANGLE	BEARING	N S(-)	E W(-)
36	4128	4120	3.25	S02E	-93.32	160.99
37	4188	4180	3.25	S01E	-96.72	161.08
38	4231	4223	4.25	S07E	-99.53	161.28
39	4263	4255	5.00	S15E	-102.06	161.77
40	4324	4316	5.25	S26E	-107.17	163.68
41	4355	4347	4.75	S32E	-109.53	164.99
42	4385	4377	4.25	S42E	-111.41	166.40
43	4416	4408	4.25	S67E	-112.74	168.27
44	4482	4473	5.00	N88E	-113.71	173.51
45	4638	4629	4.00	N89E	-113.39	185.74
46	4761	4752	4.00	N67E	-111.61	194.13
47	4795	4785	5.25	N67E	-110.54	196.66
48	4844	4834	5.00	N66E	-108.79	200.67
49	4920	4910	3.00	S85E	-107.92	205.90
50	5045	5035	4.00	S77E	-109.11	213.44
51	5165	5155	3.00	N50E	-107.40	220.56
52	5317	5306	4.00	N43E	-101.01	227.29
53	5520	5509	3.00	N41E	-91.80	235.59
54	5662	5651	4.00	N30E	-84.75	240.62
55	6006	5994	5.00	N24E	-60.70	252.87

JAN 06, 1981 WEIGHTING FACTOR: 0.50

BACA 22 REDRILL 3
STANDARD SURVEY TABLE

STA	MEAS. DEPTH	VERT. DEPTH	DRIFT		CUMULATIVE COORDINATES	
			***** ANGLE	BEARING	N S(-)	E W(-)
---	-----	-----	-----	-----	-----	-----
1				S71W		
2	181	181	0.50	S71W	-0.26	-0.75
3	487	487	1.50	N61E	4.62	-2.92
4	636	636	1.25	N72E	6.05	0.36
5	916	916	2.75	N88E	7.74	9.98
6	1073	1073	3.50	N62E	9.96	18.25
7	1259	1258	4.00	S73E	11.13	30.36
8	1677	1675	4.50	S62E	-0.73	58.98
9	1863	1860	4.50	S55E	-8.35	71.42
10	2263	2259	5.25	S45E	-30.20	97.46
11	2528	2523	3.75	S36E	-46.01	110.96
12	2581	2576	3.25	S65E	-48.07	113.46
13	2616	2611	2.75	S41E	-49.17	114.92
14	2648	2643	2.50	S47E	-50.23	115.94
15	2713	2708	1.25	S27E	-51.93	117.22
16	2758	2753	1.00	S17W	-52.81	117.30
17	2857	2852	1.25	S19W	-54.66	116.70
18	2951	2946	1.75	S56W	-56.61	115.20
19	3046	3041	1.25	S87W	-57.40	112.84
20	3171	3166	2.50	N60W	-56.44	108.87
21	3326	3321	2.75	N22W	-51.09	104.21
22	3449	3443	3.00	N57W	-46.32	100.28
23	3607	3601	4.25	N60W	-41.11	91.77
24	3794	3788	3.25	S17E	-48.72	82.19
25	3887	3881	3.50	S04W	-54.16	82.81
26	4044	4037	8.50	S15E	-70.49	84.39
27	4136	4128	9.00	S09E	-84.18	87.30
28	4199	4190	8.25	S07E	-93.54	88.61
29	4320	4310	8.00	S07E	-110.51	90.70
30	4417	4406	7.25	S02E	-123.34	91.71
31	4634	4622	5.00	S09E	-146.39	93.93
32	4837	4824	4.25	S00E	-162.71	95.21
33	5040	5026	3.75	S04W	-176.86	94.72
34	5227	5213	1.00	S05E	-184.61	94.78
35	5422	5408	0.50	S20W	-187.14	94.45

DEC 23, 1981

WEIGHTING FACTOR: 0.50

ESTDOE

BACA 22 REDRILL 3
STANDARD SURVEY TABLE

STA	MEAS. DEPTH	VERT. DEPTH	DRIFT		CUMULATIVE COORDINATES	
			***** ANGLE	BEARING	N S(-)	E W(-)
36	5699	5685	0.75	N37W	-187.59	91.46
37	5908	5894	1.25	N37W	-184.67	89.27
38	6625	6611	3.50	N56W	-164.22	67.71
39	7295	7279	5.50	N56W	-134.83	24.13
40	7882	7863	5.50	N46W	-99.42	-19.59
41	8373	8352	5.50	N50W	-67.93	-54.56
42	8846	8822	5.50	N50W	-38.79	-89.29

DEC 23, 1981 WEIGHTING FACTOR: 0.50

DEC 15, 1980

BACA #22 - ORIGINAL HOLE

ELEV= 9295 FT., SCALE 200 FT/IN

AVE. ANGLE METHOD

WEST - EAST

-200

0

200

400

N
O
R
T
H

200

S
O
U
T
H

0

200

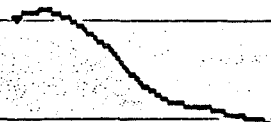

DEC 15, 1980

BACA #22 - SIDETRACK #1

ELEV= 9295 FT, SCALE 200 FT/IN

AVE. ANGLE METHOD

WEST - EAST

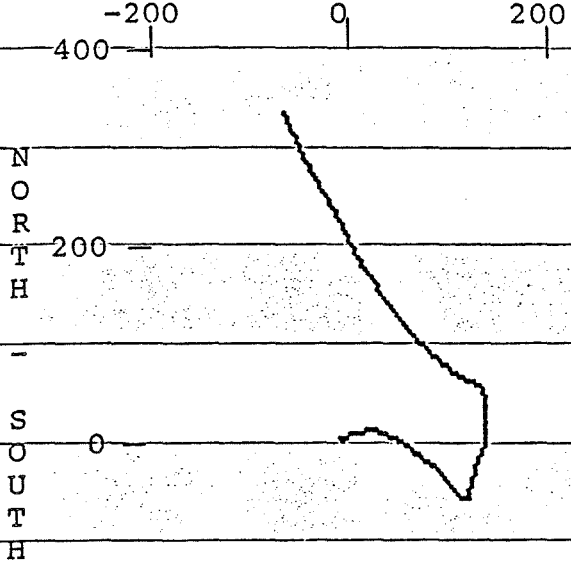

JAN 06, 1981

BACA-#22 SIDETRACK-2

ELEV= 9295 FT, SCALE 200 FT/IN

AVE. ANGLE METHOD

WEST — EAST

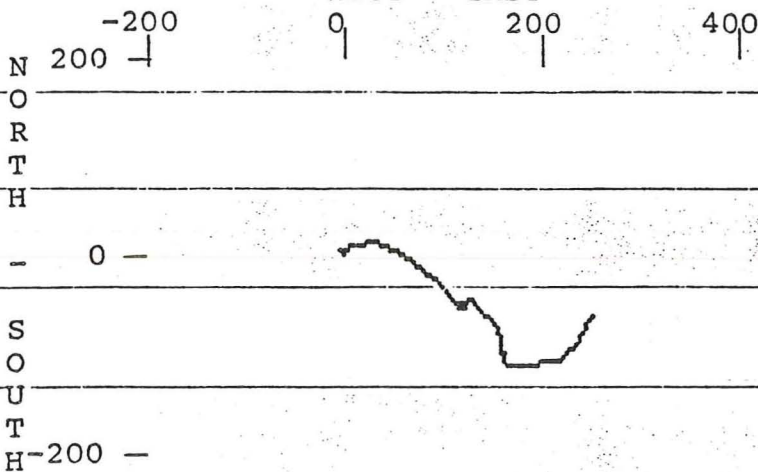

DEC 15, 1980

BACA #22 - ORIGINAL HOLE

ELEV= 9295 FT, SCALE 400 FT/IN

AVE. ANGLE METHOD

WEST - EAST

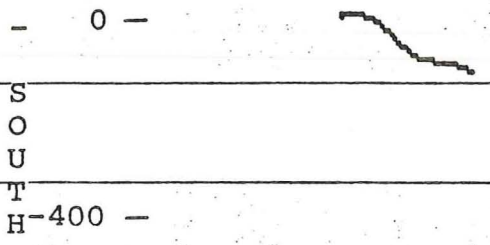
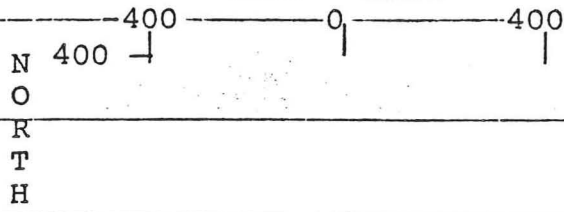

H-400 -

Moore Business Forms, Inc. 1

DEC 15, 1980

BACA #22 - SIDETRACK #1

ELEV= 9295 FT, SCALE 400 FT/IN

AVE. ANGLE METHOD

WEST - EAST

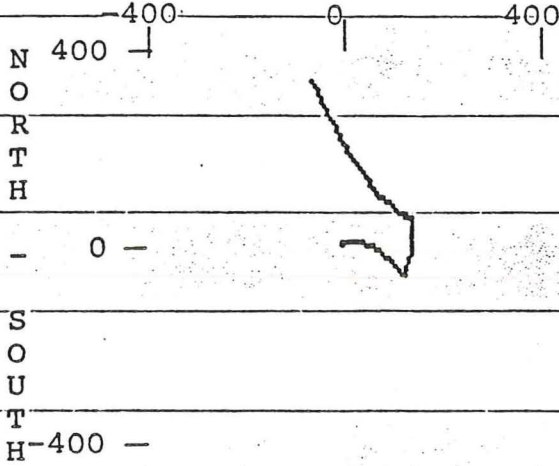

Moore Business Forms, Inc.

JAN 06, 1981

BACA #22 --- SIDETRACK-2

ELEV= 9295 FT, SCALE 400 FT/IN

AVE. ANGLE METHOD

WEST --- EAST

N 400 -400 0 400
N
O
R
T
H

- 0 -

S
O
U
T
H -400 -



DEC 15, 1980

BACA #22 - ORIGINAL HOLE

ELEV= 9295 FT, SCALE 1000 FT/IN

AVE. ANGLE METHOD

WEST - EAST

WEST - EAST
-1000 0 1000
N 1000
R
T
H

- 0 -

S
O
U
T
H -1000 -

Moore Business Forms, Inc. f

DEC 15, 1980

BACA #22 - SIDETRACK #1

ELEV= 9295 FT, SCALE 1000 FT/IN

AVE. ANGLE METHOD

WEST - EAST

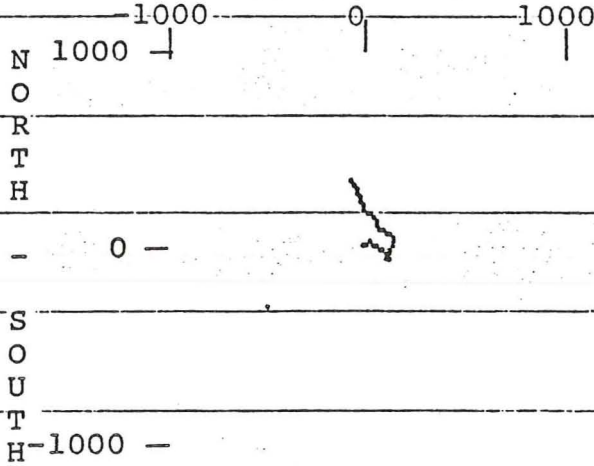

Moore Business Forms, Inc. 1

JAN 06, 1981

BACA #22 SIDETRACK 2

ELEV= 9295 FT, SCALE 1000 FT/IN

AVE. ANGLE METHOD

WEST EAST

N 1000 -1000 0 1000
O
R
T
H

- 0 -

S
O
U
T
H -1000 -

DEC 15, 1980

BACA #22 - ORIGINAL HOLE

ELEV= 9295 FT, SCALE 2000 FT/IN

AVE. ANGLE METHOD

WEST - EAST

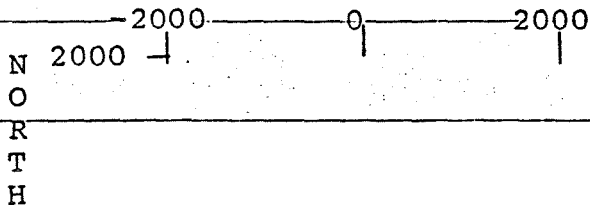

- 0 -

SOUTH

H-2000 -

Moore Business Forms, Inc.

DEC 15, 1980

BACA #22 - SIDETRACK #1

ELEV= 9295 FT, SCALE 2000 FT/IN

AVE. ANGLE METHOD

WEST - EAST

2000 0 2000
2000

N
O
R
T
H

- 0 -

S
O
U
T
H

H-2000 -

Moore Business Forms, Inc.

JAN 06, 1981

BACA #22 --- SIDETRACK 2

ELEV = 9295 FT, SCALE 2000 FT/IN

AVE. ANGLE METHOD

WEST --- EAST

N 2000 -2000 0 2000

N
O
R
T
H

- 0 -

S
O
U
T
H

H-2000 -

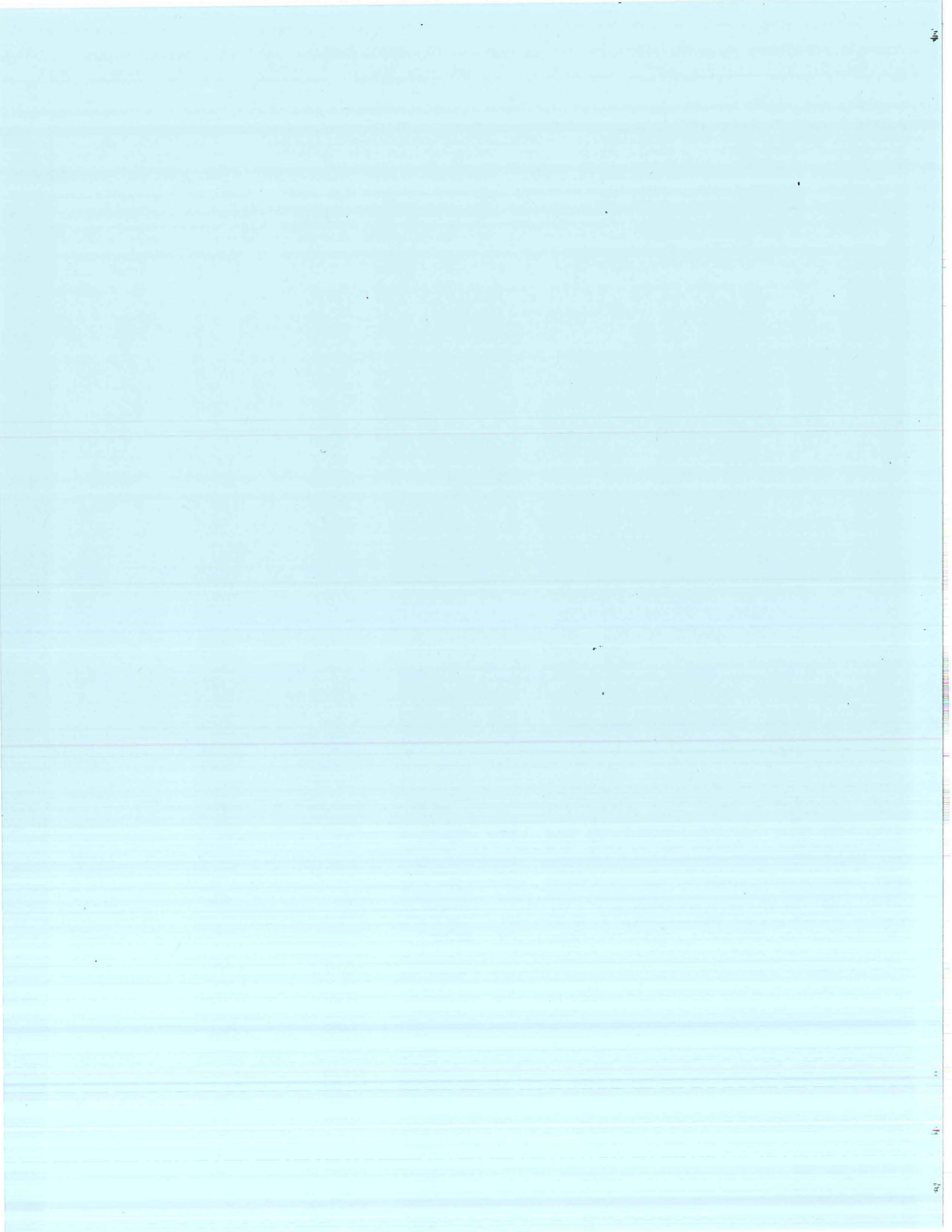

BACA-23
STANDARD SURVEY TABLE

STA	MEAS. DEPTH	VERT. DEPTH	DRIFT		CUMULATIVE COORDINATES		TOTAL SEC
			***** ANGLE	***** BEARING	N S(-)	E W(-)	
1				S14E			
2	133	133	0.25	S14E	-0.28	0.07	0.29
3	267	267	0.25	S73E	-0.71	0.47	0.87
4	358	358	0.25	S42E	-0.92	0.81	1.27
5	433	433	1.00	N66E	-1.09	1.61	2.09
6	546	546	1.50	S68E	-1.05	4.07	4.56
7	626	626	1.00	S52E	-1.92	5.58	6.30
8	736	736	1.50	S47E	-3.48	7.41	8.70
9	893	893	2.00	S72E	-5.91	11.54	13.49
10	986	986	2.75	S71E	-7.13	15.19	17.35
11	1080	1080	3.25	S62E	-9.10	19.71	22.27
12	1205	1204	3.25	S65E	-12.26	26.05	29.35
13	1329	1323	3.75	S54E	-16.10	32.57	36.92
14	1419	1418	4.25	S52E	-19.38	37.58	43.20
15	1470	1469	4.50	S48E	-22.38	40.56	47.09
16	1553	1552	4.00	S34E	-27.02	44.60	53.24
17	1684	1682	5.00	S01W	-36.38	47.52	63.52
18	1737	1735	5.00	S07E	-41.49	47.76	68.14
19	1839	1837	5.25	S19E	-50.37	49.31	77.25
20	1884	1881	4.50	S18E	-53.99	51.02	81.08
21	1945	1942	5.00	S03W	-59.00	51.63	86.13
22	2054	2051	7.00	S01E	-70.39	51.48	97.52
23	2143	2139	7.50	S09E	-81.58	52.46	108.75
24	2237	2232	8.75	S10E	-94.68	54.66	122.04
25	2330	2324	9.50	S12E	-109.16	57.47	136.79
26	2422	2414	10.00	S22E	-124.06	62.03	152.37
27	2506	2497	8.75	S06E	-137.34	65.34	168.05
28	2537	2528	8.00	S05W	-141.85	65.38	170.57
29	2569	2560	8.25	S16W	-146.30	64.55	175.09
30	2637	2627	10.00	S22W	-156.50	61.04	185.87
31	2699	2688	10.00	S24W	-166.41	56.33	196.64
32	2790	2778	9.50	S24W	-180.49	50.56	212.05
33	2882	2869	8.00	S14W	-193.72	46.01	225.05
34	3006	2991	7.50	S06W	-210.19	43.10	242.77
35	3204	3188	7.50	S08W	-235.84	39.96	268.61

FEB 16, 1981

WEIGHTING FACTOR: 0.50

431 (100) 0.50
1423 (100) 0.50

BAC-23
STANDARD SURVEY TABLE

STA	HEAS. DEPTH	VERT. DEPTH	DRIIFT		CUMULATIVE COORDINATES		TOTAL SEC
			***** ANGLE	BEARING	N S(-)	E W(-)	
36	3391	3373	7.00	S21W	-252.69	34.05	253.05
37	3572	3553	6.75	S29W	-273.32	24.39	277.34
38	3775	3755	4.00	S24W	-295.34	16.40	295.01
39	3961	3941	3.00	S21W	-305.83	12.06	305.57
40	4163	4142	3.00	S45W	-314.70	6.30	314.54
41	4320	4299	5.00	S45W	-322.44	-1.44	322.42
42	4600	4578	3.00	S48W	-335.88	-15.61	336.11
43	4940	4917	7.50	N82W	-344.93	-45.36	345.72
44	5182	5156	9.25	N84W	-340.63	-80.35	342.03
45	5680	5649	7.50	N87W	-334.99	-152.66	337.51
46	5700	5669	7.50	N87W	-334.86	-155.26	337.51
47	5746	5714	7.50	N87W	-334.54	-161.26	337.30

APR 16, 1981

WEIGHTING FACTOR: 0.50

BACA #24
STANDARD SURVEY TABLE

STA	MEAS. DEPTH	VERT. DEPTH	DRIFT *****		CUMULATIVE COORDINATES	
			ANGLE	BEARING	N S(-)	E W(-)
1				N05E		
2	207	207	0.50	N05E	0.90	0.08
3	310	310	0.50	N19E	1.78	0.27
4	450	450	0.25	N24E	2.63	0.60
5	628	628	0.25	N66W	3.36	0.32
6	790	790	0.25	S42E	2.78	-0.09
7	930	930	0.50	N64E	2.61	0.81
8	1065	1065	0.50	S27W	1.77	1.63
9	1221	1221	1.50	N01E	2.43	-1.01
10	1381	1381	2.25	S33W	3.96	-6.02
11	1447	1447	2.00	S34W	1.92	-7.37
12	1541	1541	2.00	S30W	-0.86	-9.10
13	1652	1652	2.25	S54W	-3.92	-11.86
14	1804	1804	2.50	S46W	-7.97	-16.68
15	1961	1960	2.50	S37W	-13.10	-21.22
16	2052	2051	3.25	S54W	-16.30	-24.48
17	2144	2143	3.25	S44W	-19.72	-28.41
18	2269	2268	3.25	S54W	-24.37	-33.76
19	2420	2419	3.50	S69W	-28.61	-41.57
20	2555	2553	4.00	S89W	-30.30	-50.24
21	2617	2615	4.50	N86W	-30.18	-54.83
22	2744	2742	4.75	N65W	-27.61	-64.75
23	2837	2834	5.00	N73W	-24.78	-72.13
24	2921	2918	5.25	N71W	-22.46	-79.26
25	3102	3098	5.25	N73W	-17.34	-95.01
26	3300	3296	5.00	N57W	-9.87	-111.04
27	3543	3538	5.00	N55W	1.97	-128.60
28	3975	3968	4.25	N68W	18.60	-159.21
29	4232	4225	3.25	N73W	24.21	-175.06
30	4989	4980	5.00	N79W	37.38	-227.89
31	5367	5356	5.00	S84W	38.82	-260.81
32	5502	5491	5.00	S84W	37.59	-272.51

JUN 24, 1981

WEIGHTING FACTOR: 0.50

JUN 24, 1981

BACA #24

ELEV= 8764 FT, SCALE 200 FT/IN

AVE. ANGLE METHOD

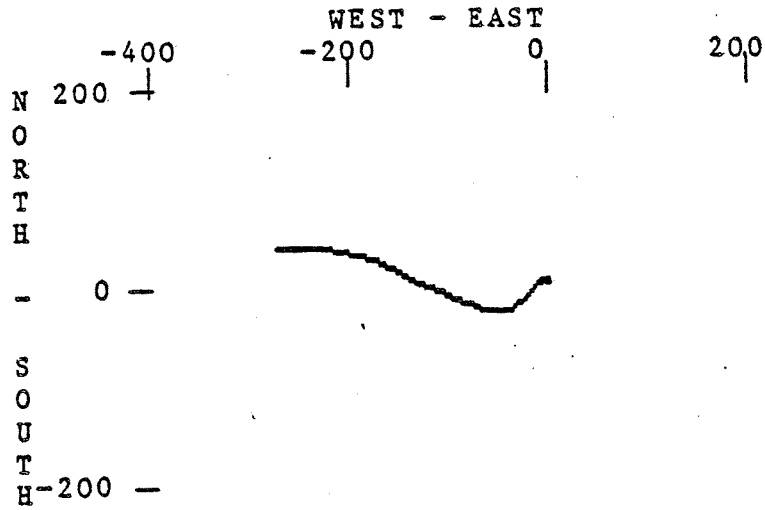

JUN 24, 1981

BACA #24

ELEV= 8764 FT, SCALE 400 FT/IN

AVE. ANGLE METHOD

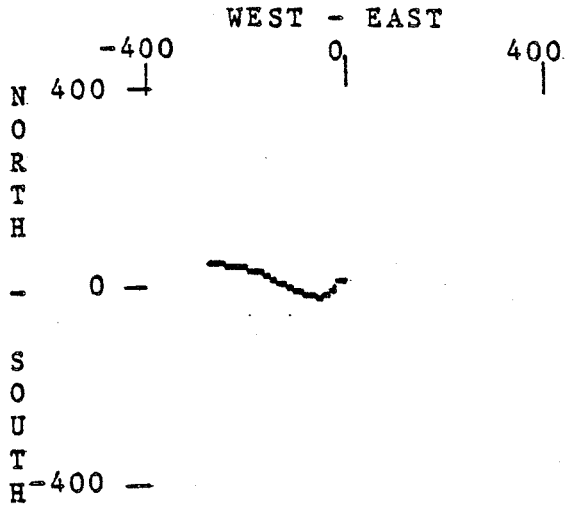

JUN 24, 1981

BACA #24

ELEV= 8764 FT, SCALE 1000 FT/IN

AVE. ANGLE METHOD

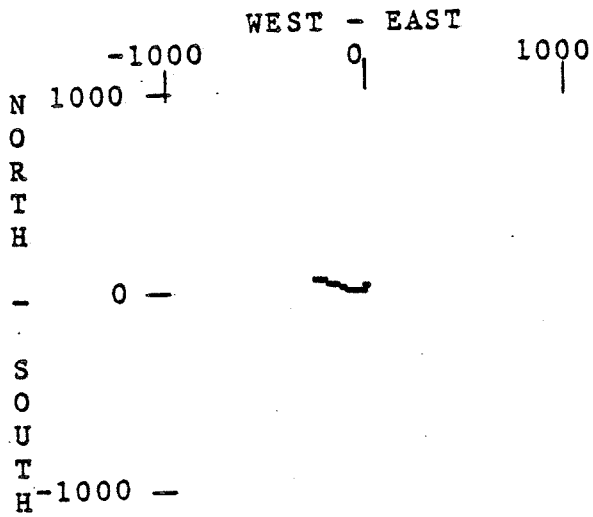

JUN 24, 1981

BACA #24

ELEV= 8764 FT, SCALE 2000 FT/IN

AVE. ANGLE METHOD

