

AGNEW AND SWEET

394 GILMORE AVENUE CHURCH AND AIRPORT ROAD
 BAKERSFIELD, CALIFORNIA 93308 BIVISTA, CALIFORNIA 94571
 PHONE (805) 327-2267 FAX PHONE (707) 374 2197

24 HO
 SERV

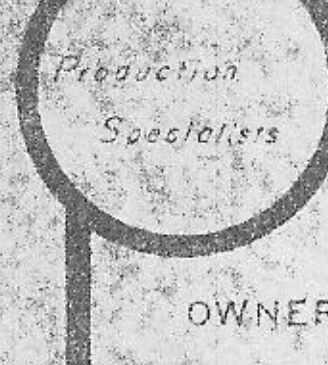

SUBSURFACE TEMPERATURE SURVEY

OWNER: THERMAL POWER FIELD: ROOSEVELT WELL NAME: 14-2

WELL DATA: WELL NO: 6106 SURVEY CONDITIONS: November 15, 1976
 DATE: 9-5/81 to 18-51 STATIC TEMPERATURE SURVEY
 20' PER MINUTE

WIRE LOG: 90 - 660' SERIAL NUMBER: 10038
 LOG NO: 515.8

TIME ON BOTTOM: 7:00 AM
 TIME OFF BOTTOM: 7:15 AM

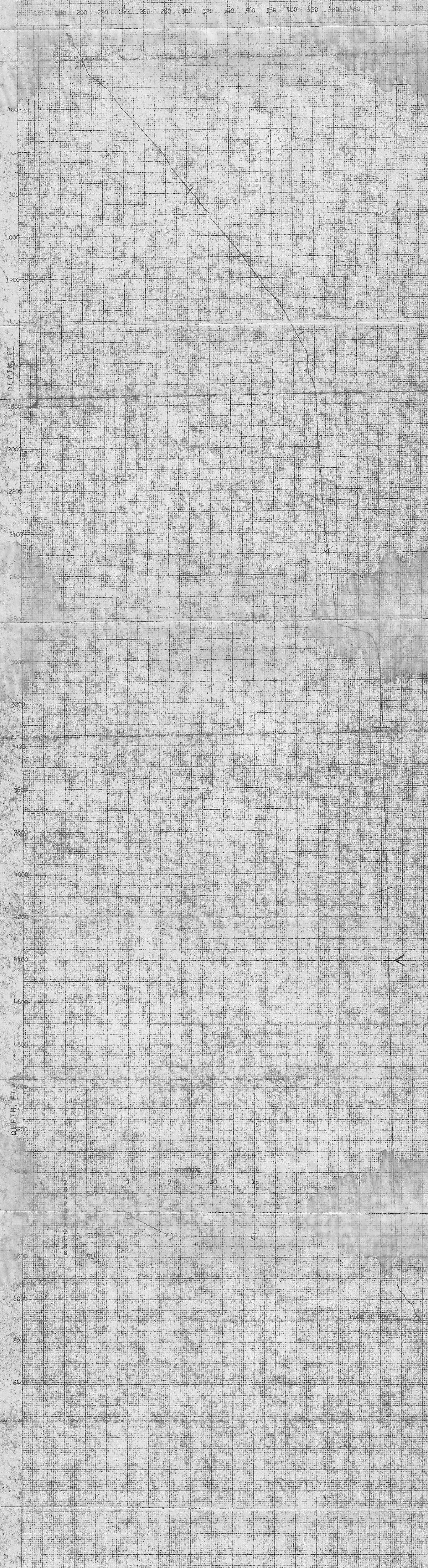

SUB-SURFACE TEMPERATURE DATA

DEPTH	TEMP °F	DEPTH	TEMP °F	DEPTH	TEMP °F	DEPTH	TEMP °F	DEPTH	TEMP °F	DEPTH	TEMP °F
0		1060	346.4	2120	425.2	3180	481.1	4240	485.9	5300	491.3
20		1080	349.4	2140	425.2	3200	481.3	4260	485.9	5320	491.3
40	186.9	1100	353.6	2160	425.5	3220	481.3	4280	485.9	5340	491.6
60	192.2	1120	356.9	2180	425.7	3240	481.6	4300	486.2	5360	491.6
80	192.8	1140	357.7	2200	426.0	3260	481.6	4320	486.2	5380	492.1
100	193.4	1160	358.0	2220	426.3	3280	481.6	4340	486.5	5400	492.1
120	197.1	1180	359.0	2240	426.6	3300	481.6	4360	486.5	5420	492.1
140	199.8	1200	367.7	2260	426.8	3320	481.6	4380	486.5	5440	492.1
160	201.8	1220	369.8	2280	427.4	3340	481.9	4400	486.5	5460	492.1
180	203.0	1240	372.8	2300	427.6	3360	482.1	4420	487.0	5480	492.4
200	204.0	1260	375.8	2320	427.9	3380	482.1	4440	487.0	5500	492.4
220	205.2	1280	379.7	2340	428.2	3400	482.1	4460	487.0	5520	492.4
240	207.7	1300	386.4	2360	429.0	3420	482.4	4480	487.3	5540	492.9
260	213.0	1320	386.4	2380	429.0	3440	482.4	4500	487.3	5560	493.2
280	218.8	1340	388.5	2400	429.3	3460	482.4	4520	487.3	5580	493.5
300	223.5	1360	391.0	2420	429.8	3480	482.4	4540	487.3	5600	493.7
320	227.8	1380	393.7	2440	430.3	3500	482.7	4560	487.8	5620	494.0
340	230.3	1400	395.6	2460	430.9	3520	482.7	4580	487.8	5640	494.3
360	233.1	1420	398.0	2480	431.7	3540	482.7	4600	488.1	5660	494.6
380	236.2	1440	400.0	2500	432.5	3560	482.9	4620	488.3	5680	494.8
400	239.0	1460	402.4	2520	432.8	3580	482.9	4640	488.3	5700	495.1
420	243.0	1480	404.1	2540	433.3	3600	482.9	4660	488.3	5720	495.4
440	246.4	1500	407.7	2560	433.8	3620	483.2	4680	488.6	5740	495.6
460	250.8	1520	409.9	2580	434.1	3640	483.5	4700	488.6	5760	495.6
480	253.1	1540	411.5	2600	434.4	3660	483.5	4720	488.6	5780	495.6
500	255.2	1560	411.3	2620	434.9	3680	483.8	4740	488.9	5800	495.6
520	261.0	1580	413.2	2640	435.2	3700	483.8	4760	488.9	5820	495.6
540	264.4	1600	411.4	2660	435.7	3720	483.8	4780	488.9	5840	495.6
560	267.5	1620	414.0	2680	436.3	3740	484.0	4800	488.9	5860	495.9
580	273.2	1640	415.4	2700	436.5	3760	484.0	4820	488.9	5880	495.9
600	275.3	1660	417.0	2720	437.4	3780	484.0	4840	488.9	5900	496.2
620	278.3	1680	418.1	2740	437.4	3800	484.0	4860	488.9	5920	496.2
640	281.0	1700	421.2	2760	437.2	3820	484.0	4880	489.2	5940	496.2
660	282.8	1720	423.8	2780	438.4	3840	484.3	4900	489.2	5960	496.4
680	285.8	1740	423.3	2800	439.0	3860	484.6	4920	489.2	5980	496.4
700	288.3	1760	420.9	2820	439.2	3880	484.6	4940	489.2	6000	496.4
720	291.8	1780	420.9	2840	440.1	3900	484.6	4960	489.2	6020	496.4
740	295.1	1800	421.1	2860	439.1	3920	484.6	4980	489.2	6040	496.4
760	298.7	1820	421.4	2880	438.8	3940	484.8	5000	489.4	6060	496.4
780	302.3	1840	421.7	2900	438.6	3960	485.1	5020	489.4	6080	496.4
800	305.9	1860	422.0	2920	437.5	3980	485.1	5040	489.4	6100	496.4
820	308.6	1880	422.2	2940	437.5	4000	485.4	5060	489.7	6120	496.4
840	311.6	1900	422.5	2960	437.1	4020	485.4	5080	489.7	6140	496.4
860	314.9	1920	422.0	2980	438.6	4040	485.4	5100	490.0	6160	496.4
880	317.3	1940	421.6	3000	439.2	4060	485.6	5120	490.2	6180	496.4
900	320.6	1960	423.0	3020	439.0	4080	485.6	5140	490.5	6200	496.4
920	323.0	1980	423.3	3040	438.5	4100	485.9	5160	490.5	6220	496.4
940	325.0	2000	423.3	3060	438.8	4120	485.9	5180	490.8	6240	496.4
960	329.9	2020	423.6	3080	438.8	4140	485.9	5200	490.8	6260	496.4
980	332.9	2040	423.9	3100	438.1	4160	485.9	5220	491.0	6280	496.4
1000	337.1	2060	424.1	3120	438.1	4180	485.9	5240	491.0	6300	496.4
1020	340.4	2080	424.4	3140	438.1	4200	485.9	5260	491.0	6320	496.4
1040	343.1	2100	424.7								

INTERVALS: 0 MIN. TEMP. 5 min. 515.8 10 515.0 15 515.0