

ADD60

113°22'30" WAKI 794 795 796 20' 797 798 R.13 W. R13W 100 11490000 FEET 102 103 113°15' 104 1050000 FT. R.12 W. R12W 10 11 R.11 W. R11W 113°00' 13560000 FEET R.10 W. 113°00'

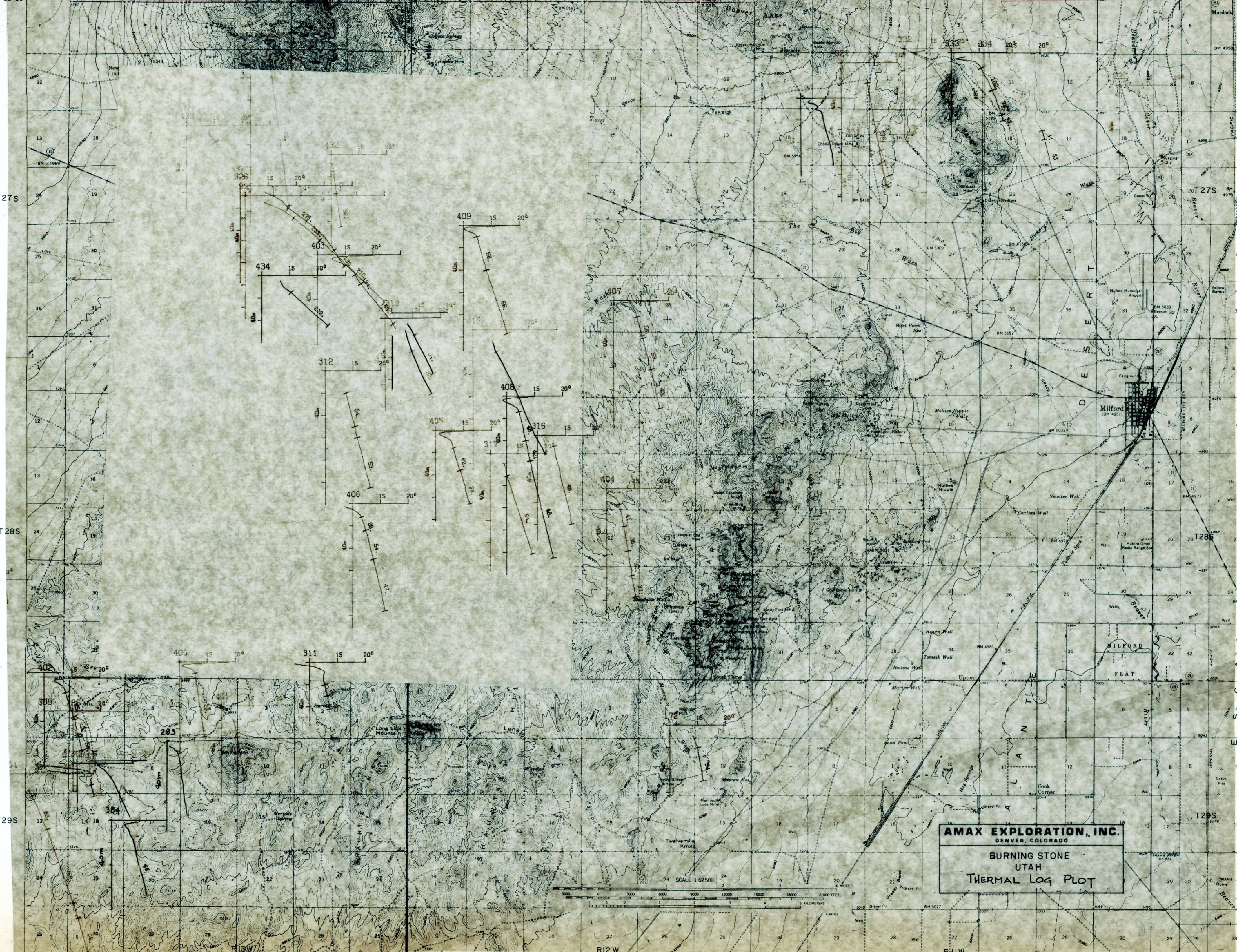

T 27S

T 28S

T 29S

AMAX EXPLORATION, INC.
 DENVER, COLORADO
 BURNING STONE
 UTAH
 THERMAL LOG PLOT

